

NORTH APPROACH SLAB PLAN

* Tilt #9 b5(E) bars as required to maintain clearance.

SLAB and FOOTING CONTROL POINTS

Point	Station	Offset
Layout Points Approach Slab		
'A'	111+79.50	12.00' Lt.
'B'	111+79.50	12.00' Rt.
'C'	111+83.41	12.00' Rt.
'D'	112+03.22	19.43' Rt.
'E'	112+09.50	12.00' Lt.
'F'	112+09.50	12.00' Rt.
Layout Points Approach Footing		
'G'	112+02.50	12.00' Lt.
'H'	112+02.50	18.84' Rt.
'I'	112+05.51	21.37' Rt.
'J'	112+12.50	12.00' Lt.
'K'	112+12.50	13.10' Rt.

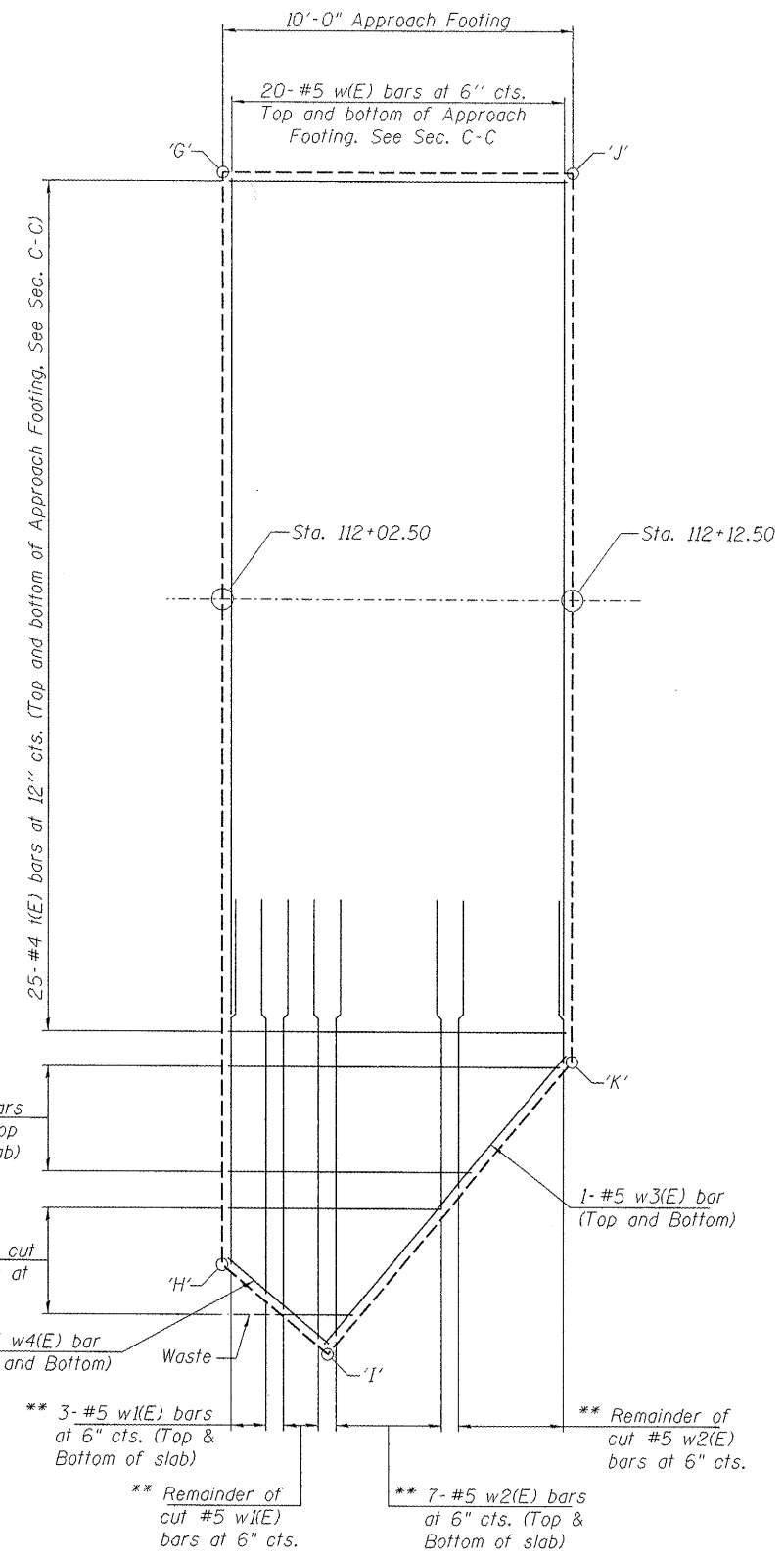

APPROACH FOOTING REINFORCEMENT PLAN

Notes:
 See sheet 9 of 23 for Section B-B.
 See sheet 11 of 23 for Sections C-C and E-E.
 a4(E) thru a9(E) bar spacings measured along \perp Rdwy.

** Order these bars full length, field cut to fit area shown, and use remainder of bars in adjacent bar pattern.
 See Field Cutting Diagram and Dimension Table on sheet 11 of 23.