

|         |      |
|---------|------|
| FINAL   | DATE |
| SURVEY  | BY   |
| NOTED   |      |
| BOOK    |      |
| NO.     |      |
| TEMPLAT |      |
| AREAS   |      |
| CHECKED |      |

|          |      |
|----------|------|
| ORIGINAL | DATE |
| SURVEY   | BY   |
| NOTED    |      |
| BOOK     |      |
| NO.      |      |
| TEMPLAT  |      |
| AREAS    |      |
| CHECKED  |      |

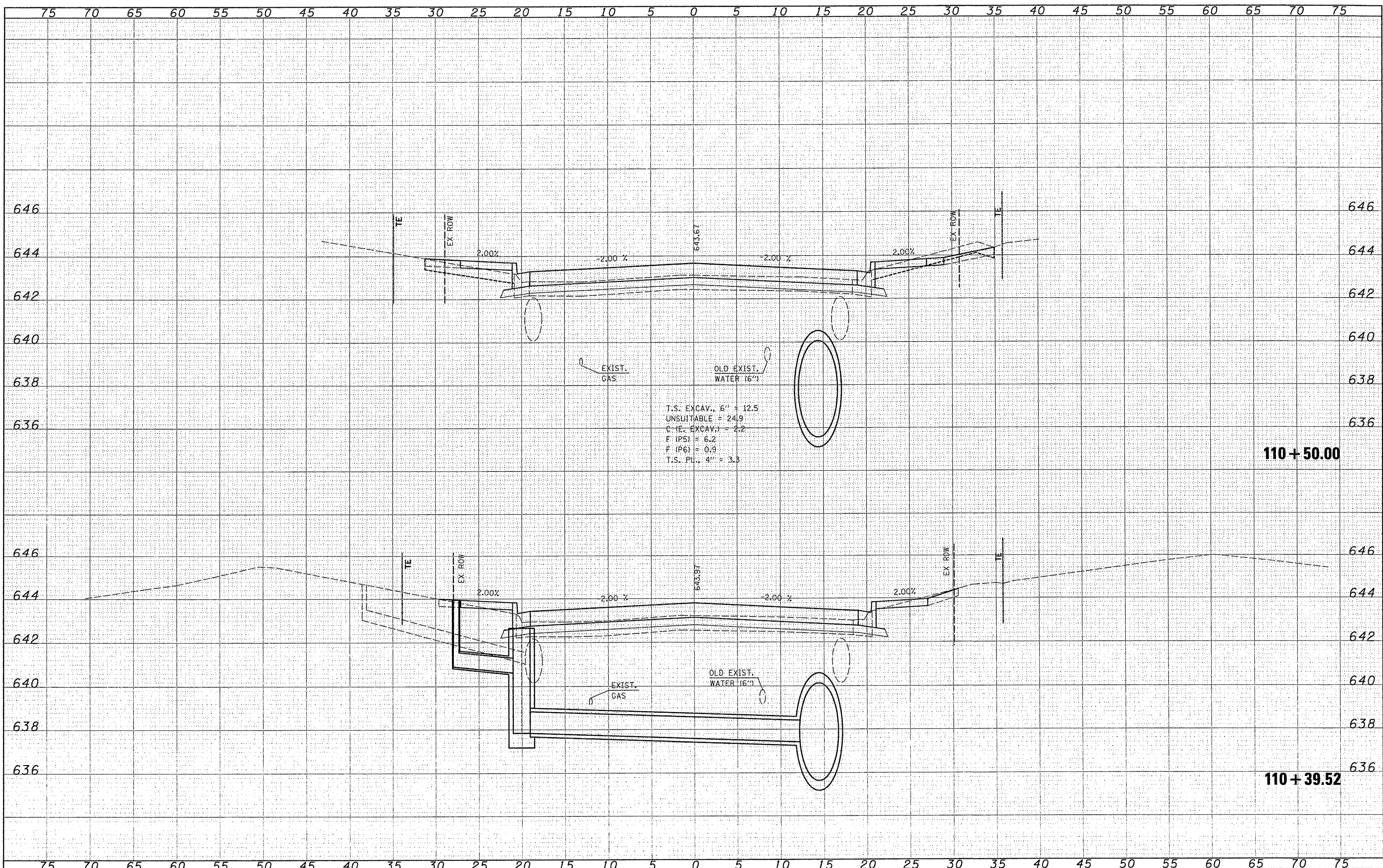

FILE NAME =  
 H:\6195\water\loc\moore\Phase\VIC400-ROADWAY\6195-01\2012-11\22\_P.dgn  
 PLOT SCALE = 5/8822" / 1"  
 PLOT DATE = 3/21/2012

|             |            |           |
|-------------|------------|-----------|
| USER NAME = | DESIGNED - | REVISED - |
| USERDESCR = | DRAWN -    | REVISED - |
| PLT DATE =  | CHECKED -  | REVISED - |
|             | DATE -     | REVISED - |

**STATE OF ILLINOIS  
 DEPARTMENT OF TRANSPORTATION**

**F.A.U. 9315 (MOORE STREET)**  
 SCALE: SHEET NO. OF SHEETS STA. 110+39.52 TO STA. 110+50.00

|   |                |        |                    |           |
|---|----------------|--------|--------------------|-----------|
| F.A.U. RTE.                                   | SECTION        | COUNTY | TOTAL SHEETS       | SHEET NO. |
| 9315  | 06-00032-03-PV | MONROE | 93                 | 82        |
| FED. ROAD DIST. NO. ILLINOIS FED. AID PROJECT |                |        | CONTRACT NO. 97488 |           |