

INDEX OF SHEETS

SHEET NUMBER	DESCRIPTION
1	COVER SHEET
2	GENERAL NOTES AND LEGEND
3	SUMMARY OF QUANTITIES
4-7	TYPICAL SECTIONS - EXISTING
8-11	TYPICAL SECTIONS - PROPOSED
12-15	QUANTITY SCHEDULES
16-24	PLAN AND PROFILE SHEETS
25-35	MAINTENANCE OF TRAFFIC - ADVANCED WARNING SIGNS & STAGES OF CONSTRUCTION
36-40	PAVEMENT MARKING SHEETS
41-45	PAVEMENT PATCHING SHEETS
46-50	REMOVAL SHEETS
51-57	SIDEWALK RAMP PLAN SHEETS
58	MISCELLANEOUS DETAIL SHEETS

STATE OF ILLINOIS
DEPARTMENT OF TRANSPORTATION
DIVISION OF HIGHWAYS
**PLANS FOR PROPOSED
ROADWAY IMPROVEMENT**

F.A.U. ROUTE 9101 (13TH STREET & ELIZABETH AVENUE)
F.A.U. ROUTE 9107 (McCAMBRIDGE AVENUE)
SECTION NO. 09-00057-00-PV
PROJECT NO. M-5011(332)
JOB NO. C-98-333-11
CITY OF MADISON
MADISON COUNTY

STANDARDS

STD. NO.	
000001-06	606001-04
001006	701301-04
424001-06	701501-06
424006	701801-05
424011	701901-02
424016	720001-01
424021	720006-03
442201-03	720011-01
602306-03	729001-01
602601-02	780001-03
604071-04	B.L.R. 17-1

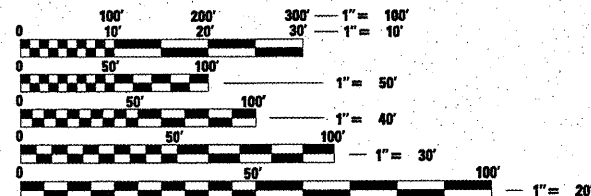

FULL SIZE PLANS HAVE BEEN PREPARED USING STANDARD ENGINEERING SCALES. REDUCED SIZED PLANS WILL NOT CONFORM TO STANDARD SCALES. IN MAKING MEASUREMENTS ON REDUCED PLANS, THE ABOVE SCALES MAY BE USED.

J.U.L.I.E.
JOINT UTILITY LOCATION INFORMATION FOR EXCAVATION
1-800-892-0123
OR 811

DESIGN DESIGNATION

13TH STREET	ELIZABETH STREET	McCAMBRIDGE AVENUE
FUNCTIONAL CLASSIFICATION: COLLECTOR	FUNCTIONAL CLASSIFICATION: COLLECTOR	FUNCTIONAL CLASSIFICATION: COLLECTOR
ADT: 400 (2011) 488 (2031)	ADT: 700 (2011) 840 (2031)	ADT: 800 (2011) 1080 (2031)
DHV (2031): 44	DHV (2031): 84	DHV (2031): 108
DESIGN SPEED: 25 MPH	DESIGN SPEED: 25 MPH	DESIGN SPEED: 25 MPH

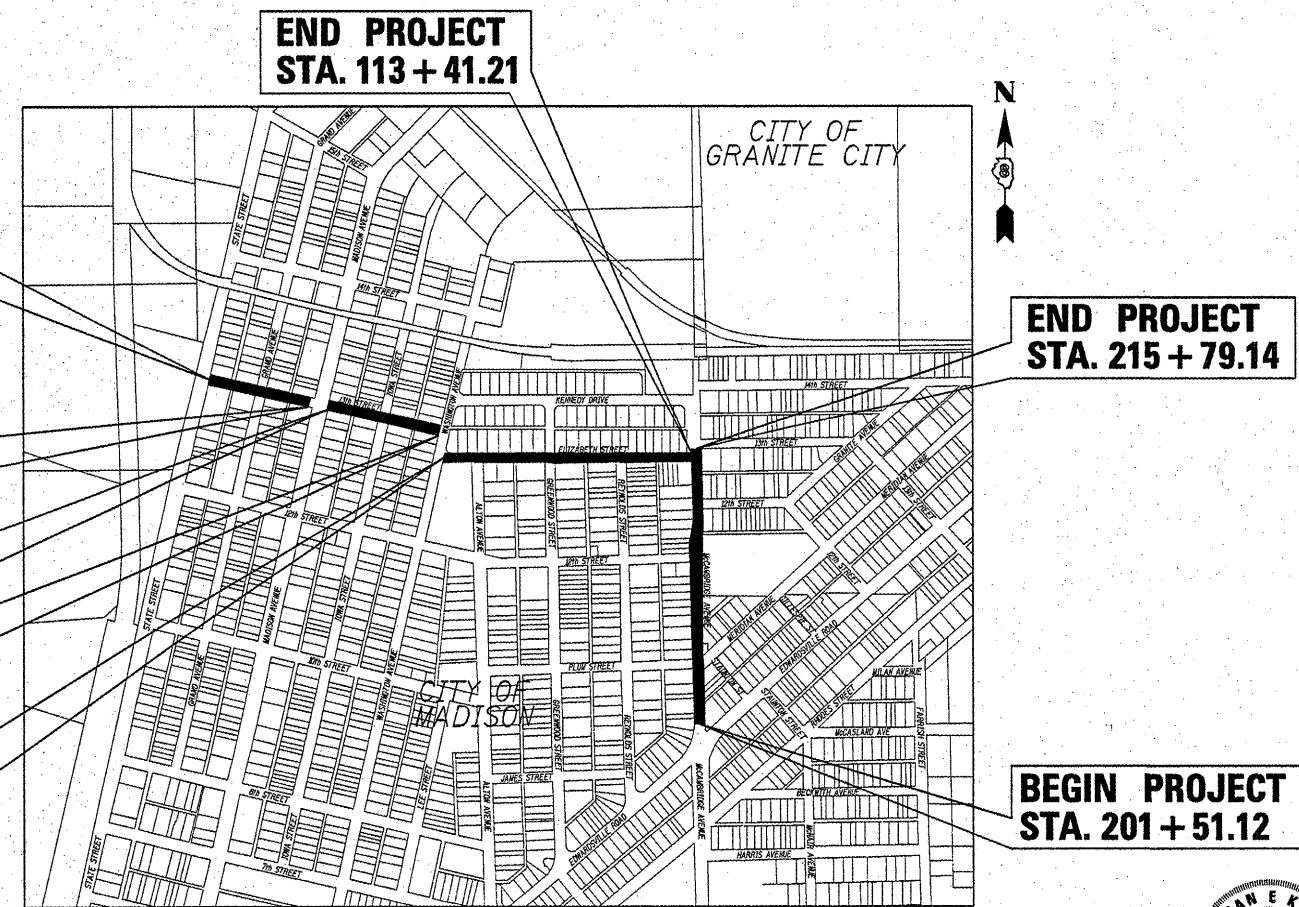

LOCATION MAP

SCALE: 1" = 500'

GROSS LENGTH OF 13TH STREET: 1256.4 LIN. FT. = 0.238 MILES
GROSS LENGTH OF 13TH STREET OMISSION: 85.4 LIN. FT. = 0.016 MILES
GROSS LENGTH OF ELIZABETH AVENUE: 1323.0 LIN. FT. = 0.251 MILES
GROSS LENGTH OF McCAMBRIDGE AVENUE: 1428.0 LIN. FT. = 0.270 MILES
NET LENGTH OF PROJECT: 3922 LIN. FT. = 0.743 MILES
SECTIONS 24 & 25, T. 3 N., R. 10 W., 3RD P.M. & SECTION 30, T. 3 N., R. 9 W., 3RD P.M.

F.A.U. RTE.	SECTION	COUNTY	TOTAL SHEETS	SHEET NO.
9101	09-00057-00-PV	MADISON	58	1
FED. ROAD DIST. NO.		ILLINOIS	CONTRACT NO. 97489	

FEDERAL AID PROJECT

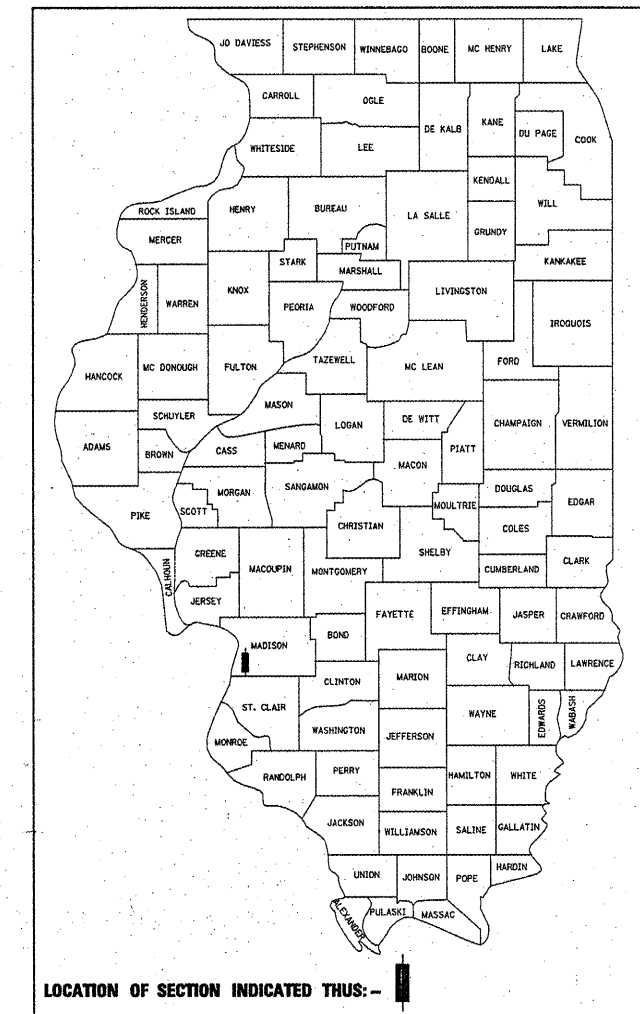

LOCATION OF SECTION INDICATED THUS: -

STATE OF ILLINOIS DEPARTMENT OF TRANSPORTATION

Approved: *[Signature]* 3/13/12
City of Madison, Mayor

Passed: *[Signature]* 4-4-12
District 8 Engineer of Local Roads & Streets

Releasing for Bld Based on Limited Review: *[Signature]* 4-4-12
Deputy Director of Highways, Region 5 Engineer

PRINTED BY THE AUTHORITY OF THE STATE OF ILLINOIS



Expires 11-30-13

[Signature] 3/13/12
BRIAN F. KULICK, P.E. No. 49936 DATE
Job No. E111003



2100 State Street, P.O. Box 1325
Granite City, IL 62040
618-877-1400 F. 618-452-5541

100 North Research Drive
Edwardsville, IL 62025
618-659-0900 F. 618-659-0941

330 N. Fourth Street, Suite 200
St. Louis, MO 63102
314-241-4444 F. 314-909-1331

Professional Design Firm License No. 184.003389