



DATE	
BY	
PLAN	
SURVEYED	
NOTE BOOK	
ALIGNED	
CHECKED	
BY	
NO.	

DATE	
BY	
PROFILE	
SURVEYED	
GRADES	
CHECKED	
BY	
NO.	

**LEGEND**

-  CLASS C PATCHES, TYPE II
-  CLASS C PATCHES, TYPE III
-  CLASS C PATCHES, TYPE IV

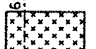
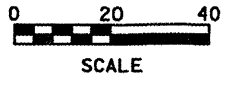
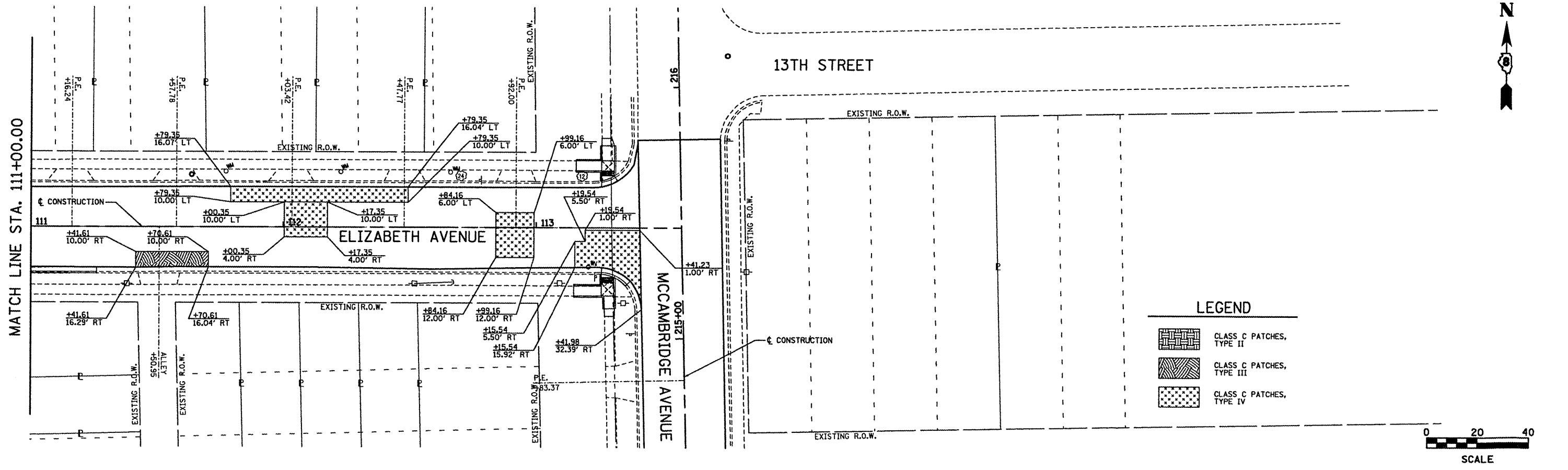
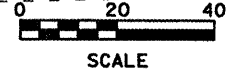
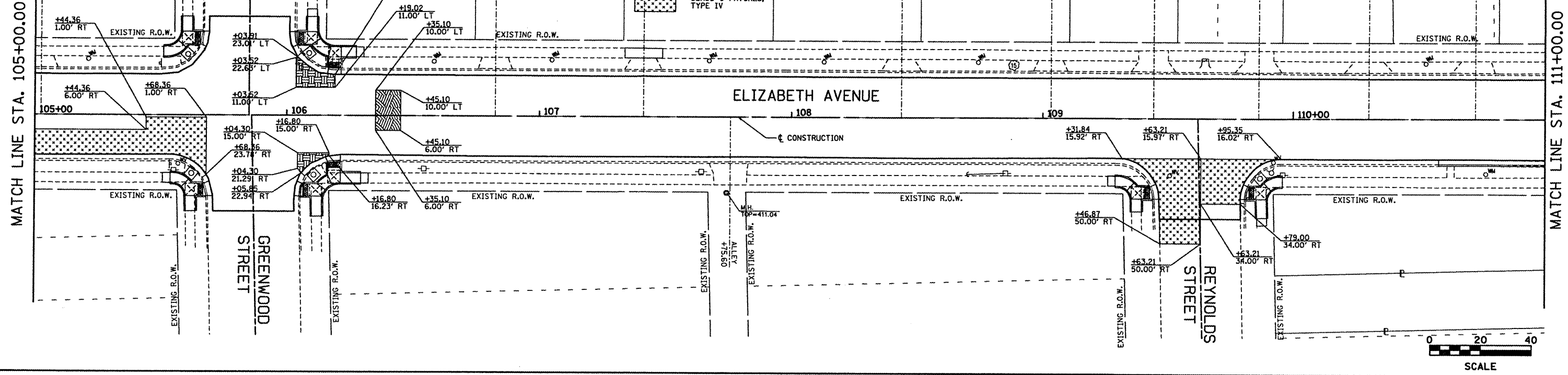

FILE NAME = patching 03.dgn

USER NAME = jeremy	DESIGNED - SAS	REVISED -
PLOT SCALE = #SCALE#	DRAWN - JJB	REVISED -
PLOT DATE = 3/29/2012	CHECKED - BFK	REVISED -
	DATE - 03/13/12	REVISED -

**CITY OF MADISON  
13TH STREET, ELIZABETH AVE,  
AND MCCAMBRIDGE AVE REHABILITATION**

SCALE: 1"=20'	SHEET NO. 3 OF 5 SHEETS	STA. 105+00.00 TO STA. 113+57.74
---------------	-------------------------	----------------------------------

F.A.U. RTE. 9101	SECTION 09-00057-00-PV	COUNTY MADISON	TOTAL SHEETS 58	SHEET NO. 43
CONTRACT NO. 97489				
ILLINOIS FED. AID PROJECT				