

NOTES

1. DISCONNECT HOMERUN CABLES AT EDGE LIGHTS AND INSTALL NEW JUMPER CABLE BETWEEN LIGHTS (PAY ITEM - AR108108).
2. SPLICE INTO CIRCUIT AT EDGE LIGHT AND BEGIN NEW CIRCUIT HOMERUN.
3. COSTS FOR CABLE SPLICES SHALL BE INCIDENTAL TO THE SPLICE CAN AND CABLE ITEM.
4. REMOVE ABANDONED HOMERUNS FROM EXISTING DUCTS.
5. PRIOR TO DIRECTIONAL BORING, THE CONTRACTOR SHALL EXPOSE THE EXISTING RUNWAY EDGE LIGHTING CABLE TO DETERMINE THE LOCATION (TYPICAL BOTH SIDES OF RUNWAY). LOCATE THE PROPOSED DIRECTIONAL BORE BELOW THE EXISTING RUNWAY EDGE LIGHTING CIRCUIT CABLE

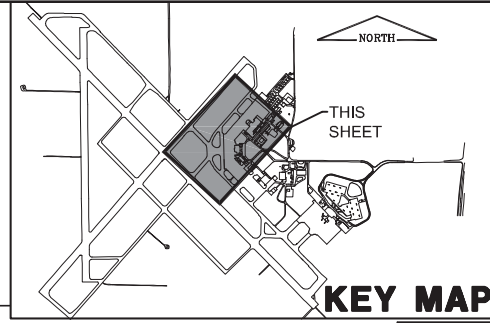
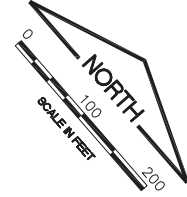

K:\Champaign\1105903\Draw\Sheets
 FILE: 1105903-E-1202.dwg
 UPDATE BY: Chris Groth
 PLOT DATE: 4/30/2012 3:49 PM
 KEYMAP
 BASE_PROP_ELEC
 Coally
 BASE_PROP_VAULT
 UTILITY_CMI

UN051

REVISIONS		
NUMBER	BY	DATE

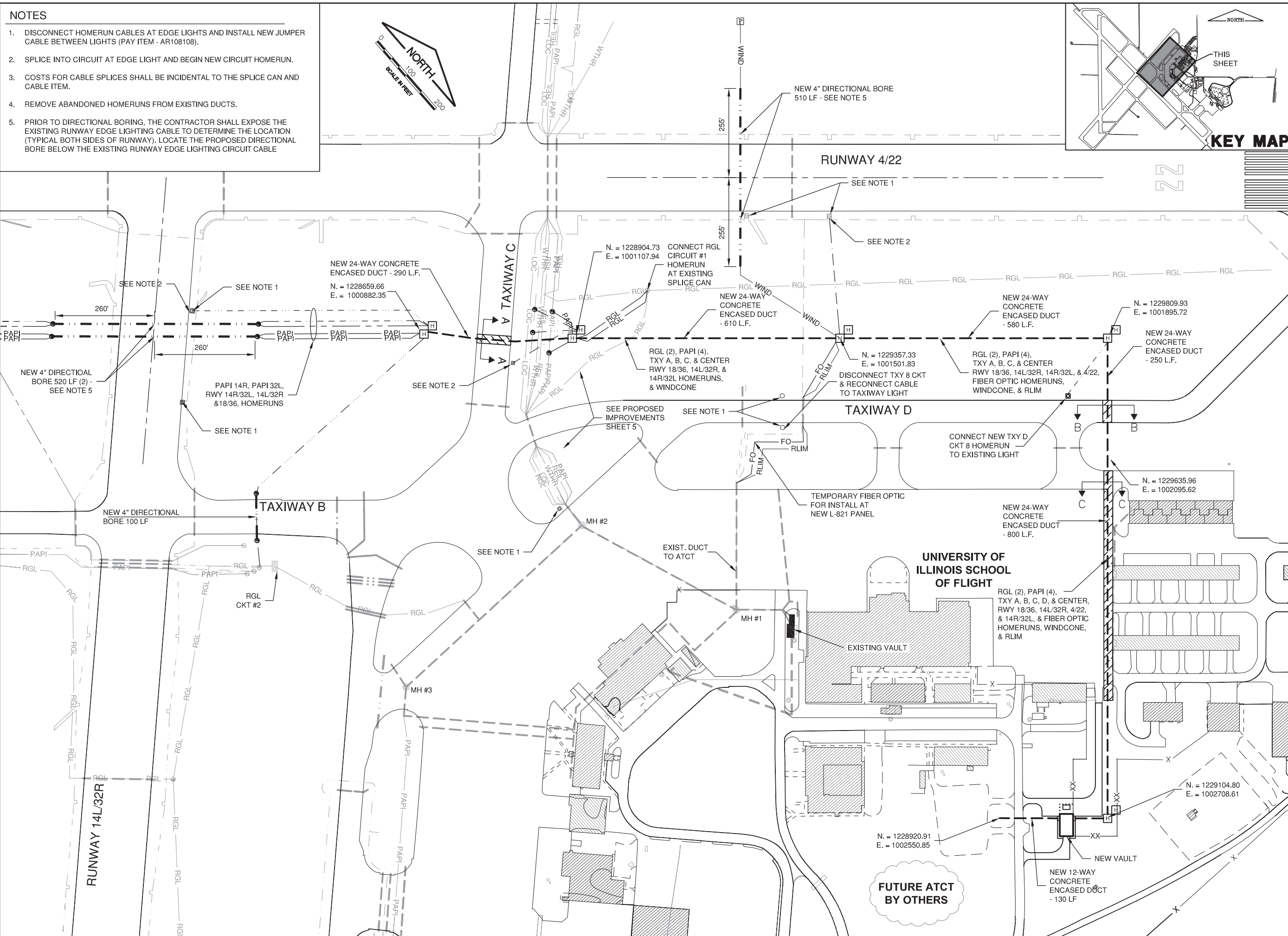
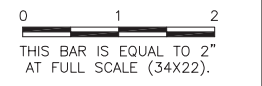

**WILLARD AIRPORT
 UNIVERSITY OF ILLINOIS
 NEW AIRFIELD LIGHTING VAULT
 PROPOSED IMPROVEMENTS 2**

© Copyright CMT, Inc.
CMT
 CRAWFORD, MURPHY & TILLY, INC.
 CONSULTING ENGINEERS
 License No. 184-000613

DESIGN BY:	KLB/AJB
DRAWN BY:	CMT
CHECKED BY:	CBG
APPROVED BY:	CET
DATE:	APRIL 20, 2012
JOB No:	11059-03
IL PROJ. NO.	CMI-4100
AIP PROJ. NO.	3-17-0016-XX
SHEET	19 OF 60 SHEETS