

**UN051**

REVISIONS		
NUMBER	BY	DATE

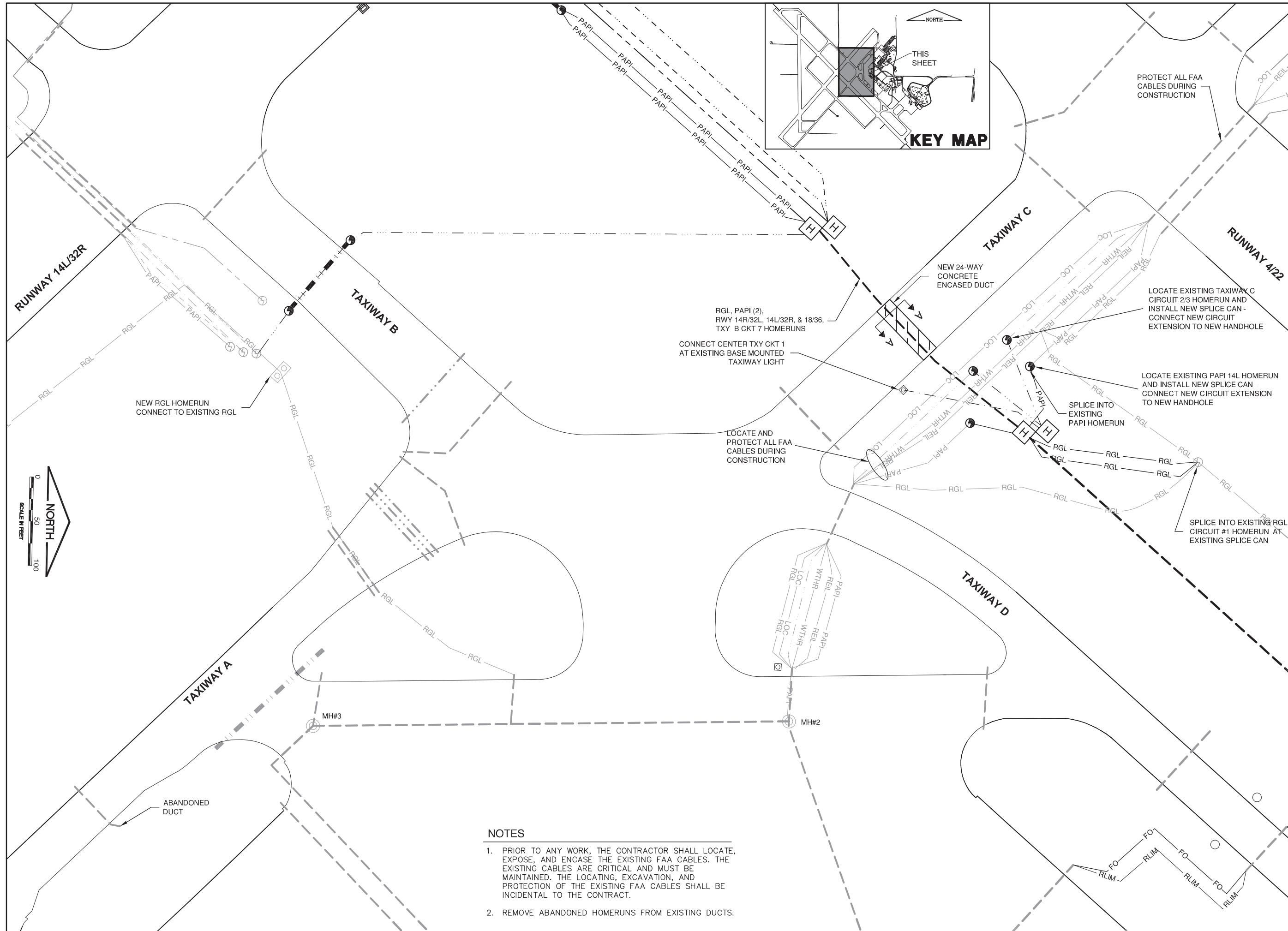
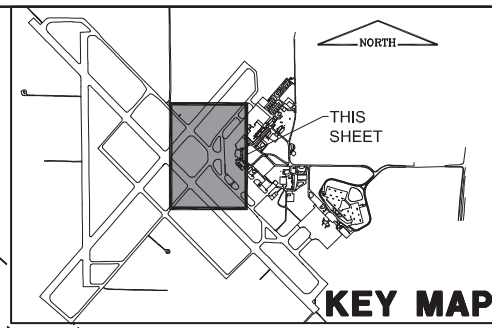
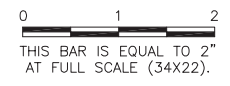

**NOTES**

1. PRIOR TO ANY WORK, THE CONTRACTOR SHALL LOCATE, EXPOSE, AND ENCASE THE EXISTING FAA CABLES. THE EXISTING CABLES ARE CRITICAL AND MUST BE MAINTAINED. THE LOCATING, EXCAVATION, AND PROTECTION OF THE EXISTING FAA CABLES SHALL BE INCIDENTAL TO THE CONTRACT.
2. REMOVE ABANDONED HOMERUNS FROM EXISTING DUCTS.

WILLARD AIRPORT  
 UNIVERSITY OF ILLINOIS

**NEW AIRFIELD LIGHTING VAULT  
 PROPOSED IMPROVEMENTS 3**

© Copyright CMT, Inc.  
**CMT**  
 CRAWFORD, MURPHY & TILLY, INC.  
 CONSULTING ENGINEERS  
 License No. 184-000613

DESIGN BY:	CBG
DRAWN BY:	CMT
CHECKED BY:	CET
APPROVED BY:	CET
DATE:	APRIL 20, 2012
JOB No:	11059-03
IL PROJ. NO.	CMI-4100
AIP PROJ. NO.	3-17-0016-XX
SHEET	20 OF 60 SHEETS