

SECTION	COUNTY	TOTAL SHEETS	SHEET NO.
1240	COOK	20	8
STA. TO STA.		FED. ROAD DIST NO 7 ILLINOIS	
		FED AID PROJECT	

CONTRACT NO: 60722

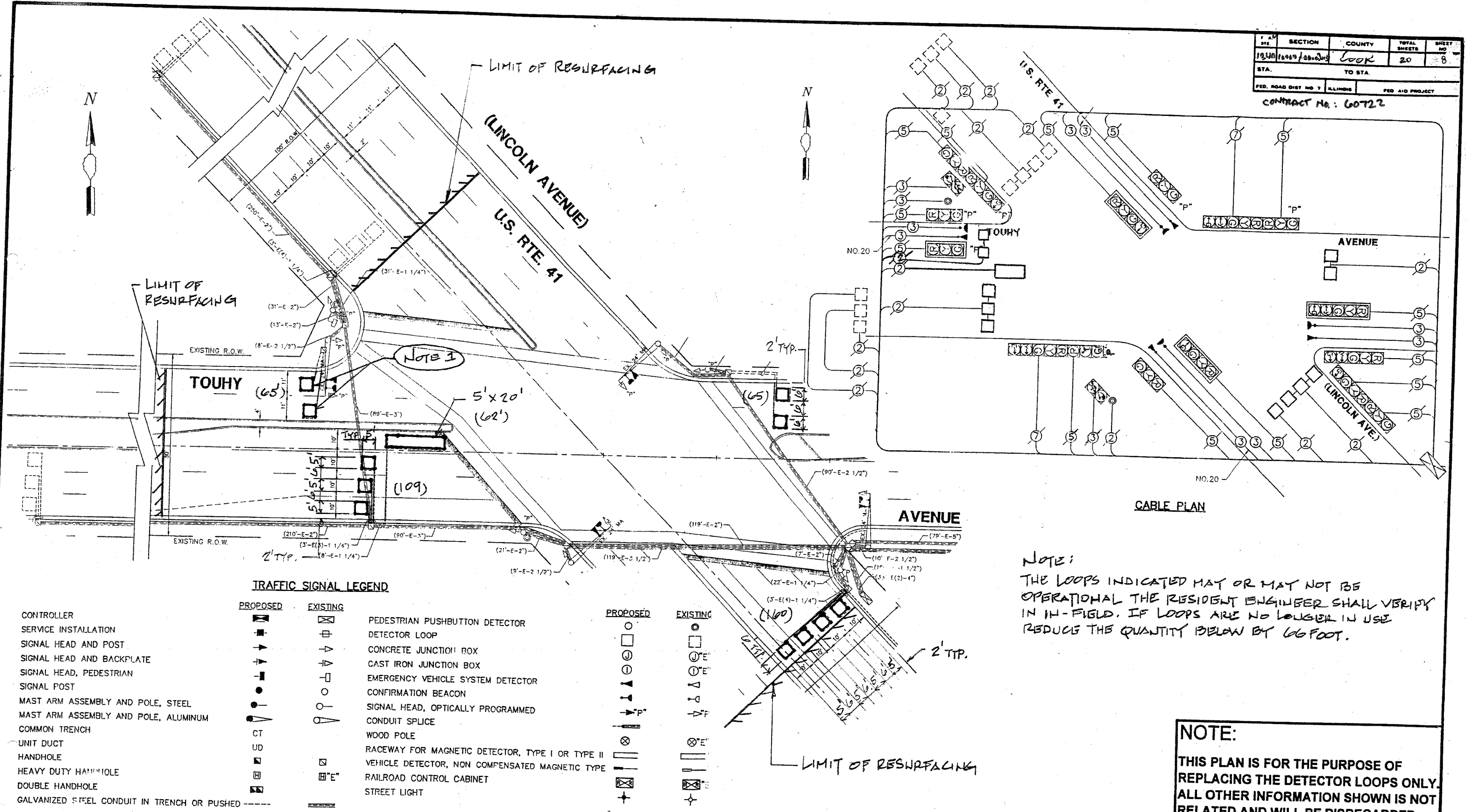

TRAFFIC SIGNAL LEGEND

CONTROLLER	PROPOSED	EXISTING	PEDESTRIAN PUSHBUTTON DETECTOR
SERVICE INSTALLATION	■	□	DETECTOR LOOP
SIGNAL HEAD AND POST	▲	◻	CONCRETE JUNCTION BOX
SIGNAL HEAD AND BACKPLATE	▼	◻	CAST IRON JUNCTION BOX
SIGNAL HEAD, PEDESTRIAN	▲	◻	EMERGENCY VEHICLE SYSTEM DETECTOR
SIGNAL POST	●	○	CONFIRMATION BEACON
MAST ARM ASSEMBLY AND POLE, STEEL	●	○	SIGNAL HEAD, OPTICALLY PROGRAMMED
MAST ARM ASSEMBLY AND POLE, ALUMINUM	●	○	CONDUIT SPLICE
COMMON TRENCH	CT	○	WOOD POLE
UNIT DUCT	UD	○	RACEWAY FOR MAGNETIC DETECTOR, TYPE I OR TYPE II
HANDHOLE	□	□	VEHICLE DETECTOR, NON COMPENSATED MAGNETIC TYPE
HEAVY DUTY HANDHOLE	□	□	RAILROAD CONTROL CABINET
DOUBLE HANDHOLE	□	□	STREET LIGHT
GALVANIZED STEEL CONDUIT IN TRENCH OR PUSHED	---	---	

NOTE:
THE LOOPS INDICATED MAY OR MAY NOT BE OPERATIONAL THE RESIDENT ENGINEER SHALL VERIFY IN THE FIELD. IF LOOPS ARE NO LONGER IN USE REDUCE THE QUANTITY BELOW BY 66 FOOT.

NOTE:
THIS PLAN IS FOR THE PURPOSE OF REPLACING THE DETECTOR LOOPS ONLY. ALL OTHER INFORMATION SHOWN IS NOT RELATED AND WILL BE DISREGARDED.

REPLACE ALL DETECTOR LOOPS AS SHOWN
(WITHIN THE RESURFACING LIMITS)

CODE NO.	QUANTITY	UNIT	ITEM
00000000	461	Foot	Detector Loop Replacement

REVISIONS	
NAME	DATE

ILLINOIS DEPARTMENT OF TRANSPORTATION
DETECTOR LOOP REPLACEMENT
U.S. RTE. 41 @ TOUHY AVENUE
SCALE: 1" = 20'
DATE: APRIL 2005
DRAWN BY: JHE
DESIGNED BY: JHE
CHECKED BY: JHE