

CONTRACT NO.				
F.A. RYE.	SECTION	COUNTY	TOTAL SHEETS	SHEET NO.
94	**	COOK	19	16
STA.		TO STA.		
FED. ROAD DIST. NO.		ILLINOIS FED. AID PROJECT		
		60808		
** 2005-087CR-PP				

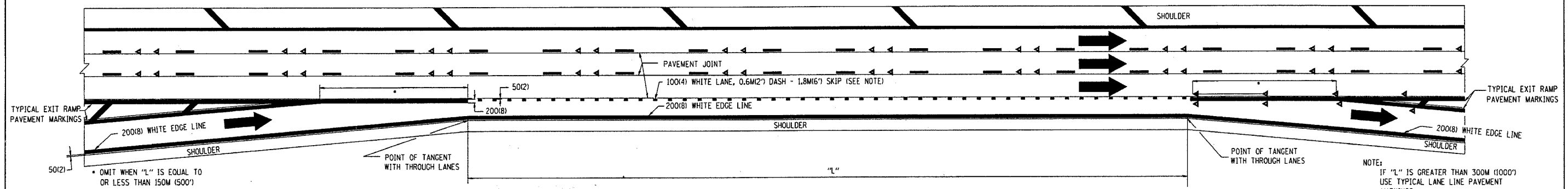

TYPICAL ENTRANCE/EXIT RAMP COMBINATION PAVEMENT MARKINGS

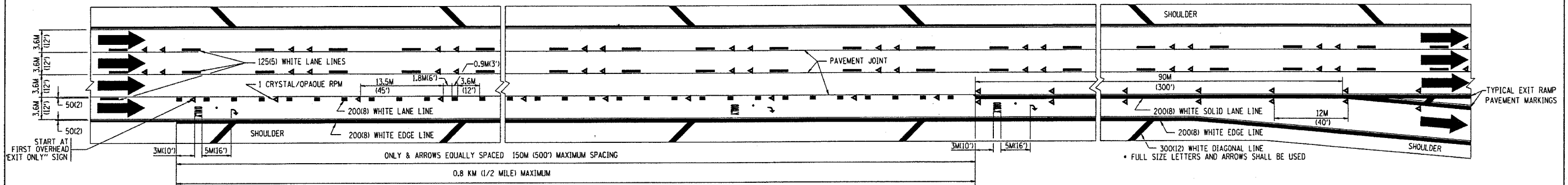

TYPICAL EXIT ONLY LANE PAVEMENT MARKINGS

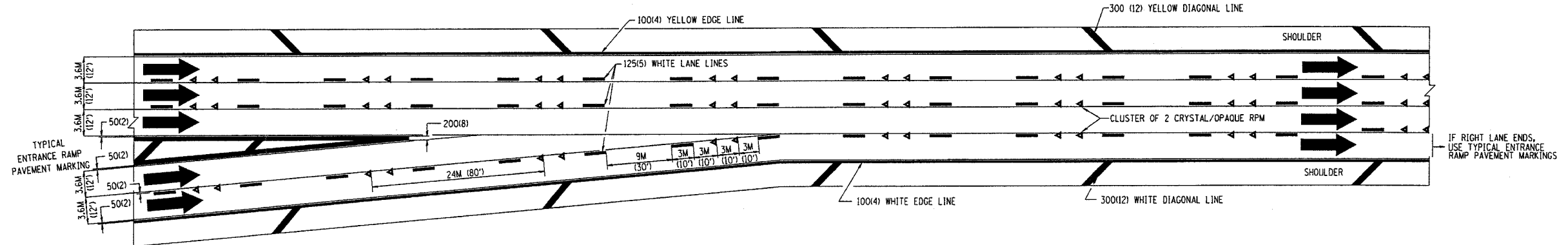

TYPICAL TWO LANE ENTRANCE RAMP PAVEMENT MARKINGS

REVISIONS	
NAME	DATE
DWS	1/90
DWS	5/91

ILLINOIS DEPARTMENT OF TRANSPORTATION
**MULTI-LANE FREEWAY
 PAVEMENT MARKING
 DETAILS**

SCALE: NONE
 DATE: 3/1/2006
 DRAWN BY: C.A.D.D.
 CHECKED BY:
 TC12 SHEET 2 OF 2
 REVISION DATE: 02/28/06

PLOT DATE: 3/1/2006
 FILE NAME: K:\highway\pavement\pavement.dwg
 PLOT SCALE: 1/8" = 1'-0"
 USER: HWP