

F.A.I. RTE.	SECTION	COUNTY	TOTAL SHEETS	SHEET NO.
55	2006-017 RS	DUPAGE & WILL	17	7
STA. 0+00		TO STA. 14+86		
FED. ROAD DIST. NO. 1		ILLINOIS HIGHWAY PROJECT		

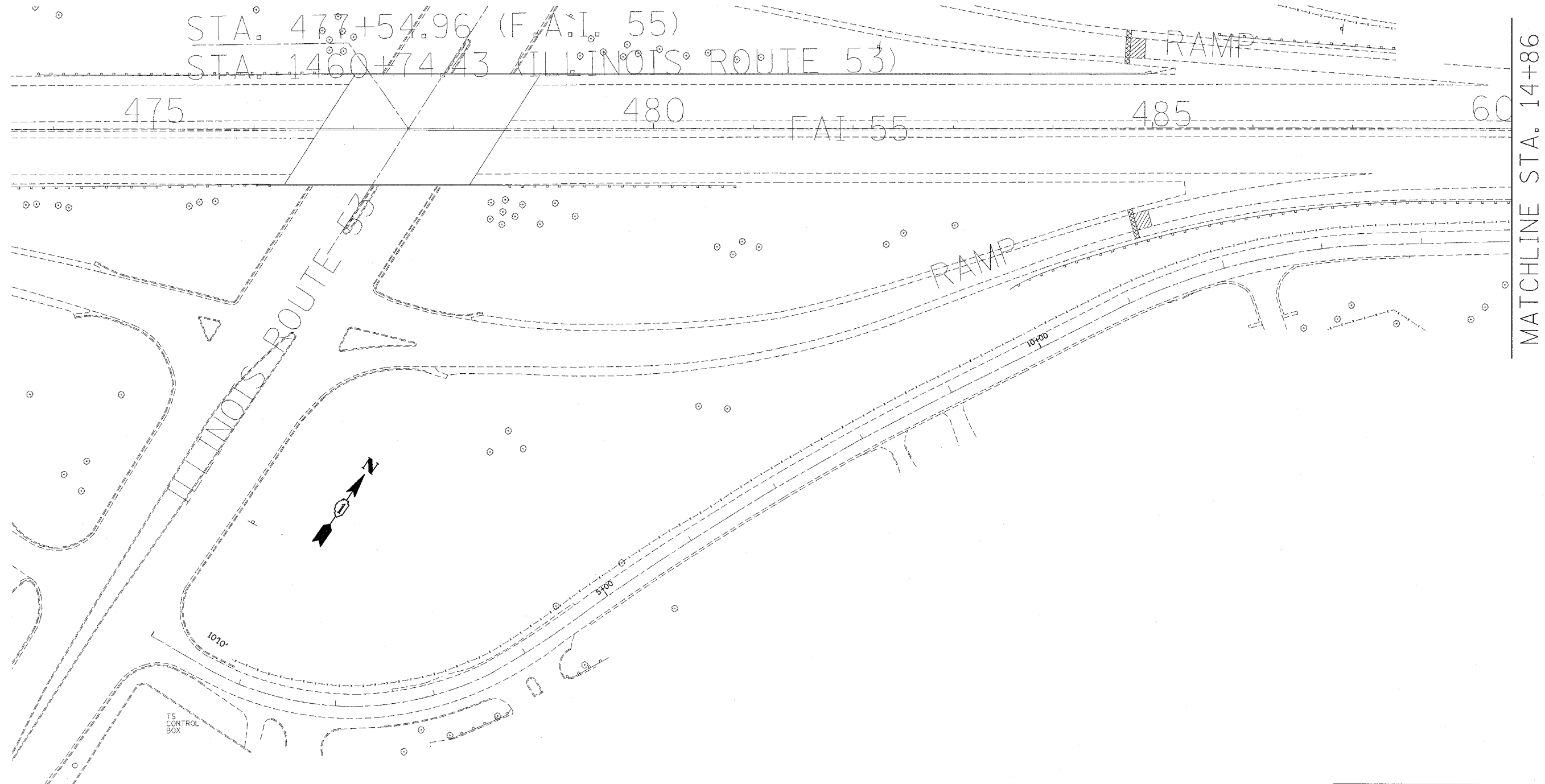

5/4/2006  
 c:\projects\13106\design-co.dgn  
 \*REF-  
 \*REF-

VI=

REVISIONS	
NAME	DATE

ILLINOIS DEPARTMENT OF TRANSPORTATION

**LOCATION 2: JOLIET RD. TO IL 53**  
 (SOUTH FRONTAGE RD.)

SCALE: VERT. 1"=50'  
 HORIZ. 1"=50'  
 DATE 5/4/2006

DRAWN BY \_\_\_\_\_  
 CHECKED BY \_\_\_\_\_