

F.A.I. RTE.	SECTION	COUNTY	TOTAL SHEETS	SHEET NO.
55	2006-017 RS	DUPAGE & WILL	17	9
STA. 59+89		TO STA. 85+44		
FED. ROAD DIST. NO. 1		ILLINOIS HIGHWAY PROJECT		

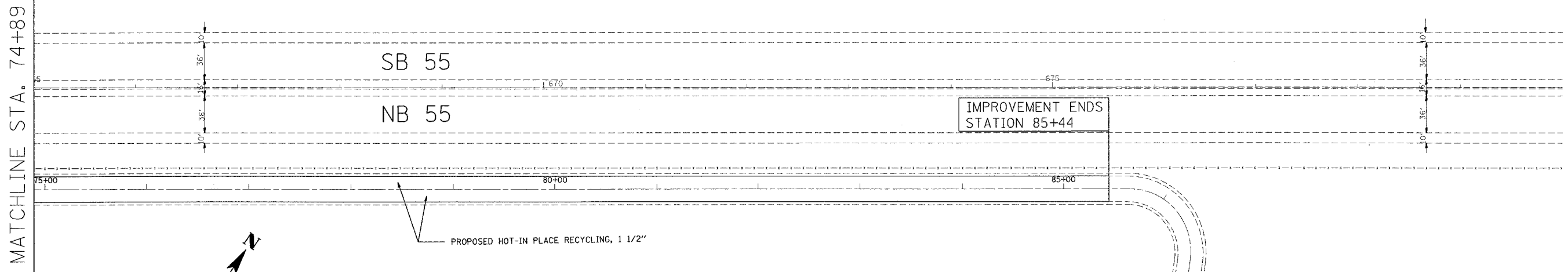

NOTE: AGGREGATE SHOULDERS TO BE DONE BY OTHERS.

IMPROVEMENT ENDS STATION 85+44

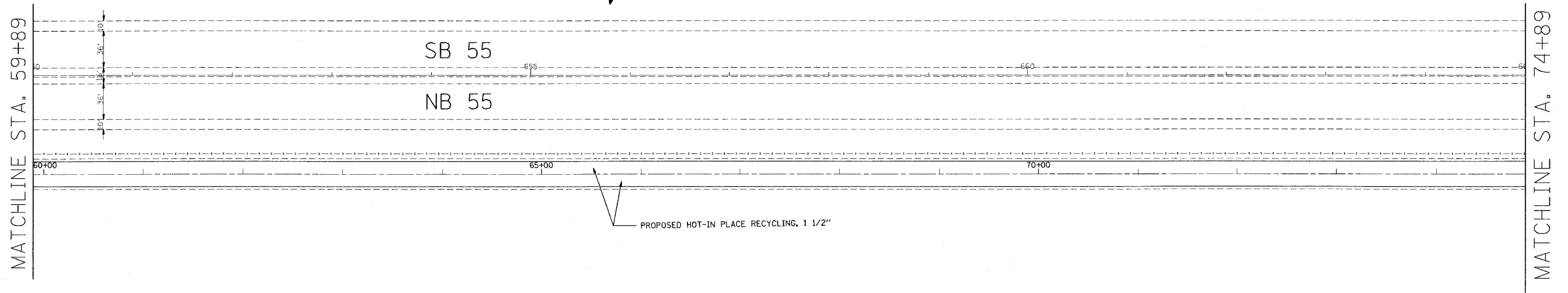
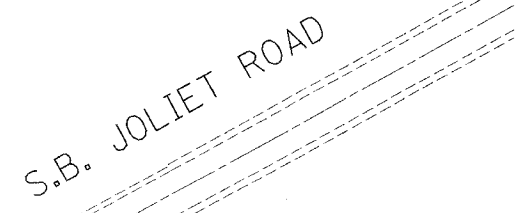

ILLINOIS DEPARTMENT OF TRANSPORTATION

LOCATION 2: JOLIET RD. TO IL 53 (SOUTH FRONTAGE RD.)

REVISIONS	
NAME	DATE

SCALE: VERT. 1"=50'
HORIZ. 1"=50'

DATE 5/4/2006

DRAWN BY _____
CHECKED BY _____

5/4/2006
c:\p\objects\gd13106\design-ca.dgn
REF-
REF-

Rev.

VI=