

F.A.U. RTE.	SECTION	COUNTY	TOTAL SHEETS	SHEET NO.
3520	2005-001 RS	COOK	37	9
STA. 59+00		TO STA. 72+00		
FED. ROAD DIST. NO. 1		ILLINOIS FED. AID PROJECT		

CONTRACT NO. 62903

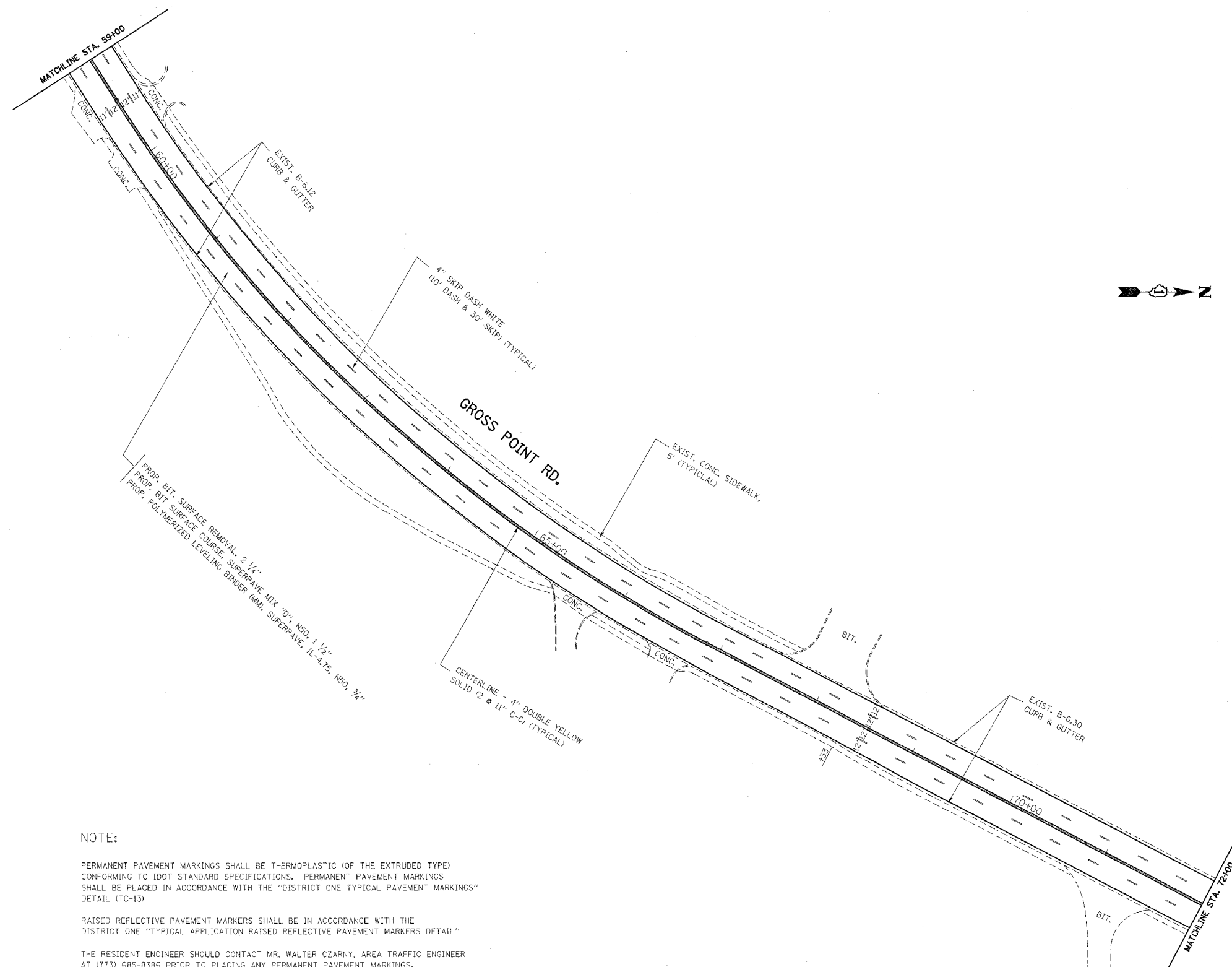

NOTE:

PERMANENT PAVEMENT MARKINGS SHALL BE THERMOPLASTIC (OF THE EXTRUDED TYPE) CONFORMING TO IDOT STANDARD SPECIFICATIONS. PERMANENT PAVEMENT MARKINGS SHALL BE PLACED IN ACCORDANCE WITH THE "DISTRICT ONE TYPICAL PAVEMENT MARKINGS" DETAIL (TC-13)

RAISED REFLECTIVE PAVEMENT MARKERS SHALL BE IN ACCORDANCE WITH THE DISTRICT ONE "TYPICAL APPLICATION RAISED REFLECTIVE PAVEMENT MARKERS DETAIL"

THE RESIDENT ENGINEER SHOULD CONTACT MR. WALTER CZARNY, AREA TRAFFIC ENGINEER AT (773) 685-8386 PRIOR TO PLACING ANY PERMANENT PAVEMENT MARKINGS.

PLOT DATE = 5/24/2006
 PLOT SCALE = 50/2000' = 1/40' IN.
 REFERENCE = REF#

REVISIONS	
NAME	DATE

ILLINOIS DEPARTMENT OF TRANSPORTATION

F.A.U. 3520: GROSS POINT RD.
ROADWAY AND PAVEMENT MARKING PLAN

SCALE: VERT. 1" = 50'
HORIZ. 1" = 50'

DATE _____ DRAWN BY _____
CHECKED BY _____