

CONTRACT NO. 62903				
F.A.I. RTE.	SECTION	COUNTY	TOTAL SHEETS	SHEET NO.
3520	2005-001 RS	COOK	37	11
STA.		TO STA.		
FED. ROAD DIST. NO. 1		ILLINOIS FED. AID PROJECT		

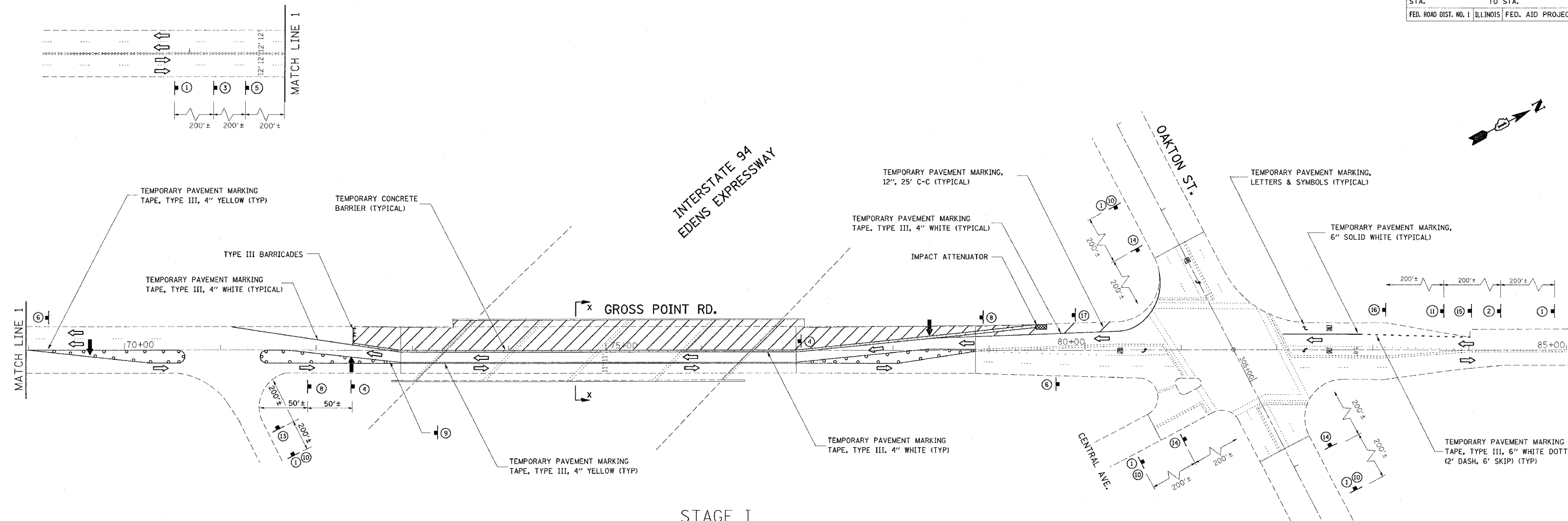

NOTES:

BARRICADES (TYPE I OR II) SHALL BE PLACED AT 50' C-C ON TANGENTS, 25' C-C ON TAPERS AND 12' C-C ON RADII
 SIGNS SHALL BE PLACED IN ACCORDANCE TO TRAFFIC CONTROL STANDARDS

LEGEND

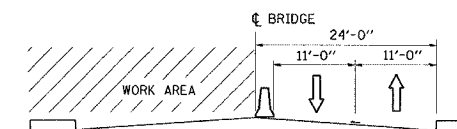
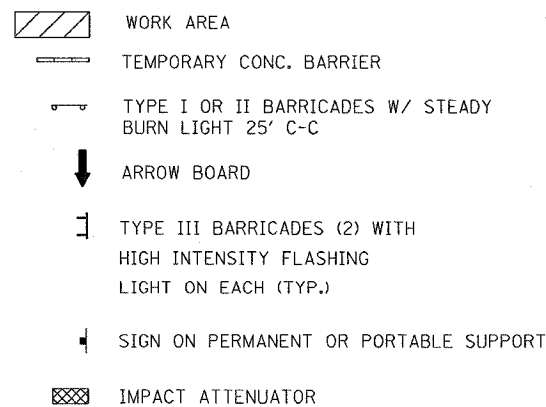
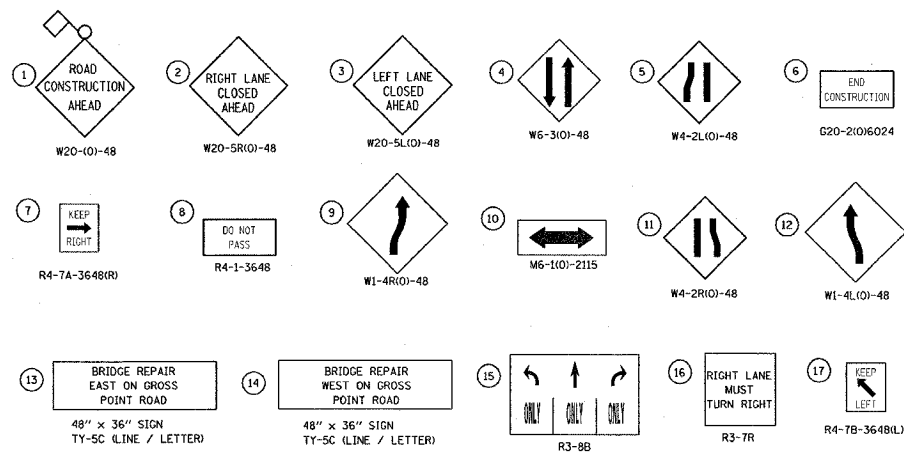

SECTION X-X
 STAGE I TYPICAL ON BRIDGE

REVISIONS	
NAME	DATE

ILLINOIS DEPARTMENT OF TRANSPORTATION
 SUGGESTED TRAFFIC CONTROL PLAN
 GROSS POINT RD. OVER
 EDENS EXPRESSWAY
 S.N. 016-0725
 SCALE: VERT. 1"=50'
 DATE _____ DRAWN BY _____
 CHECKED BY _____

PLOT DATE = 3/23/2005
 FILE NAME = c:\pvc\electra\p1814896\p1814896.dwg
 PLOT SCALE = 50.0000 / IN.
 USER NAME = wlgrenndp