

STATE OF ILLINOIS  
DEPARTMENT OF TRANSPORTATION

SHEET S10 OF S10

F.A.U. RTE.	SECTION	COUNTY	TOTAL SHEETS	SHEET NO.
3520	2005-001RS	COOK	37	22
STA.		TO STA.		
FED. ROAD DIST. NO. 1		ILLINOIS FED. AID PROJECT		
CONTRACT NO. 62903				

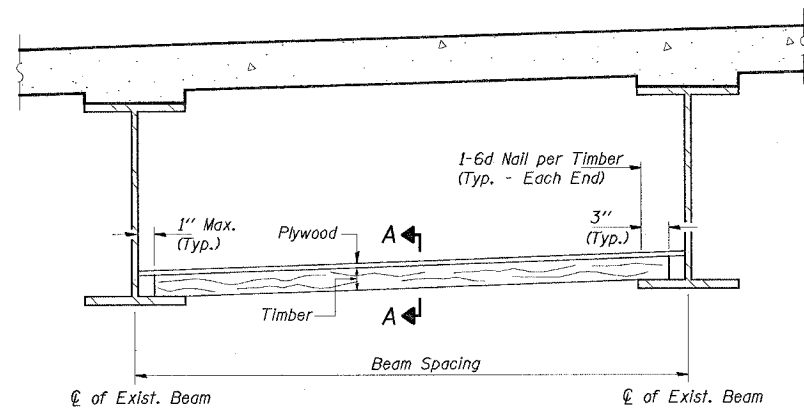

TEMPORARY PROTECTIVE SHIELD

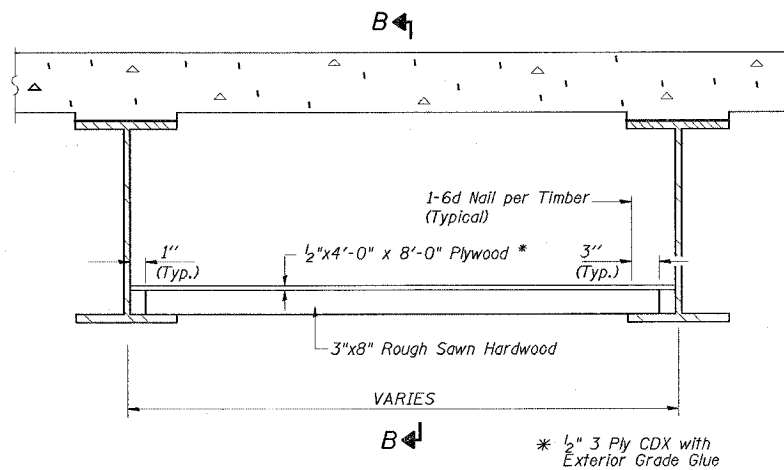

PERMANENT PROTECTIVE SHIELD

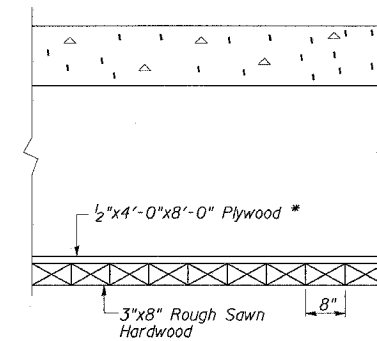

SECTION B-B

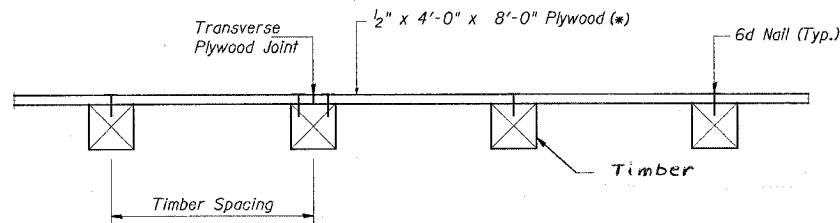

SECTION A-A

(\* 5/8" 3 PLY CDX WITH EXTERIOR GRADE GLUE

TEMPORARY PROTECTIVE SHIELD NOTES

If the contractor chooses to use different details than the ones shown, details and calculations should be submitted for review in accordance with check sheet #22 for Protective Shield System.

Timber sizes shown are nominal sizes. Rough sawn timbers of the dimensions shown will also be considered acceptable.

The minimum Fb and Fv values shown are the tabulated values given in the National Design Specification for Wood Construction for No. 2 Spruce-Pine-Fir without adjustment factors applied. Better grades or other species with equal or higher allowable stresses will also be considered acceptable.

The timber spacing shown has been determined using allowable stresses with all adjustment factors necessary for the anticipated service conditions.

All timber shall be treated.

Plywood shall be 5/8" standard C-D Group 1 Exterior (CDX) plywood.

Plywood shall be placed such that the face grain is perpendicular to the timber supports.

When less than a full sheet (4' width) of plywood is used, the width of the strip used shall not be less than 2'.

Transverse plywood joints shall be supported by timbers.

When 4" x 6" timbers are used, they should be placed such that the wide face is horizontal and the narrow face is vertical.

Design load = 200 psf.

TEMPORARY  
PROTECTIVE SHIELD REQUIREMENTS

TIMBER SPACING

Beam Spacing (ft.)	Timber Sizes (in.)		
	4" x 4" with min. Fb=775 psi Fv=135 psi	4" x 6" with min. Fb=775 psi Fv=135 psi	6" x 6" with min. Fb=575 psi Fv=125 psi
Maximum Timber Spacing (in.)			
4.5	16	16	16
4.75	16	16	16
5.0	16	16	16
5.25	16	16	16
5.5	16	16	16
5.75	16	16	16
6.0	16	16	16
6.25	12	16	16
6.5	12	16	16
6.75	12	16	16
7.0	8	16	16
7.25	8	16	16
7.5	8	16	16
7.75	8	16	16
8.0	8	12	16
8.25	8	12	16
8.5	6	12	12
8.75	6	12	12
9.0	6	8	12

PPC I-BEAM AND BULB-T

BEAM	"A"
36" I-Beam	1 1/2"
42" I-Beam	1 1/2"
48" I-Beam	1 1/2"
54" I-Beam	1 5/8"
63" Bulb-T	3 3/8"
72" Bulb-T	3 3/8"

PERMANENT PROTECTIVE SHIELD NOTES

See special provision Permanent Protective Shield System (District One).  
Plywood shall be 1/2" standard C-D Group 1 Exterior (CDX) plywood.

REVISIONS	
NAME	DATE

ILLINOIS DEPARTMENT OF TRANSPORTATION  
GROSS POINT ROAD OVER I-94  
PROTECTIVE SHIELD AND  
SILICONE JOINT SEALER DETAILS  
S.N. 016-0725

SCALE: VERT. HORIZ. DATE: MAY, 2005 DRAWN BY: MVT CHECKED BY: RSS

PLOT DATE = 3/23/2005  
 FILE NAME = c:\p\projects\1016-0725.mxd  
 PLOT SCALE = 5/8" = 1'-0"  
 PLOT BY = J. B. BROWN  
 PLOT TIME = 11:00:38 AM 3/23/2005