

F.A.W. RTE.	SECTION	COUNTY	TOTAL SHEETS	SHEET NO.
5839	1167S	ROCK ISLAND	9	7
STA.		TO STA.		
FED. ROAD DIST. NO.	ILLINOIS	FED. AID PROJECT		

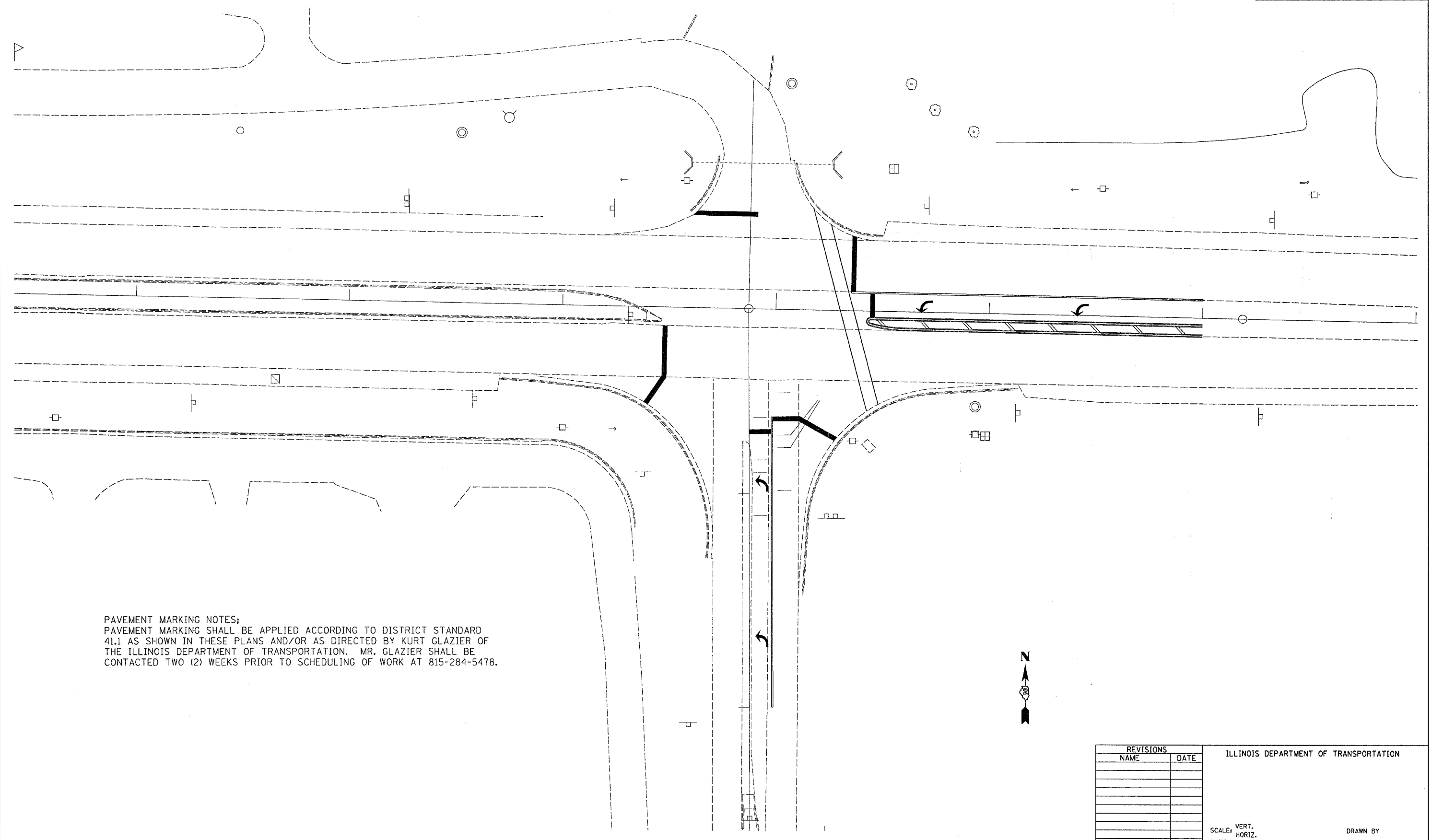

PAVEMENT MARKING NOTES;
 PAVEMENT MARKING SHALL BE APPLIED ACCORDING TO DISTRICT STANDARD 41.1 AS SHOWN IN THESE PLANS AND/OR AS DIRECTED BY KURT GLAZIER OF THE ILLINOIS DEPARTMENT OF TRANSPORTATION. MR. GLAZIER SHALL BE CONTACTED TWO (2) WEEKS PRIOR TO SCHEDULING OF WORK AT 815-284-5478.

PLOT DATE = Thu Apr 05 13:06:02 2006
 FILE NAME = P:\Projects\64B34 US6-156\plan 64b34 us 6.156.dgn
 PLOT SCALE = 20.0000 / IN.
 USER NAME = H11K1

REVISIONS	
NAME	DATE

ILLINOIS DEPARTMENT OF TRANSPORTATION

SCALE: VERT. _____
 HORIZ. _____
 DATE _____

DRAWN BY _____
 CHECKED BY _____