

F.A.U. RTE.	SECTION	COUNTY	TOTAL SHEETS	SHEET NO.
5839	116TS	ROCK ISLAND	9	1

STATE OF ILLINOIS
DEPARTMENT OF TRANSPORTATION
DIVISION OF HIGHWAYS

PROPOSED
HIGHWAY PLANS

FAU ROUTE 5839 (U.S. ROUTE 150)
SECTION 116TS
PROJECT HS-5839 (001)
ROCK ISLAND COUNTY

FOR INDEX OF SHEETS

- 1 COVER SHEET
- INDEX OF SHEETS
- STATE STANDARDS
- 2 SUMMARY OF QUANTITIES
- 3 UTILITIES
- LEGEND
- GENERAL NOTES
- 4 SIGNAL PLANS
- 5 CABLE PLANS
- 6 SERVICE INSTALLATION
- 7 PAVEMENT MARKING
- 8-9 DISTRICT STANDARD 41.1

- 701006-02 OFF-ROAD OPERATIONS 2L, 2W, 4.5 m (15') TO 600 mm (24") FROM PAVEMENT EDGE
- 701201-02 LANE CLOSURE, 2L, 2W, DAY ONLY, FOR SPEEDS > 45 MPH
- 701301-02 LANE CLOSURE, 2L, 2W, SHORT TIME OPERATIONS
- 701311-02 LANE CLOSURE, 2L, 2W, MOVING OPERATIONS - DAY ONLY
- 701701-04 URBAN LANE CLOSURE MULTILANE INTERSECTION
- 702001-06 TRAFFIC CONTROL DEVICE
- 720016-01 MAST ARM MOUNTED STREET NAME SIGNS
- 805001 ELECTRICAL SERVICE INSTALLATION DETAILS
- 814001 CONCRETE HANDHOLE
- 814006 DOUBLE HANDHOLES
- 878001-04 CONCRETE FOUNDATION DETAILS
- 857001 STANDARD PHASE DESIGNATION DIAGRAMS AND PHASE SEQUENCES
- 880006 TRAFFIC SIGNAL MOUNTING DETAILS
- 886001 DETECTOR LOOP INSTALLATION
- 886006 TYPICAL LAYOUT FOR DETECTOR LOOPS

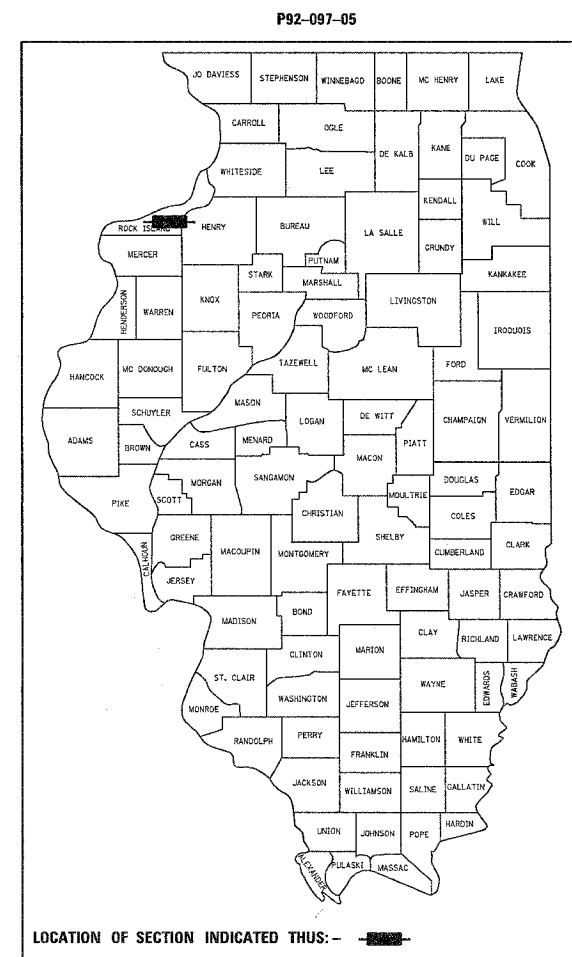

D92-097-05

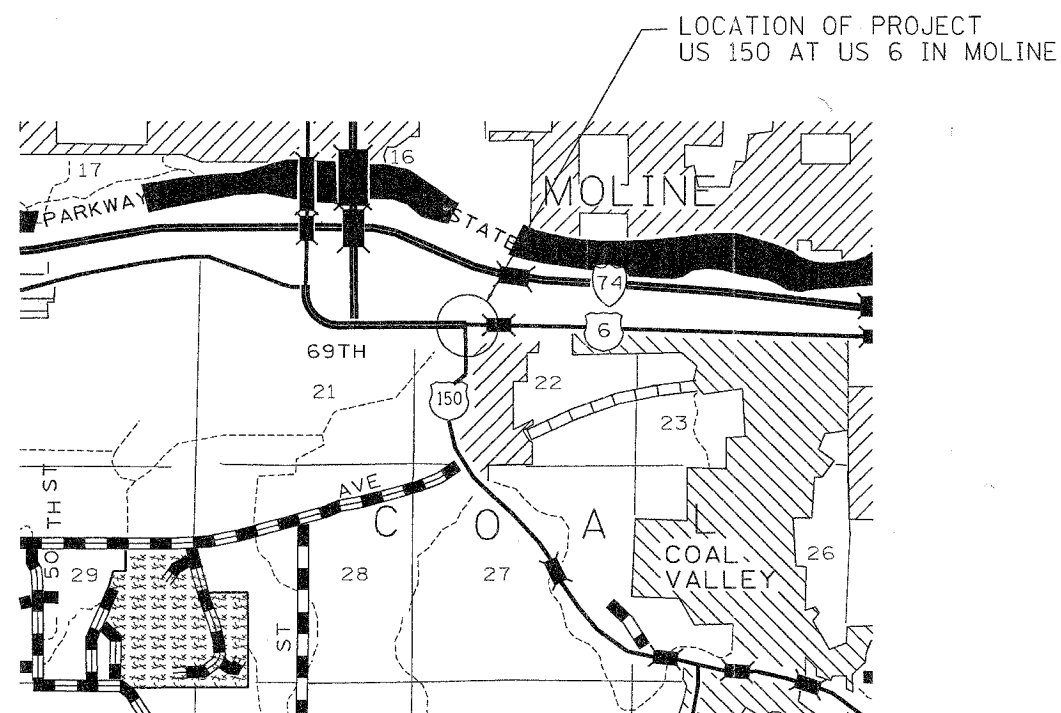

T 17 N - R 1 W

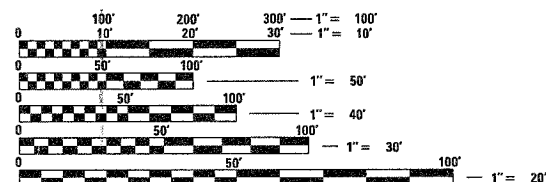

FULL SIZE PLANS HAVE BEEN PREPARED USING STANDARD ENGINEERING SCALES. REDUCED SIZED PLANS WILL NOT CONFORM TO STANDARD SCALES. IN MAKING MEASUREMENTS ON REDUCED PLANS, THE ABOVE SCALES MAY BE USED.

J.U.L.I.E.
 JOINT UTILITY LOCATION INFORMATION FOR EXCAVATION
 1-800-892-0123

CONTRACT NO. 64B34

STATE OF ILLINOIS
 DEPARTMENT OF TRANSPORTATION
 DIVISION OF HIGHWAYS

SUBMITTED April 6, 2006
Gregory R. Mountain
 DEPUTY DIRECTOR OF HIGHWAYS, REGION ENGINEER

May 12, 2006
Mike Stone
 ENGINEER OF DESIGN AND ENVIRONMENT

May 12, 2006
Melton L. Sees, P.E.
 DIRECTOR OF HIGHWAYS, CHIEF ENGINEER

**PRINTED BY THE AUTHORITY
 OF THE STATE OF ILLINOIS**

F.A.U. RTE.	SECTION	COUNTY	TOTAL SHEETS	SHEET NO.
5839	116TS	ROCK ISLAND	9	2
STA.		TO STA.		
FED. ROAD DIST. NO.	ILLINOIS	FED. AID PROJECT		

URBAN
90% FED.
10% STATE
Y031-IF

Summary of Quantities for US 6 @ IL 150			
PAY CODE	ITEM	UNIT	TOTAL
X0325339	CONDUIT INSTALLED, 1 1/2", NON-METALLIC	FOOT	767
67100100	MOBILIZATION	L SUM	1
70100450	TRAFFIC CONTROL AND PROTECTION, STANDARD 701201	L SUM	1
70102635	TRAFFIC CONTROL AND PROTECTION, STANDARD 701701	L SUM	1
* 78000100	THERMOPLASTIC PAVEMENT MARKING - LETTERS AND SYMBOLS	SQ FT	12
* 78000200	THERMOPLASTIC PAVEMENT MARKING - LINE 4"	FOOT	586
* 78000400	THERMOPLASTIC PAVEMENT MARKING - LINE 6"	FOOT	186
* 78000500	THERMOPLASTIC PAVEMENT MARKING - LINE 8"	FOOT	300
* 78000600	THERMOPLASTIC PAVEMENT MARKING - LINE 12"	FOOT	158
* 78000650	THERMOPLASTIC PAVEMENT MARKING - LINE 24"	FOOT	147
78300100	PAVEMENT MARKING REMOVAL	SQ FT	300
80501000	SERVICE INSTALLATION, (SPECIAL)	EACH	1
81400400	CONCRETE HANDHOLE	EACH	4
81400500	HEAVY-DUTY CONCRETE HANDHOLE	EACH	2
81400600	CONCRETE DOUBLE HANDHOLE	EACH	1
81702110	ELECTRIC CABLE IN CONDUIT, 600V (XLP TYPE USE) I/C No 10	FOOT	669
85000300	MAINTENANCE OF EXISTING TRAFFIC SIGNAL INSTALLATION	L SUM	1
85700200	FULL-ACTUATED CONTROLLER AND TYPE IV CABINET	EACH	1
87301215	ELECTRIC CABLE IN CONDUIT, SIGNAL, NO. 14 2C	FOOT	252
87301225	ELECTRIC CABLE IN CONDUIT, SIGNAL, NO. 14 3C	FOOT	252
87301245	ELECTRIC CABLE IN CONDUIT, SIGNAL, NO. 14 5C	FOOT	1002
87301255	ELECTRIC CABLE IN CONDUIT, SIGNAL, NO. 14 7C	FOOT	1020
87301705	ELECTRIC CABLE IN CONDUIT, LEAD IN, No. 18 3PR	FOOT	1842
87301815	ELECTRIC CABLE IN CONDUIT, SERVICE, NO 6 3C	FOOT	91
87502470	TRAFFIC SIGNAL POST GALVANIZED STEEL 13 FT	EACH	2
87800100	CONCRETE FOUNDATION, TYPE A	FOOT	6
87800200	CONCRETE FOUNDATION, TYPE D	FOOT	3
87900200	DRILL EXISTING HANDHOLE	EACH	7
88500500	INDUCTIVE LOOP DETECTOR AMPLIFIER	EACH	7
88600100	DETECTOR LOOP, TYPE I	FOOT	307
89502380	REMOVE EXISTING HANDHOLE	EACH	1
X0324885	CONDUIT INSTALLED, 1", NON-METALLIC	FOOT	50
X0324887	CONDUIT INSTALLED, 2 1/2", NON-METALLIC	FOOT	126
X0324888	CONDUIT INSTALLED, 4", NON-METALLIC	FOOT	346
* X0656300	PAVEMENT REMOVAL AND REPLACEMENT	SQ YD	3
* X4402810	ISLAND PAVEMENT REMOVAL AND REPLACEMENT	SQ FT	77
X8801395	SIGNAL HEAD, POLYCARBONATE, LED, 1-FACE, 5-SECTION, BRACKET MOUNTED	EACH	2
X8810395	PEDESTRIAN SIGNAL HEAD, POLYCARBONATE, LED, 1 FACE BRACKET MOUNTED	EACH	2
XX004921	PEDESTRIAN PUSHBUTTON, SPECIAL	EACH	2
XX005703	REMOVE EXISTING TRAFFIC SIGNAL EQUIPMENT, SPECIAL	L SUM	1

* SPECIALTY ITEM

PLT DATE = Thu Apr 05 10:56:51 2006
FILE NAME = P:\P\64B34\64B34 US6.150\plan 64B34 us 6.150.dgn
PLOT SCALE = 20.0000" / IN.
USER NAME = N1111

REVISIONS		ILLINOIS DEPARTMENT OF TRANSPORTATION
NAME	DATE	
		SCALE: VERT. HORIZ. DATE
DRAWN BY		CHECKED BY

F.A.U. RTE.	SECTION	COUNTY	TOTAL SHEETS	SHEET NO.
5839	116TS	ROCK ISLAND	9	3
STA.		TO STA.		
FED. ROAD DIST. NO.		ILLINOIS	FED. AID PROJECT	

NOTE:













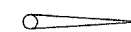



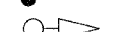



1. NO WORK SHALL BE ALLOWED UNTIL ALL COMPONENTS NECESSARY TO COMPLETE THE PROJECT HAVE ARRIVED ON THE JOB SITE.

2. THE FOLLOWING EXISTING TRAFFIC SIGNAL EQUIPMENT SHALL BE REMOVED BY THE CONTRACTOR AND DELIVERED TO THE CITY OF MOLINE;
 1 EACH CONTROLLER AND CONTROLLER CABINET
 ALL OTHER ITEMS; FOUNDATIONS, ELECTRIC CABLE, SERVICE INSTALLATION, PEDESTRIAN SIGNAL HEAD, PEDESTRIAN PUSH BUTTON AND ANY OTHER MISC. EQUIPMENT SHALL BE REMOVED BY THE CONTRACTOR AND RETAINED BY HIM/HER FOR SALVAGE VALUE AND PAY FOR AS REMOVE EXISTING TRAFFIC SIGNAL EQUIPMENT, SPECIAL, LUMP SUM.

3. THE CONTRACTOR SHALL BE RESPONSIBLE FOR PROTECTING UTILITY PROPERTY DURING CONSTRUCTION OPERATIONS AS OUTLINED IN ARTICLE 107.31 OF THE STANDARD SPECIFICATIONS. A MINIMUM OF 48 HOURS ADVANCE NOTICE IS REQUIRED FOR NON-EMERGENCY WORK. THE J.U.L.I.E NUMBER IS 800-892-0123. THE FOLLOWING LISTED UTILITIES ARE LOCATED NEAR OR WITHIN THE PROJECT.

UTILITIES			
NAME	TYPE	TELEPHONE	JULIE MEMBER
MR JEREMY SCHNACK SBC/AMERITECH TELEPHONE CO. 635 - 18TH STREET ROCK ISLAND, IL 61201	TELEPHONE	309-793-4456	YES 803-892-0123
MR JEFF THOMAS MIDAMERICAN ENERGY COMPANY 2811 5TH AVE ROCK ISLAND, IL 61201	ELECTRIC	309-793-3763	YES 800-892-0123
MR SCOTT BULL MIDAMERICAN ENERGY COMPANY 2811 5TH AVE ROCK ISLAND, IL 61201	GAS	309-793-3870	YES 800-892-0123
MR JOHN BROWNING CITY OF MOLINE 619 - 16TH STREET MOLINE, IL 61265	WATER & SEWER	309-736-5797	YES 800-892-0123

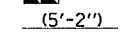
LEGEND

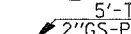
-  EXISTING CONTROLLER
 -  NEW CONTROLLER
 -  EXISTING ALUMINUM MAST ARM ASSEMBLY AND POLE
 -  NEW ALUMINUM MAST ARM ASSEMBLY AND POLE
 -  EXISTING STEEL MAST ARM ASSEMBLY AND POLE
 -  NEW STEEL MAST ARM ASSEMBLY AND POLE
 -  EXISTING SIGNAL HEAD AND POST
 -  NEW SIGNAL HEAD AND POST
 -  EXISTING SIGNAL HEAD
 -  NEW SIGNAL HEAD WITH BACKPLATE
 -  EXISTING PEDESTRIAN HEAD
 -  NEW PEDESTRIAN HEAD
 -  PEDESTRIAN PUSHBUTTON
 -  EXISTING HANDHOLE
 -  NEW HANDHOLE
 -  NEW JUNCTION BOX
 -  NEW HEAVY-DUTY HANDHOLE
 -  NEW DOUBLE HANDHOLE
 -  EXISTING CONDUIT (LENGTH AND SIZE)
 -  NEW LUMINAIRE
 -  NEW GALVANIZED STEEL OR PVC CONDUIT
- UPPER NUMERAL INDICATES LENGTH
 "T" INDICATES CONDUIT IN TRENCH
 "P" INDICATES CONDUIT PUSHED
 LOWER NUMERAL INDICATES SIZE AND TYPE

PLDT DATE = Thu Apr 06 13:53:13 2006
 FILE NAME = P:\Projects\64B34\ISS\156\plan 64B34 us 6.156.dgn
 PLOT SCALE = 20/1000 = 1/50
 USER NAME = RL111

REVISIONS		ILLINOIS DEPARTMENT OF TRANSPORTATION
NAME	DATE	
		SCALE: VERT. HORIZ. DATE
DRAWN BY		CHECKED BY

F.A.U. RTE.	SECTION	COUNTY	TOTAL SHEETS	SHEET NO.
5839	116TS	ROCK ISLAND	9	4
STA.		TO STA.		
FED. ROAD DIST. NO.		ILLINOIS	FED. AID PROJECT	

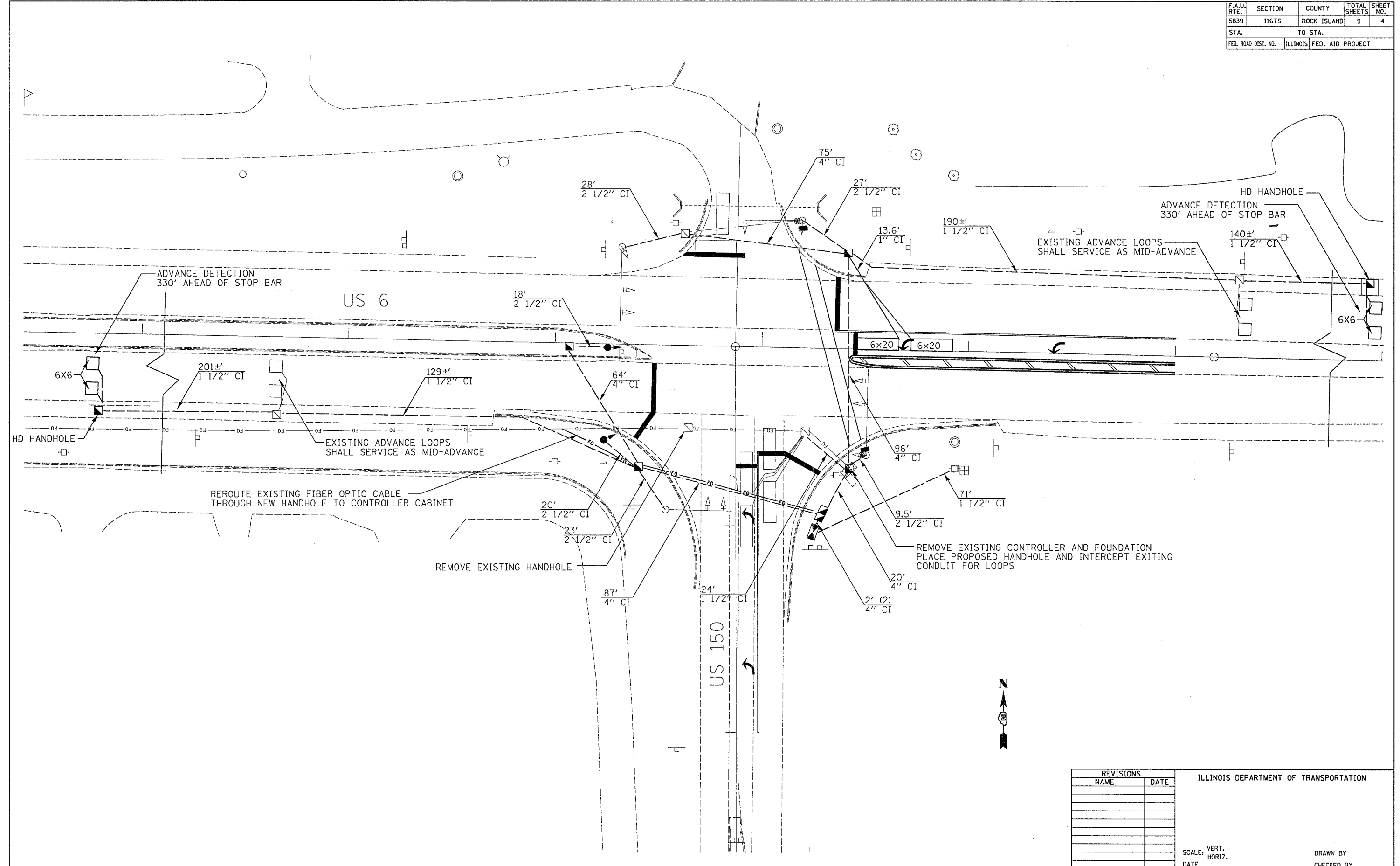

PLOT DATE = Thu 06 13 2008 10:28:01
 FILE NAME = P:\P\64B34\64B34 US6.150\plan 64b34 in 6.150.dgn
 PLOT SCALE = 26.0000 1/4 IN.
 USER NAME = HJH

REVISIONS	
NAME	DATE

ILLINOIS DEPARTMENT OF TRANSPORTATION

SCALE: VERT. _____
 HORIZ. _____

DATE _____ DRAWN BY _____
 CHECKED BY _____

F.A.U. RTE.	SECTION	COUNTY	TOTAL SHEETS	SHEET NO.
5839	116TS	ROCK ISLAND	9	5
STA.		TO STA.		
FED. ROAD DIST. NO.	ILLINOIS	FED. AID PROJECT		

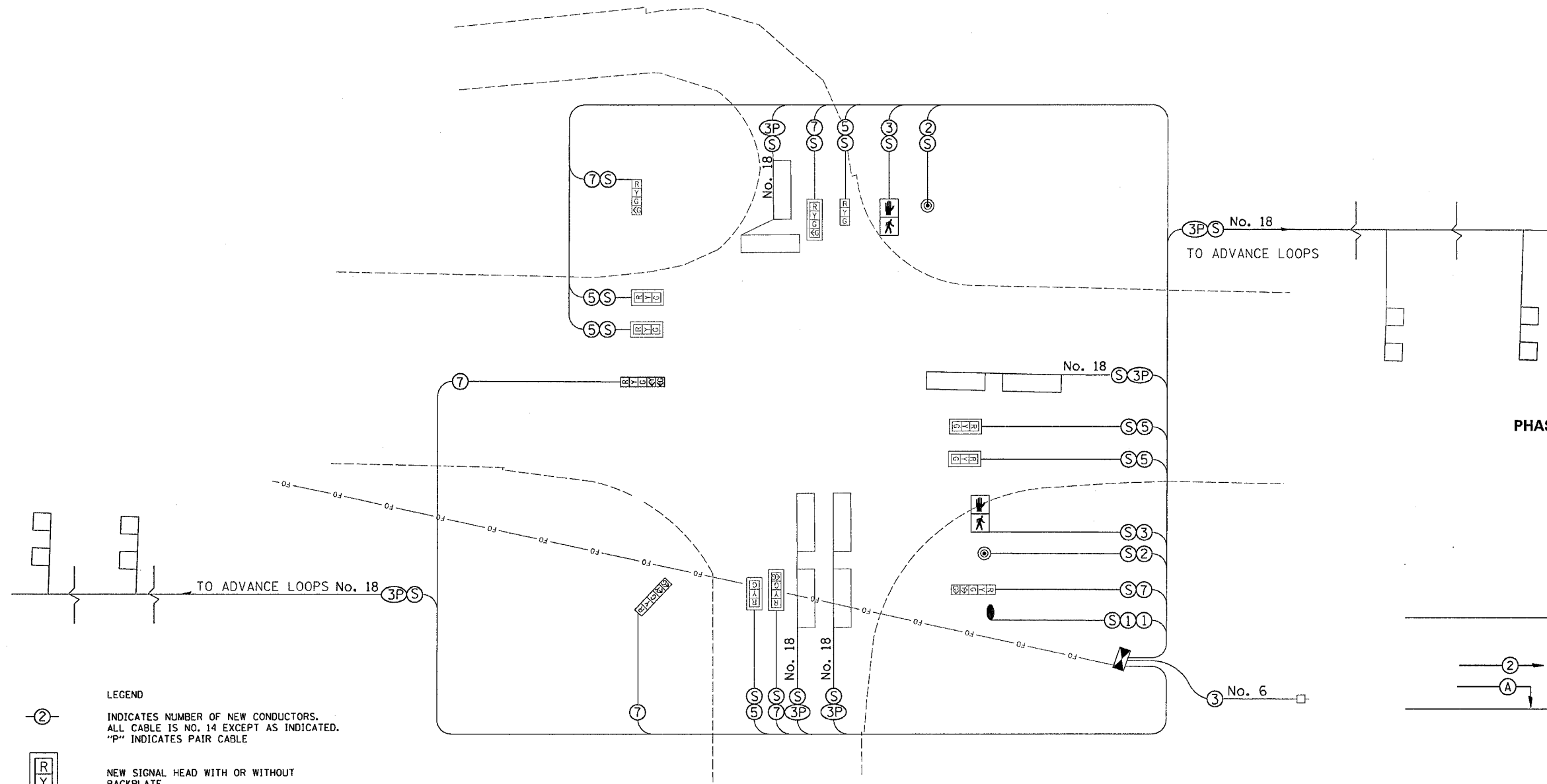

PHASE DESIGNATION DIAGRAM

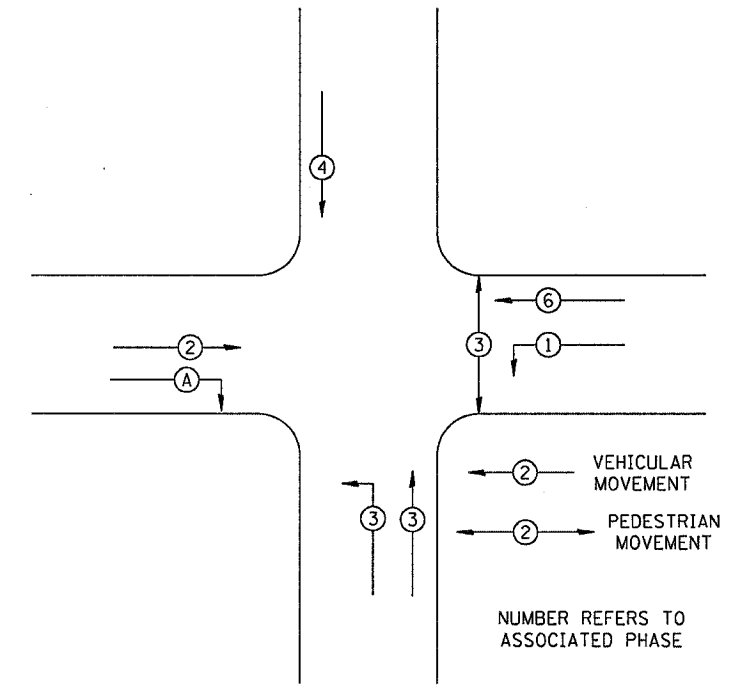

REFER TO STANDARD 857001

LEGEND

- ② INDICATES NUMBER OF NEW CONDUCTORS. ALL CABLE IS NO. 14 EXCEPT AS INDICATED. "P" INDICATES PAIR CABLE
- NEW SIGNAL HEAD WITH OR WITHOUT BACKPLATE
- NEW PEDESTRIAN HEAD - LED
- PEDESTRIAN PUSHBUTTON
- INDICATES SPLICE AT FOUNDATION OR HANDHOLE

DETECTOR ASSIGNMENT		
DETECTOR	PHASE NO.	DIRECTION
A	4	SB PRESENT
B	3	NB PRESENT
C	6	WB FAR ADVANCE
D	6	WB MID ADVANCE
E	1	WB LEFT
F	2	EB FAR ADVANCE
G	2	EB MID ADVANCE

REVISIONS		ILLINOIS DEPARTMENT OF TRANSPORTATION
NAME	DATE	
		SCALE: VERT. HORIZ. DATE DRAWN BY CHECKED BY

F.A.U. RTE.	SECTION	COUNTY	TOTAL SHEETS	SHEET NO.
5839	116TS	ROCK ISLAND	9	6
STA.		TO STA.		
FED. ROAD DIST. NO.	ILLINOIS	FED. AID PROJECT		

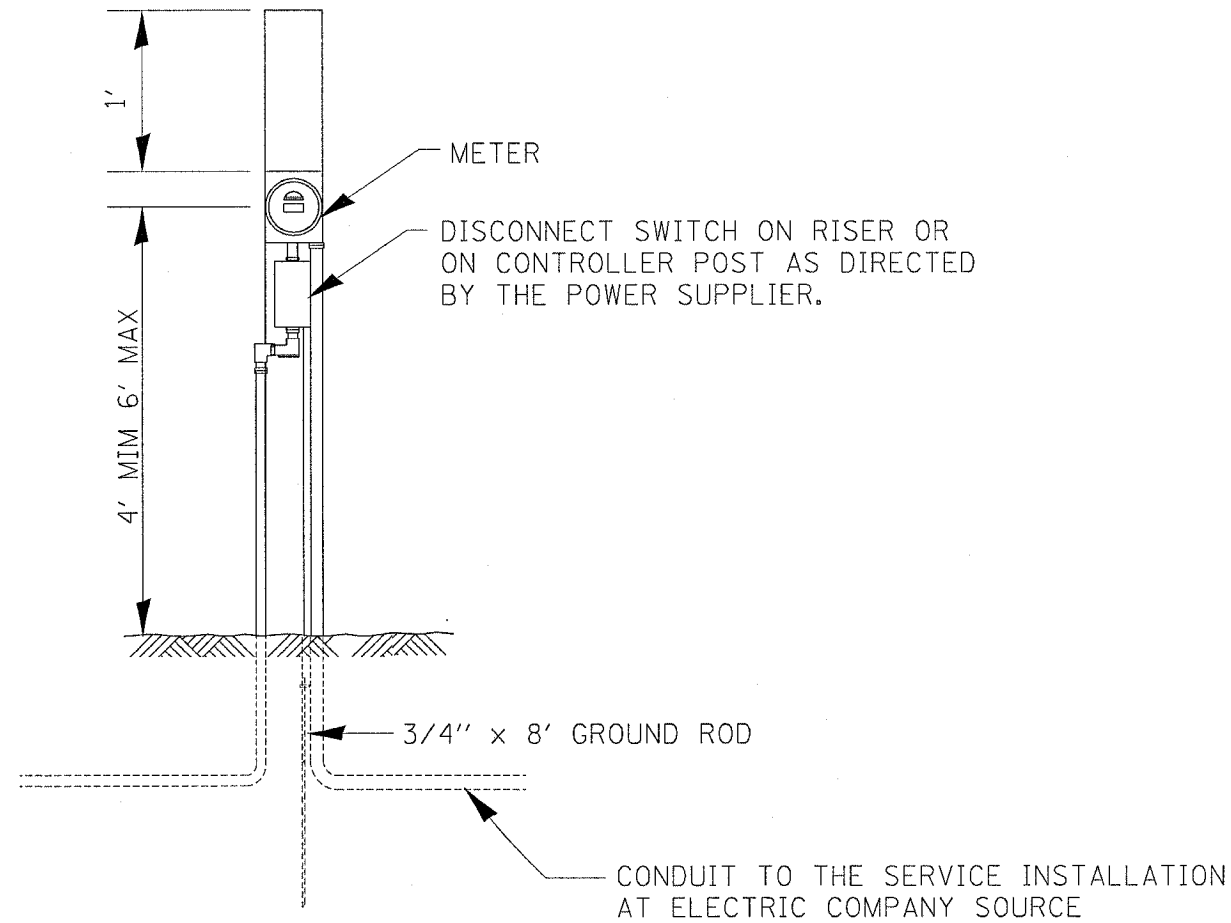

ELECTRIC SERVICE INSTALLATION, SPECIAL
 (SEE SPECIAL PROVISIONS)
 (DETAIL ONLY SHOW GENERAL SERVICE
 WHICH VARIES BY PROVIDERS)

PLOT DATE = Thu Apr 06 13:05:02 2006
 FILE NAME = P:\P\05\116TS\116TS116TS.dwg
 PLOT SCALE = 28.0000 / IN.
 USER NAME = h111k1

REVISIONS		ILLINOIS DEPARTMENT OF TRANSPORTATION
NAME	DATE	
		SCALE: VERT. HORIZ. DATE
DRAWN BY		CHECKED BY

F.A.U. RTE.	SECTION	COUNTY	TOTAL SHEETS	SHEET NO.
5B39	1167S	ROCK ISLAND	9	7
STA.		TO STA.		
FED. ROAD DIST. NO.	ILLINOIS	FED. AID PROJECT		

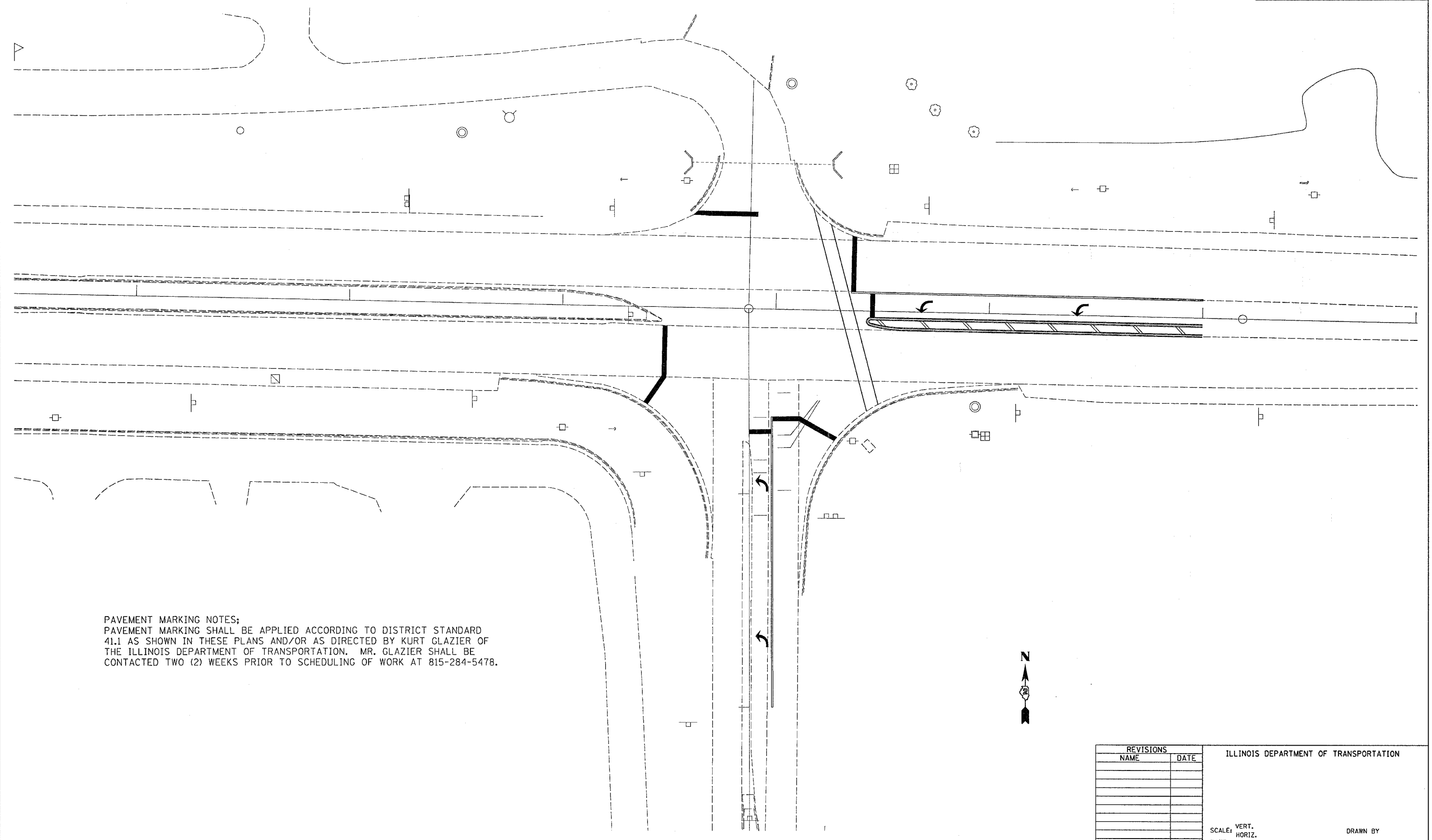

PAVEMENT MARKING NOTES;
 PAVEMENT MARKING SHALL BE APPLIED ACCORDING TO DISTRICT STANDARD 41.1 AS SHOWN IN THESE PLANS AND/OR AS DIRECTED BY KURT GLAZIER OF THE ILLINOIS DEPARTMENT OF TRANSPORTATION. MR. GLAZIER SHALL BE CONTACTED TWO (2) WEEKS PRIOR TO SCHEDULING OF WORK AT 815-284-5478.

PLOT DATE = Thu Apr 05 13:06:02 2006
 FILE NAME = P:\Projects\64B34 US6-156\plan 64b34 us 6.156.dgn
 PLOT SCALE = 20.0000 / IN.
 USER NAME = H11K1

REVISIONS	
NAME	DATE

ILLINOIS DEPARTMENT OF TRANSPORTATION

SCALE: VERT. _____
 HORIZ. _____
 DATE _____

DRAWN BY _____
 CHECKED BY _____

F.A. U. RTE.	SECTION	COUNTY	TOTAL SHEETS	SHEET NO.
5839	116TS	ROCK ISLAND	9	9
STA.		TO STA.		
FED. ROAD DIST. NO.		ILLINOIS	FED. AID PROJECT	

TYPICAL PAVEMENT MARKINGS

TYPICAL PAVEMENT MARKING FOR FLUSH MEDIAN

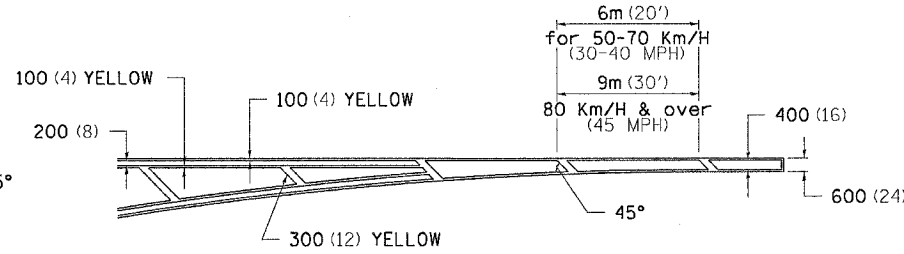
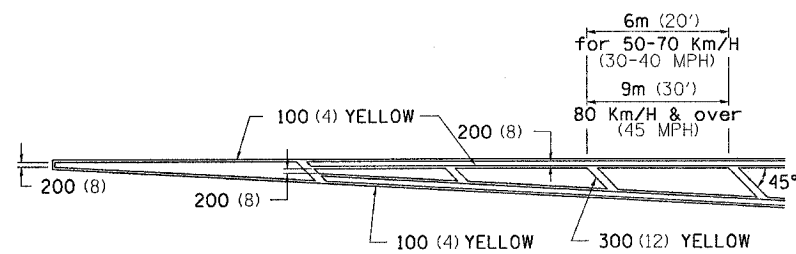

MEDIAN PAVEMENT MARKING

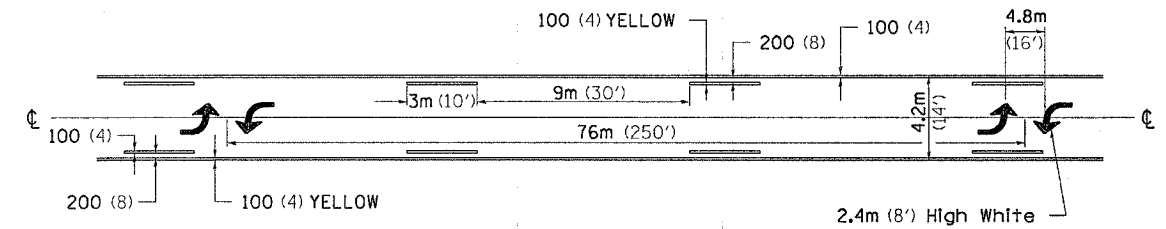

TYPICAL ISLAND OFFSET SHOULDER WIDTH

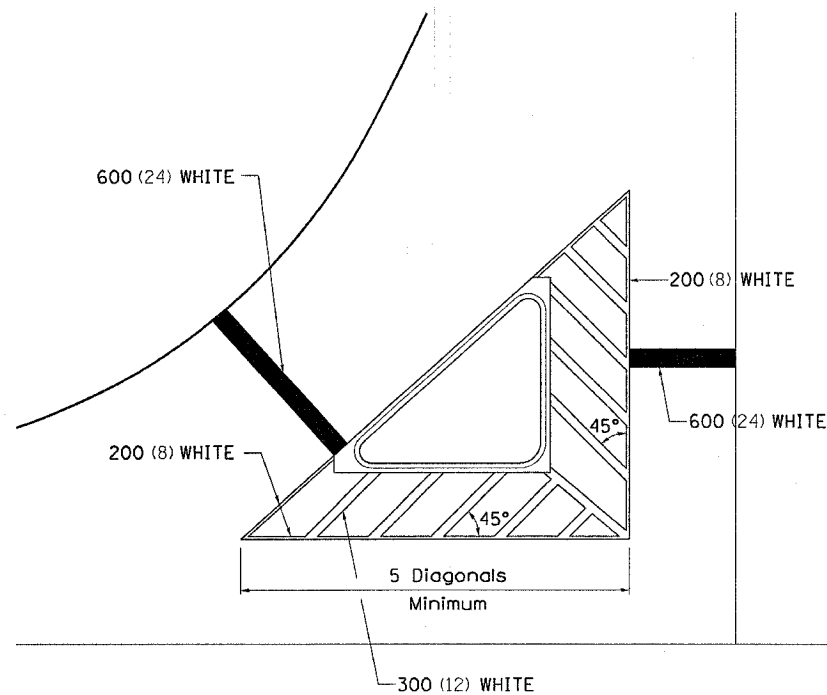

TYPICAL PARKING SPACING

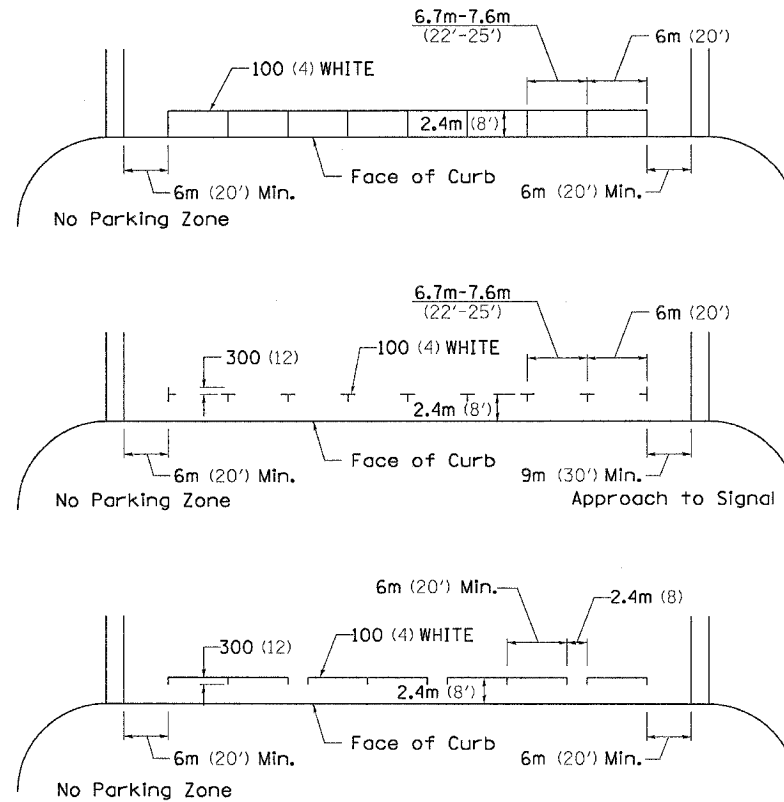

•• ALL DIMENSIONS ARE IN MILLIMETERS (INCHES) UNLESS OTHERWISE NOTED.

STANDARD CROSSWALK MARKING

See Schedules for Locations

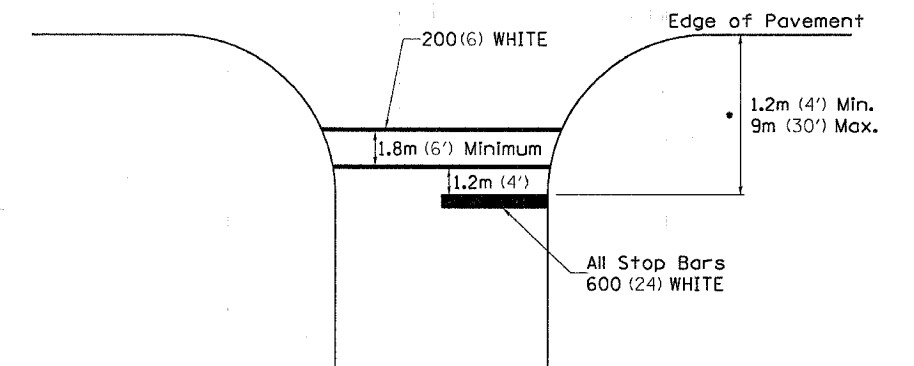

• Distance to the nearest edge of the intersecting roadway in the absence of a marked crosswalk.

PLOT DATE = Thu Apr 06 13:05:22 2006
 FILE NAME = P:\Projects\64B34\US61100\plan 64B34.us 6.156.dgn
 PLOT SCALE = 20.00000 / IN.
 REFERENCE = #REF#

F.A.L. RTE.	SECTION	COUNTY	TOTAL SHEETS	SHEET NO.
5839	116TS	ROCK ISLAND	9	9
STA.		TO STA.		
FED. ROAD DIST. NO.		ILLINOIS		FED. AID PROJECT

TYPICAL PAVEMENT MARKINGS

ARROW LAYOUT

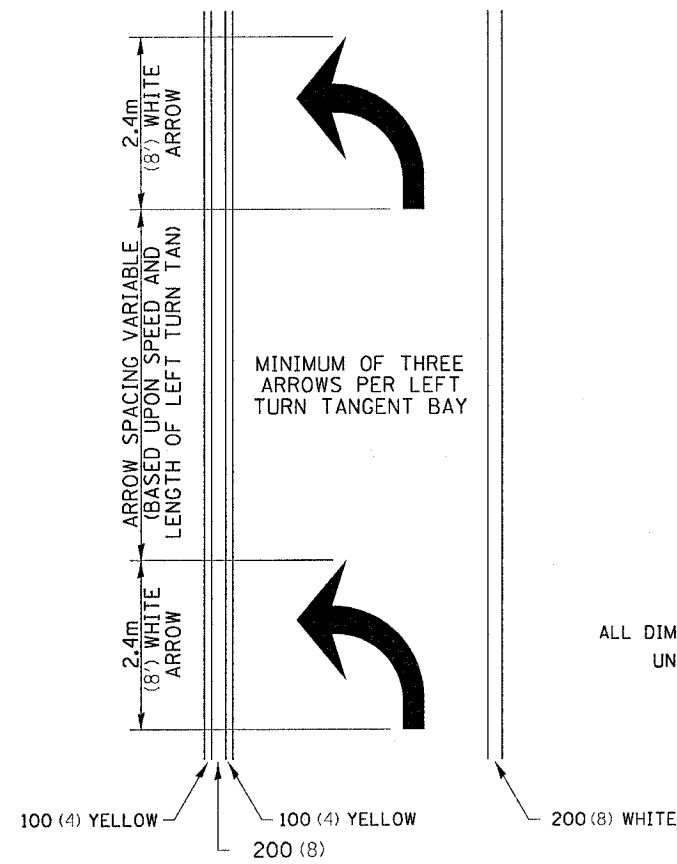

- ◀ ONE-WAY AMBER MARKER
- ◁ ONE-WAY CRYSTAL MARKER
- ◆ TWO-WAY AMBER MARKER

ALL DIMENSIONS ARE IN MILLIMETERS (INCHES) UNLESS OTHERWISE NOTED.

TYPICAL PAVEMENT MARKING FOR FLUSH MEDIAN

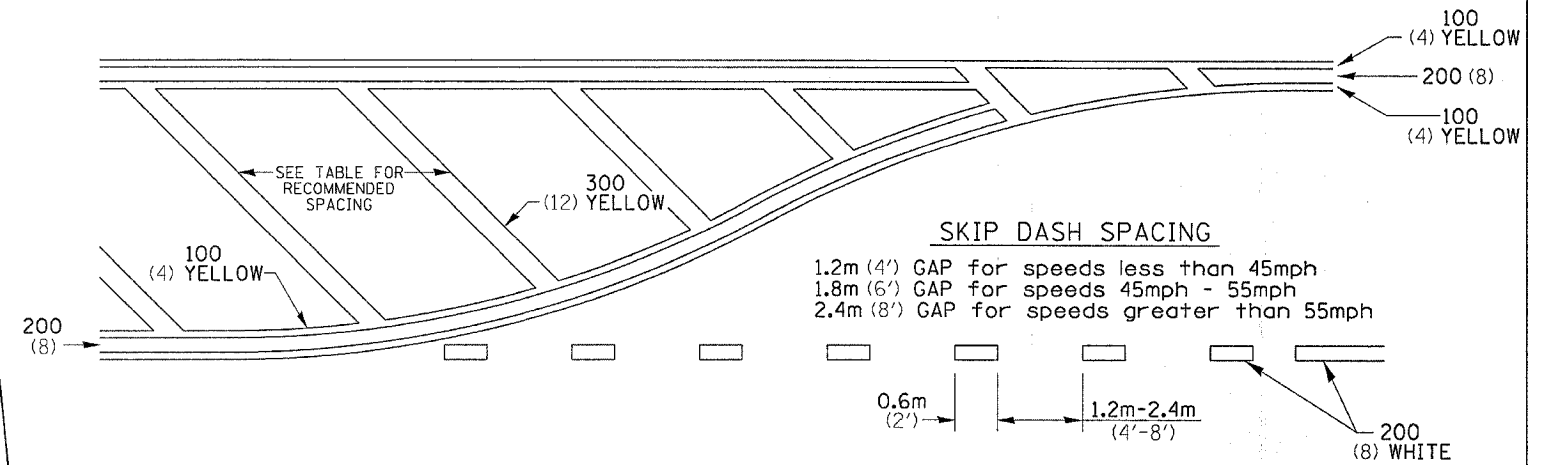

RECOMMENDED SPACING BETWEEN DIAGONALS (IN FEET)

Speed Limit Range	Continuous Median Area	Intersection Channelization	Objects (Islands)
less than 50Km/H (30MPH)	15.3m (50')	4.53m (15')	3.05m (10')
50-60Km/H (30-40MPH)	22.9m (75')	6.1m (20')	4.53m (15')
70Km/H (45MPH) & over	22.9m (75')	9.05m (30')	6.1m (20')

NOTE: if the spacing recommended in the Table does not permit at least five diagonal lines in the area being marked, the spacing from the next lowest speed range should be used. The recommended spacing is measured parallel to the pavement center line.

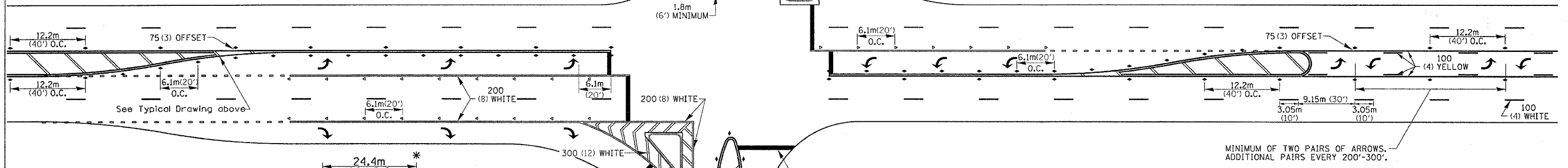

TYPICAL PAVEMENT MARKING FOR TWO LANE SECTION - NO PASSING ZONES

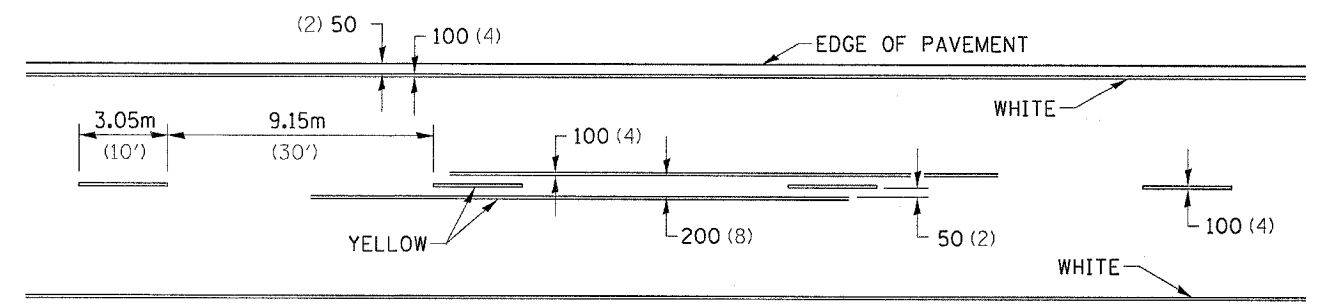

PLOT DATE = Thu Apr 06 13:06:03 2006
 FILE NAME = P:\Projects\64B34 US&L\64B34.dgn
 PLOT SCALE = 20:0000 / IN.
 REFERENCE = BREF

- * REDUCE TO 12.2m (40') O.C. ON CURVES WHERE ADVISORY SPEEDS ARE 15Km/H (10MPH) LOWER THAN POSTED SPEEDS.
- ** USE DOUBLE MARKERS WHEN ADT ≥ 25,000

MULTI-LANE / UNDIVIDED