

F.A.S. SECTION COUNTY TOTAL SHEETS SHEET NO.
1517(2)RS-3 (3)RS-4 MCLEAN 223 54
STA. _____ TO STA. _____
FED. ROAD DIST. NO. ILLINOIS FED. AID PROJECT

66383

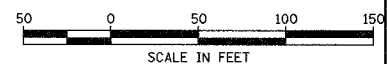

PI STA. = 624+31.63
 $\Delta = 6^\circ 13' 35''$ (LT)
 $D = 0^\circ 36' 09''$
 $R = 9,508.92'$
 $T = 517.17'$
 $L = 1,033.32'$
 $E = 14.05'$
 $e = 1.5\%$
 $T.R. = 37'$
 $S.E. RUN = 37'$
 $P.C. STA. = 619+14.46$
 $P.T. STA. = 629+47.78$

PIPE CULVERTS,
 CLASS D, TYPE 18"
 46 LIN FT @ 1.05%
 (REMOVE EX. CULVERT)
 STA. 620+33, 30' LT
 END SECTION 18"
 INV. = 808.65

BETTY J. BRENT &
 ALAN C. BRENT

DATE	BY	REVISION

DATE	BY	REVISION

COMPANY NAME: COMPANY NAME
 PROJECT CONTACT: PROJECT CONTACT
 CLIENT: CLIENT
 DATE: DATE
 BY: BY

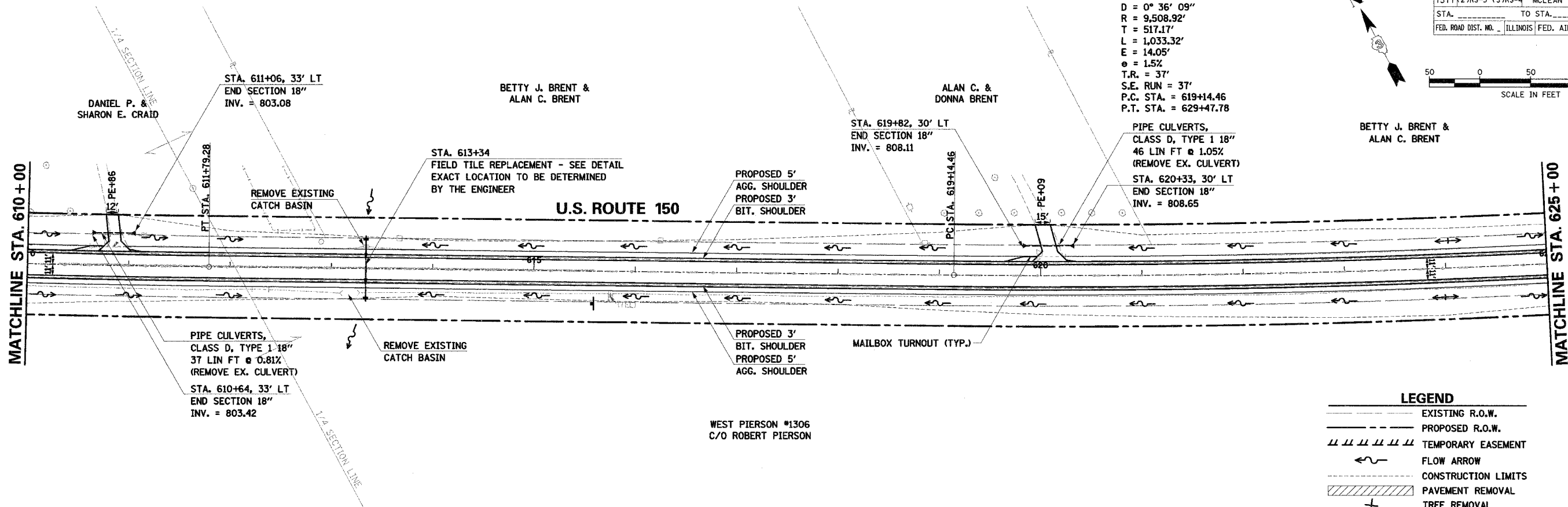

LEGEND

	EXISTING R.O.W.
	PROPOSED R.O.W.
	TEMPORARY EASEMENT
	FLOW ARROW
	CONSTRUCTION LIMITS
	PAVEMENT REMOVAL
	TREE REMOVAL

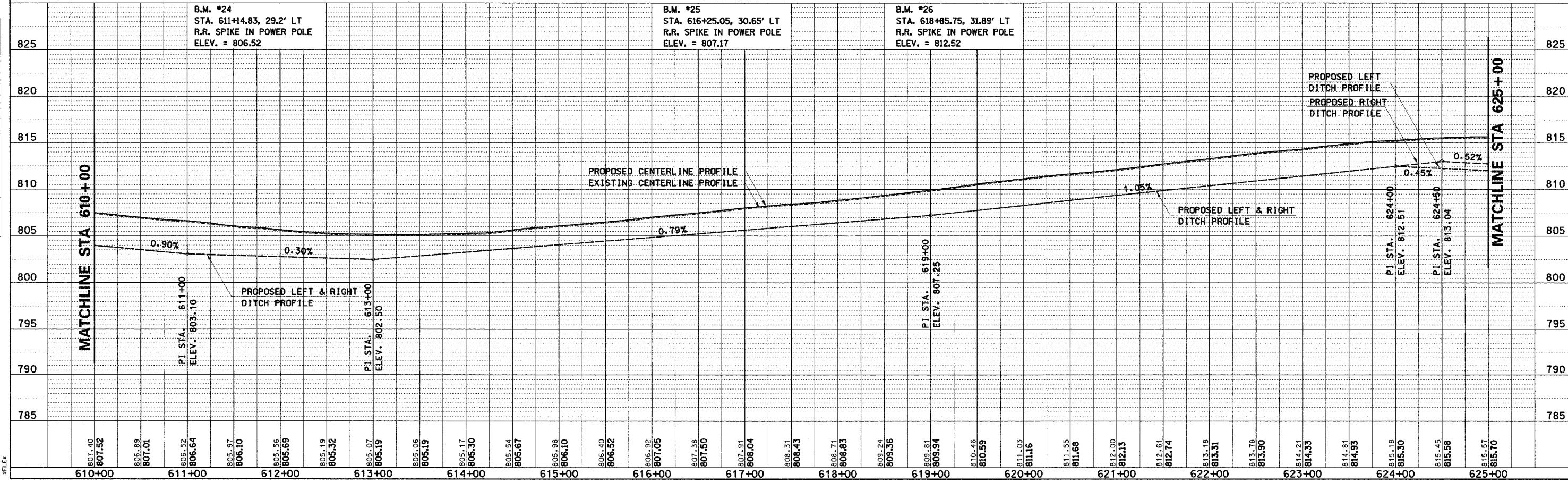

U.S. ROUTE 150 STA. 610+00 TO STA. 625+00 - PLAN AND PROFILE