

F.A.S. RTE. 1517 (2)RS-3 (3)RS-4	SECTION MCLEAN	COUNTY MCLEAN	TOTAL SHEETS 223	SHEET NO. 59
STA. _____ TO STA. _____		ILLINOIS FED. AID PROJECT		

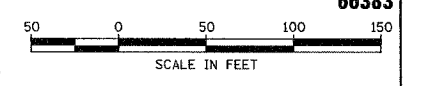

66383

DATE	BY
DATE	BY

DATE	BY
DATE	BY

COMPANY NAME: COMPANY NAME  
 PROJECT CONTACT: PROJECT CONTACT  
 CLIENT: CLIENT  
 DATE: DATE  
 FILE: FILE

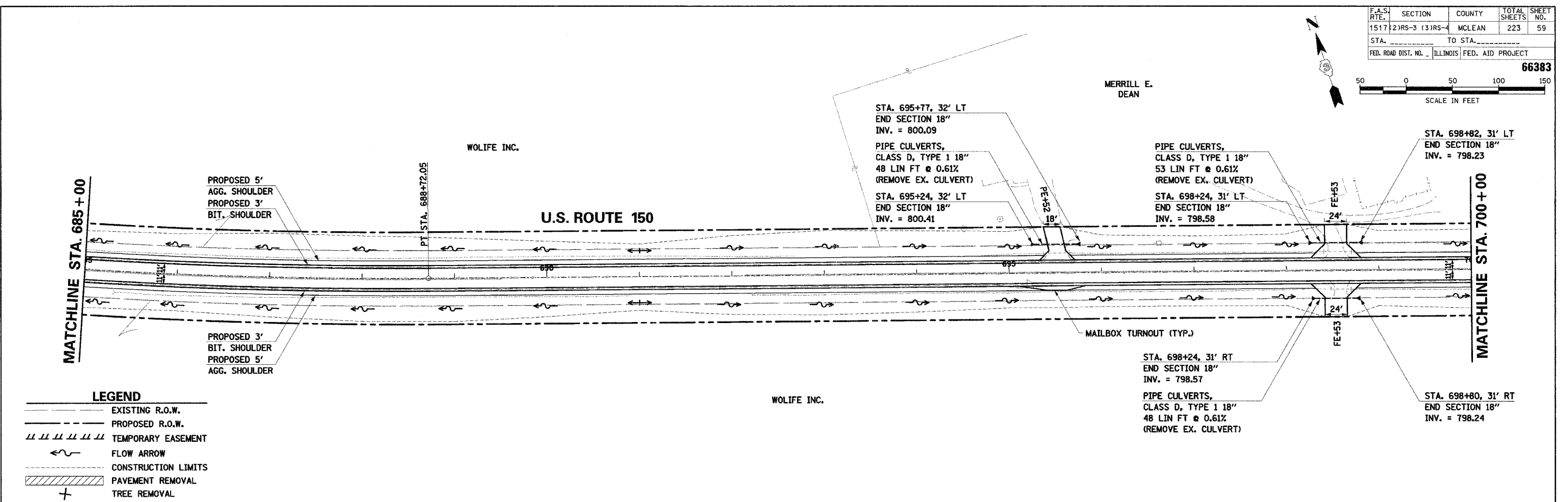

**LEGEND**

- EXISTING R.O.W.
- - - PROPOSED R.O.W.
- /// TEMPORARY EASEMENT
- FLOW ARROW
- - - CONSTRUCTION LIMITS
- ▨ PAVEMENT REMOVAL
- + TREE REMOVAL

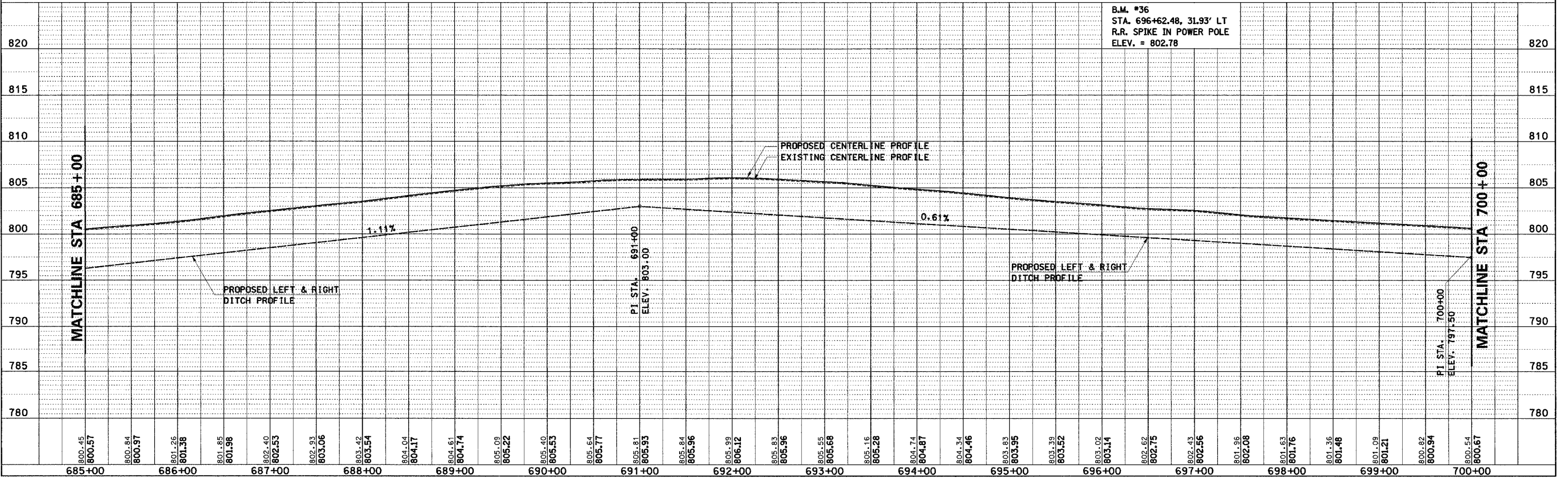

U.S. ROUTE 150 STA. 685+00 TO STA. 700+00 - PLAN AND PROFILE