

F.A.S. RTE.	SECTION	COUNTY	TOTAL SHEETS	SHEET NO.
1517 (2)RS-3 (3)RS-4	MCLEAN		223	60
STA.	TO STA.			
FED. ROAD DIST. NO.	ILLINOIS FED. AID PROJECT			

66383

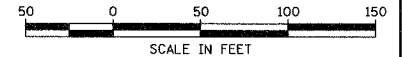

DATE	BY
DATE	BY
DATE	BY

DATE	BY
DATE	BY
DATE	BY

COMPANY NAME: #COMPANY NAME#
 PROJECT CONTACT: #PROJECT CONTACT#
 CLIENT: #CLIENT#
 DATE: #DATE#
 BY: #BY#

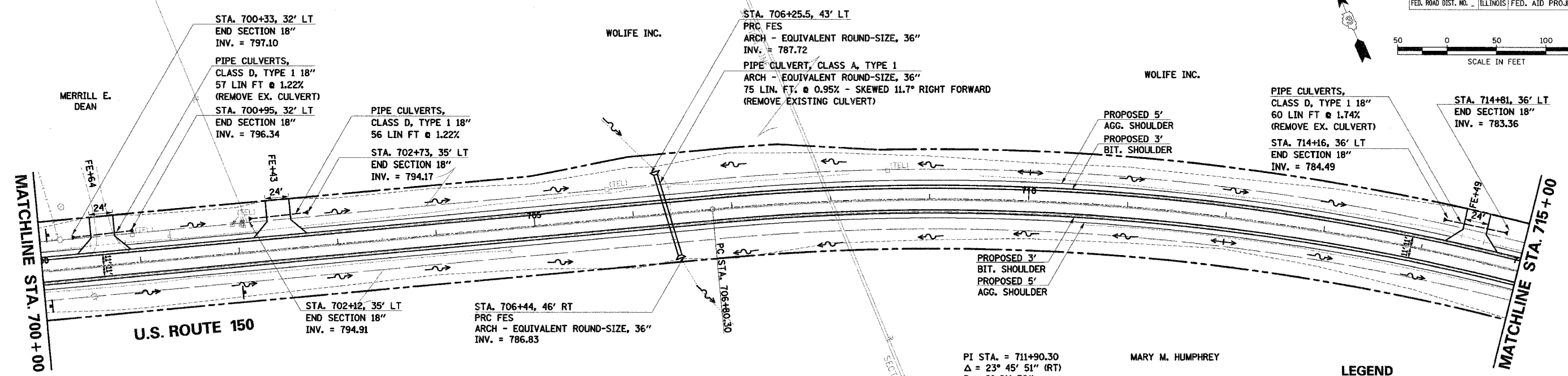

PI STA. = 711+90.30
 $\Delta = 23^\circ 45' 51''$ (RT)
 $D = 2^\circ 21' 50''$
 $R = 2,423.90'$
 $T = 510.00'$
 $L = 1,005.34'$
 $E = 53.07'$
 $e = 3.6\%$
 $T.R. = 37'$
 $S.E. RUN = 88'$
 $P.C. STA. = 706+80.30$
 $P.T. STA. = 716+85.64$

MARY M. HUMPHREY

LEGEND

	EXISTING R.O.W.
	PROPOSED R.O.W.
	TEMPORARY EASEMENT
	FLOW ARROW
	CONSTRUCTION LIMITS
	PAVEMENT REMOVAL
	TREE REMOVAL

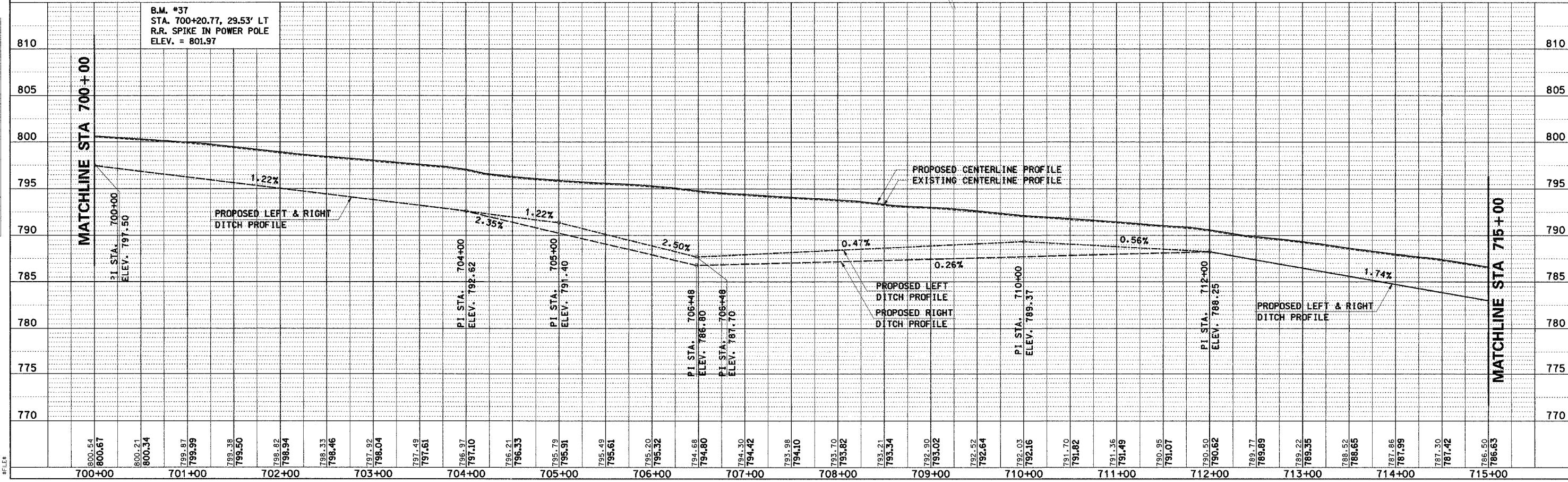

U.S. ROUTE 150 STA. 700+00 TO STA. 715+00 - PLAN AND PROFILE