

F.A.S. RTE.	SECTION	COUNTY	TOTAL SHEETS	SHEET NO.
1517 (2)RS-3 (3)RS-4		MCLEAN	223	67
STA.	TO STA.			
FED. ROAD DIST. NO. - ILLINOIS FED. AID PROJECT				

66383

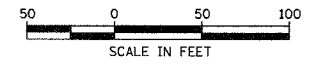

WASHINGTON STREET
 PI STA. = 1502+00.64
 $\Delta = 43^\circ 26' 26''$ (LT)
 $D = 114^\circ 35' 30''$
 $R = 50.00'$
 $T = 19.92'$
 $L = 37.91'$
 $E = 3.82'$
 $\theta =$
 $T.R. =$
 $S.E. RUN =$
 $P.C. STA. = 1501+80.72$
 $P.T. STA. = 1502+18.63$

COMBINATION CONC. CURB & GUTTER, TYPE B6.24

NOTE:
 AREA BEHIND CURB IN THE NORTHWEST CORNER OF THE WASHINGTON STREET INTERSECTION SHALL BE GRADED TO ENSURE DRAINAGE TOWARDS THE INLET LOCATED AT U.S. ROUTE 150 STA. 437+00, 22.5' RT.

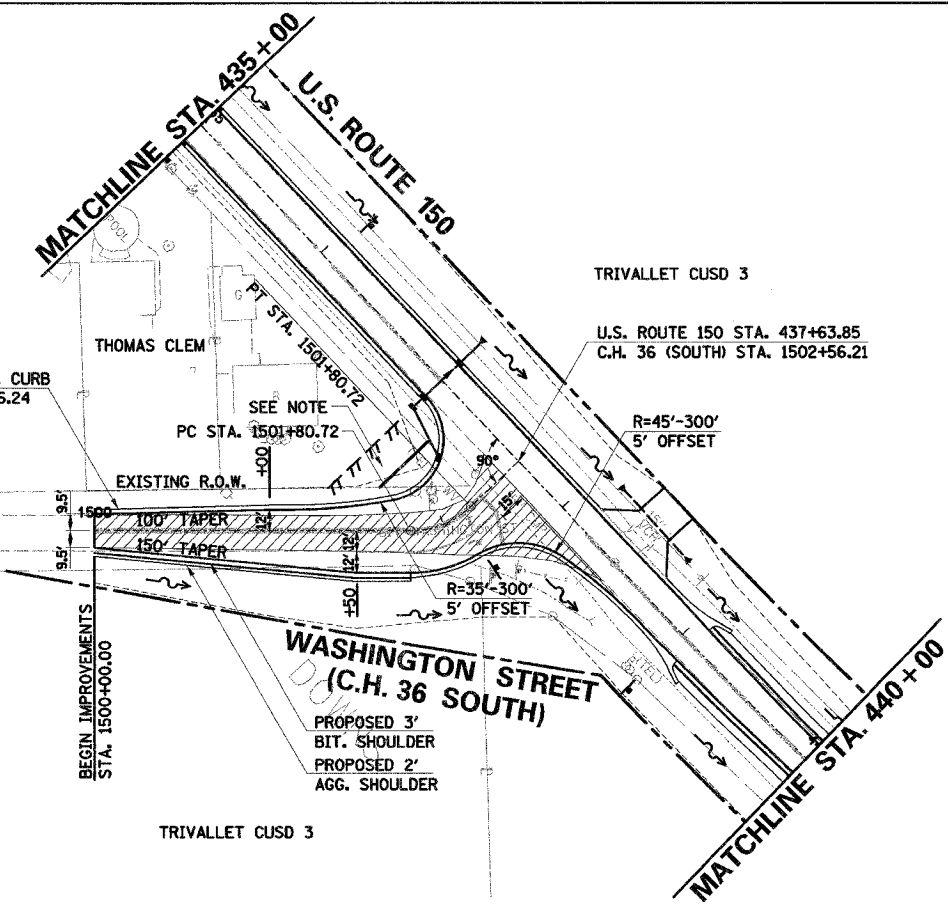

LEGEND

- EXISTING R.O.W.
- - - PROPOSED R.O.W.
- /// TEMPORARY EASEMENT
- ← FLOW ARROW
- - - CONSTRUCTION LIMITS
- ▨ PAVEMENT REMOVAL
- + TREE REMOVAL

DATE	BY	REVISION

DATE	BY	REVISION

COMPANY NAME: #COMPANY/NAME#
 PROJECT CONTACT: #PROJECT_CONTACT#
 CLIENT: #CLIENT#
 #DATE# #TIME#
 #PLOT#

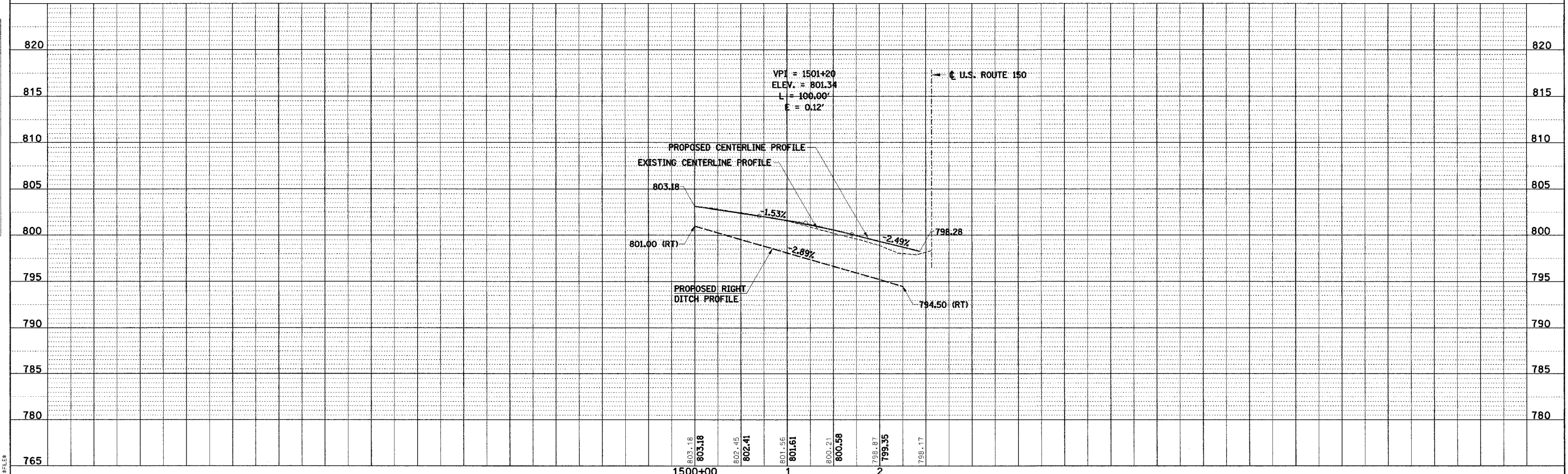

WASHINGTON STREET (C.H. 36 SOUTH) STA. 1500+00 TO STA. 1502+56.21 - PLAN AND PROFILE