

F.A. RTE.	SECTION	COUNTY	TOTAL SHEETS	SHEET NO.
(22) N & TS-3	MARSHALL		21	12
STA. _____ TO STA. _____		FED. ROAD DIST. NO. _____ ILLINOIS FED. AID PROJECT		
* FAP 649 (IL 17) & FAS 2370 (IL 26)				

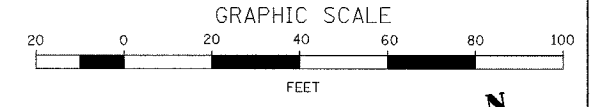

REMOVE EXISTING TRAFFIC SIGNAL EQUIPMENT-1.0 EACH (INCLUDES ALL ITEMS LISTED BELOW)

THE FOLLOWING ITEMS SHALL BE REMOVED AND DISPOSED OF BY THE CONTRACTOR OFF THE RIGHT-OF-WAY. THE SALVAGE VALUE OF THIS EQUIPMENT SHALL BE REFLECTED IN THE UNIT BID PRICE FOR REMOVE EXISTING TRAFFIC SIGNAL EQUIPMENT

- 1 EACH CONTROLLER CABINET AND CONTENTS
- 8 EACH SIGNAL HEAD, 1-FACE, 3-SECTION, MAST ARM MOUNTED WITH BACKPLATE
- 8 EACH PEDESTRIAN SIGNAL HEAD, 1-FACE, 3-SECTION, BRACKET MOUNTED
- 4 EACH STEEL MAST ARM ASSEMBLY AND POLE WITH PEDESTRIAN PUSH BUTTON
- 4 EACH PEDESTRIAN PUSH BUTTON POST WITH PEDESTRIAN PUSH BUTTON
- ALL ELECTRIC CABLE IN CONDUIT
- ALL SERVICE CABLE

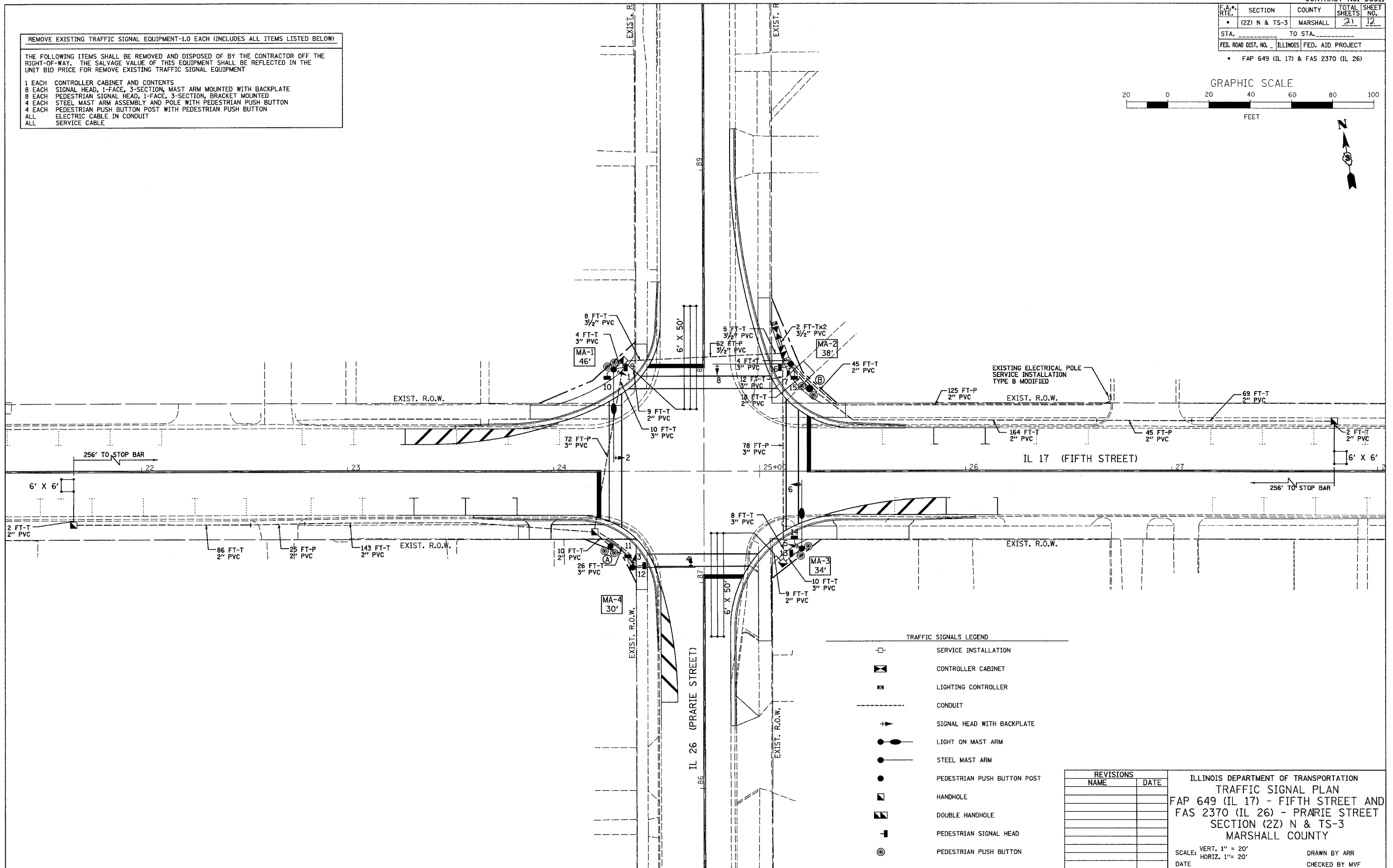

TRAFFIC SIGNALS LEGEND

- SERVICE INSTALLATION
- ▣ CONTROLLER CABINET
- ▣ LIGHTING CONTROLLER
- CONDUIT
- + SIGNAL HEAD WITH BACKPLATE
- LIGHT ON MAST ARM
- STEEL MAST ARM
- PEDESTRIAN PUSH BUTTON POST
- ▣ HANDHOLE
- ▣ DOUBLE HANDHOLE
- ▣ PEDESTRIAN SIGNAL HEAD
- ⊙ PEDESTRIAN PUSH BUTTON

REVISIONS	
NAME	DATE

ILLINOIS DEPARTMENT OF TRANSPORTATION
 TRAFFIC SIGNAL PLAN
 FAP 649 (IL 17) - FIFTH STREET AND
 FAS 2370 (IL 26) - PRAIRIE STREET
 SECTION (22) N & TS-3
 MARSHALL COUNTY

SCALE: VERT. 1" = 20'
 HORIZ. 1 1/2" = 20'

DATE _____ DRAWN BY ARR
 CHECKED BY MVF

PLOT DATE = 04/26/06
 FILE NAME = 06FILEL06
 USER NAME = MUSEW