

INDEX OF SHEETS

- 1 COVERSHEET
- 2 GENERAL NOTES & TYPICAL
- 3 SUMMARY & SCHEDULE
- 4 DETAILS

HIGHWAY STANDARDS

- 635011-01 REFLECTOR MARKER & MOUNTING DETAILS
- 701106-01 OFF-ROAD OPERATIONS, MULTILANE, MORE THAN 4.5 m (15') AWAY
- 701400-02 APPROACH TO LANE CLOSURE, FREEWAY/EXPRESSWAY
- 701406-04 LANE CLOSURE, FREEWAY/EXPRESSWAY
- 702001-06 TRAFFIC CONTROL DEVICES
- 635006-02 REFLECTOR AND TERMINAL MARKER PLACEMENT

STATE OF ILLINOIS
 DEPARTMENT OF TRANSPORTATION
 DIVISION OF HIGHWAYS
**PROPOSED
 HIGHWAY PLANS**

FAI ROUTE 57 (I-57)

SECTION D3 INTERSTATE SAFETY 2007-3

PROJECT HSIP-057-6(180)277

IROQUOIS COUNTY

C - 93 - 048 - 06

PROJECT DESCRIPTION

INSTALL HIGH TENSION CABLE MEDIAN BARRIER SYSTEM

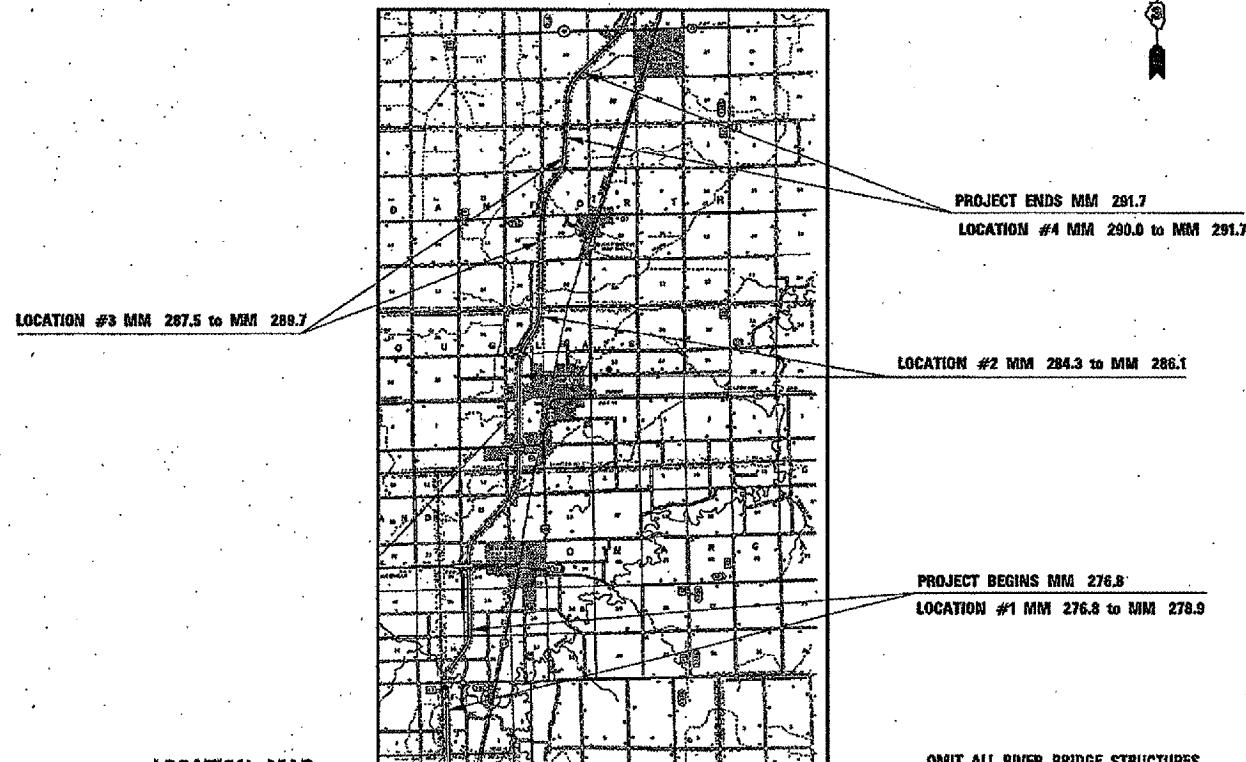

LOCATION MAP
NOT TO SCALE

GROSS LENGTH = 78,672 FT. = 14.9 MI.
NET LENGTH = APPROXIMATELY 41,184 FT. = 7.8 MI.

OMIT ALL RIVER BRIDGE STRUCTURES

F.A.I. RTE.	SECTION	COUNTY	TOTAL SHEETS	SHEET NO.
57		IROQUOIS	4	1

D-93-027-06

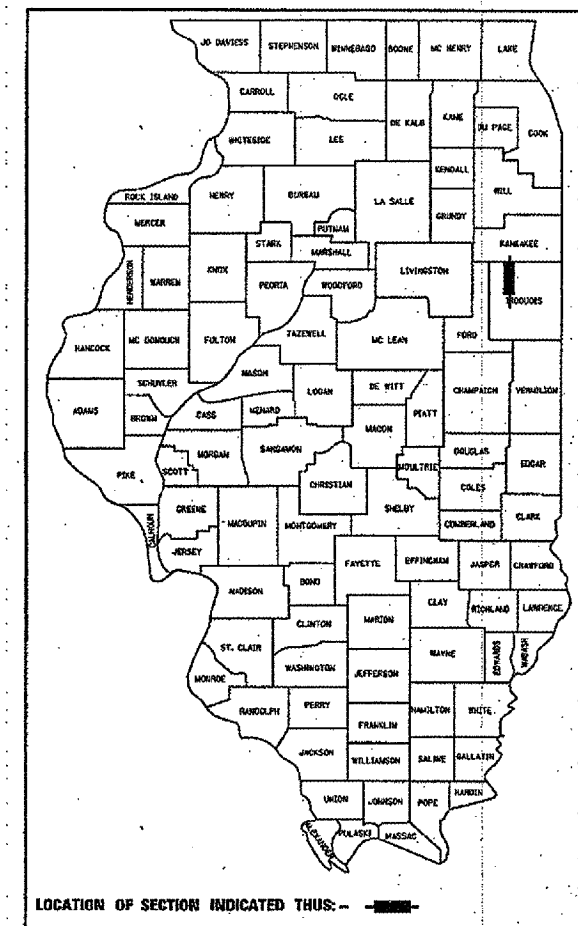

LOCATION OF SECTION INDICATED THUS: -

FUNCTION CLASSIFICATION

INTERSTATE

2003 ADT = 16,300

P.V. = 69.3 % S.U. = 4.9 % M.U. = 25.8 %

MICROFILMED _____
 REEL NUMBER _____
 AWARDED _____
 RESIDENT ENGINEER _____
 AS BUILT CHANGES WERE MADE
 ON THE FOLLOWING SHEETS _____

JULIE 1-800-892-0123

DISTRICT 3 NO. (815) 434-6131

PROJECT ENGINEER: DAN DRAPER
 UNIT CHIEF: PAT BRABOY
 TOWNSHIPS: VARIOUS

CONTRACT NO. 66639

STATE OF ILLINOIS
 DEPARTMENT OF TRANSPORTATION
 DIVISION OF HIGHWAYS

SUBMITTED _____ 20____

Henry P. Minton
 DEPUTY DIRECTOR OF HIGHWAYS, REGION ENGINEER

May 12, 20 06
Mike Dene
 ENGINEER OF DESIGN AND ENVIRONMENT

May 12, 20 06
Milton R. Sees P.E.
 DIRECTOR OF HIGHWAYS, CHIEF ENGINEER

PRINTED BY THE AUTHORITY
OF THE STATE OF ILLINOIS

F.A.I. RYE	SECTION	COUNTY	TOTAL SHEETS	SHEET NO.
57		IRROQUOIS	4	3

FED. ROAD DIST. NO. ILLINOIS FED. AID PROJECT

03 INTERSTATE SAFETY 2007-3

HIGH TENSION CABLE MEDIAN BARRIER SYSTEM AND AGGREGATE SHOULDER

LOCATION	HIGH TENSION CABLE MEDIAN BARRIER SYSTEM FT	GUARDRAIL MARKERS TYPE A EACH	TERMINAL MARKERS PM** EACH	AGGREGATE SHOULDER, TYPE B TONS
MM POSTS				
LOCATION 1				
SBL				
276.8 TO 277.0	1,030	26	1	26.1
OMIT S.N. 038-0154				
277.05 TO 277.7	3,432	86	1	86.9
OMIT S.N. 038-0156				
277.75 TO 278.9	6,072	152	1	153.7
SRL				
277.0 TO 277.1	300	8	1	7.6
277.7 TO 277.8	300	8	1	7.6
LOCATION 2				
SBL				
284.3 TO 284.5	1,056	27	1	26.7
OMIT MAINTENANCE X-OVER				
284.52 TO 285.4	4,646	116	1	117.6
285.8 TO 285.85	300	8	1	7.6
SRL				
284.3 TO 284.5	1,056	27	1	26.7
OMIT MAINTENANCE X-OVER				
284.52 TO 285.8	6,758	169	1	171.0
OMIT SN 038-168				
285.85 TO 286.1	1,320	33	1	33.4
LOCATION 3				
SBL				
287.8 TO 287.85	300	8	1	7.6
288.8 TO 288.85	300	8	1	7.6
289.3 TO 289.35	300	8	1	7.6
SRL				
287.5 TO 287.8	1,584	40	1	40.1
OMIT SN 038-0159				
287.85 TO 288.0	792	20	1	20.0
OMIT MAINTENANCE X-OVER				
288.02 TO 288.8	4,119	103	1	104.2
OMIT SN 038-0011				
288.85 TO 289.3	2,376	60	1	60.1
OMIT SN 038-0130				
289.35 TO 289.7	1,848	47	1	46.8
LOCATION 4				
SBL				
290.0 TO 291.5	7,920	199	1	200.4
OMIT MAINTENANCE X-OVER				
291.52 TO 291.7	950	24	1	24.0
TOTAL	46,759	1,169	20	1183.4

*BOLT GUARDRAIL MARKERS DIRECTLY ON POSTS-PLACE AT 40 NOMINAL CENTERS OR AS POST SPACING PERMITS
 **FINAL LOCATION OF TERMINAL MARKERS, POST MOUNTED TO BE DETERMINED BY ENGINEER-NONE NEEDED IF WE CAN SHIELD END SECTIONS BY CONCRETE BARRIERS OR END SECTIONS

SUMMARY OF QUANTITIES

90% FED.
10% STATE

CODE NO.	ITEM	UNIT	CONSTR. TYPE CODE
			ROADWAY SFTY-3J
48101200	AGGREGATE SHOULDERS, TYPE B	TON	1099
67100100	MOBILIZATION	L SUM	1
70100700	TRAFFIC CONTRTOL AND PROTECTION, STANDARD 701406	LSUM	1
78200410	GUARDRAIL MARKERS, TYPE A	EACH	1169
78202000	TERMINAL MARKER - POST MOUNTED	EACH	20
Z0029650	HIGH TENSION CABLE MEDIAN BARRIER SYSTEM	FOOT	46,759

1/24/2006 c:\pro\ecr\sv\02706\0118715.dgn

REVISIONS	
NAME	DATE

ILLINOIS DEPARTMENT OF TRANSPORTATION
SCHEDULES & SUMMARY
 SCALE: VERT. DATE
 HORIZ. DATE
 DRAWN BY
 CHECKED BY

F.A.I. RTE.	SECTION	COUNTY	TOTAL SHEETS	SHEET NO.
57		IROQUOIS	4	4
STA.		TO STA.		
FED. ROAD DIST. NO.		ILLINOIS FED. AID PROJECT		

*DS INTERSTATE SAFETY 2007-3



NOT TO SCALE

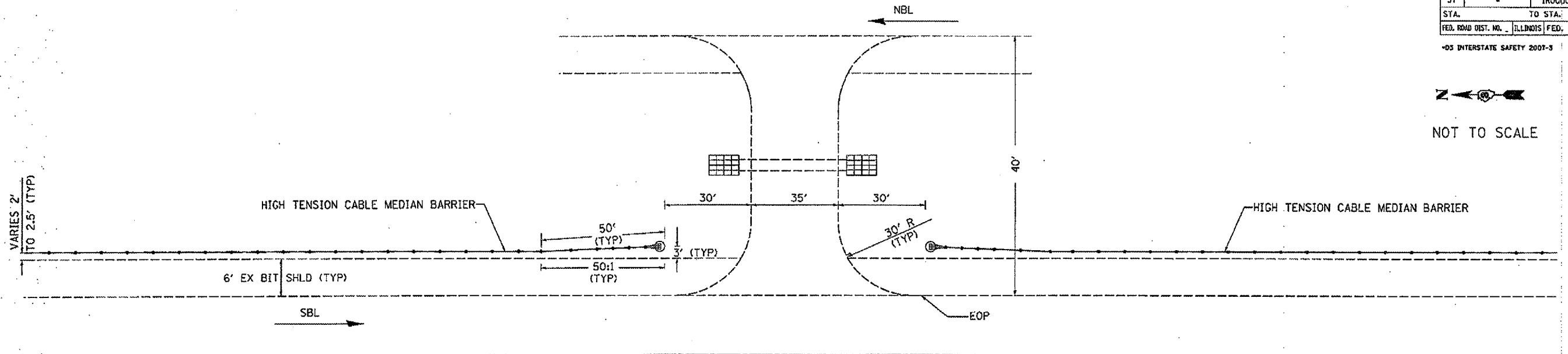

2 MAINTENANCE CROSSOVERS
MM POSTS 284.5, 288.0, and 291.5



NOT TO SCALE

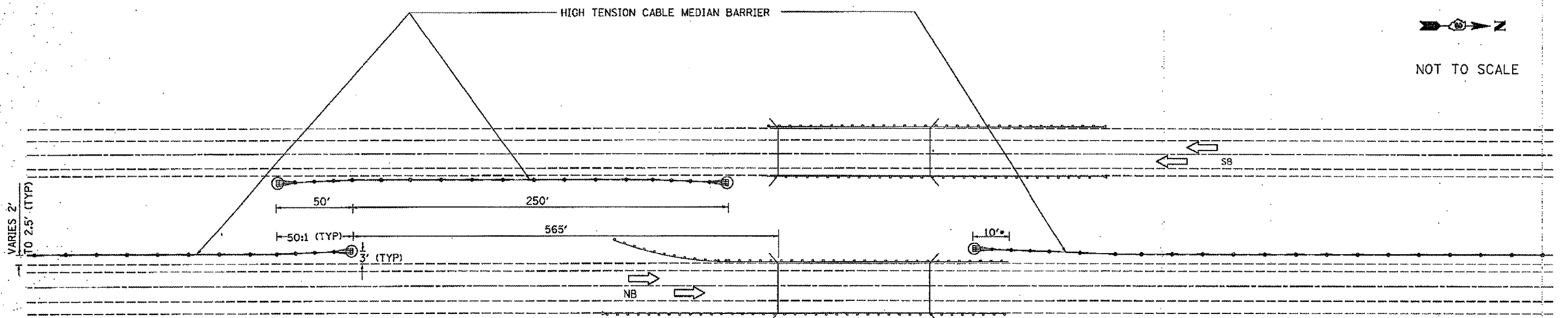

NBL OMISSIONS SHOWN-SBL SIMILAR

STRUCTURE OMISSIONS

- NBL
- MM POST 277.0 (SN 038-0154)
- MM POST 277.7 (SN 038-0156)
- SBL
- MM POST 285.8 (SN 038-0168)
- MM POST 287.8 (SN 038-0159)
- MM POST 288.8 (SN 038-0011)
- MM POST 289.3 (SN 038-0130)

*IF NO GUARRAIL IS ATTACHED TO BRIDGE,
LOCATE CABLE MEDIAN BARRIER SUCH THAT
THE END SECTION IS SHIELDED FROM TRAFFIC

REVISIONS	
NAME	DATE

ILLINOIS DEPARTMENT OF TRANSPORTATION

DETAILS

SCALE: VERT.
HORIZ.
DATE

DRAWN BY
CHECKED BY

1/20/2008 c:\p\p\6\66639\66639.dwg