

F.A.P. RTE.	SECTION	COUNTY	TOTAL SHEETS	SHEET NO.
646	1103-LIN-5.TS	PEORIA		17
STA.		TO STA.		
FED. ROAD DIST. NO. 4		ILLINOIS FED. AID PROJECT		

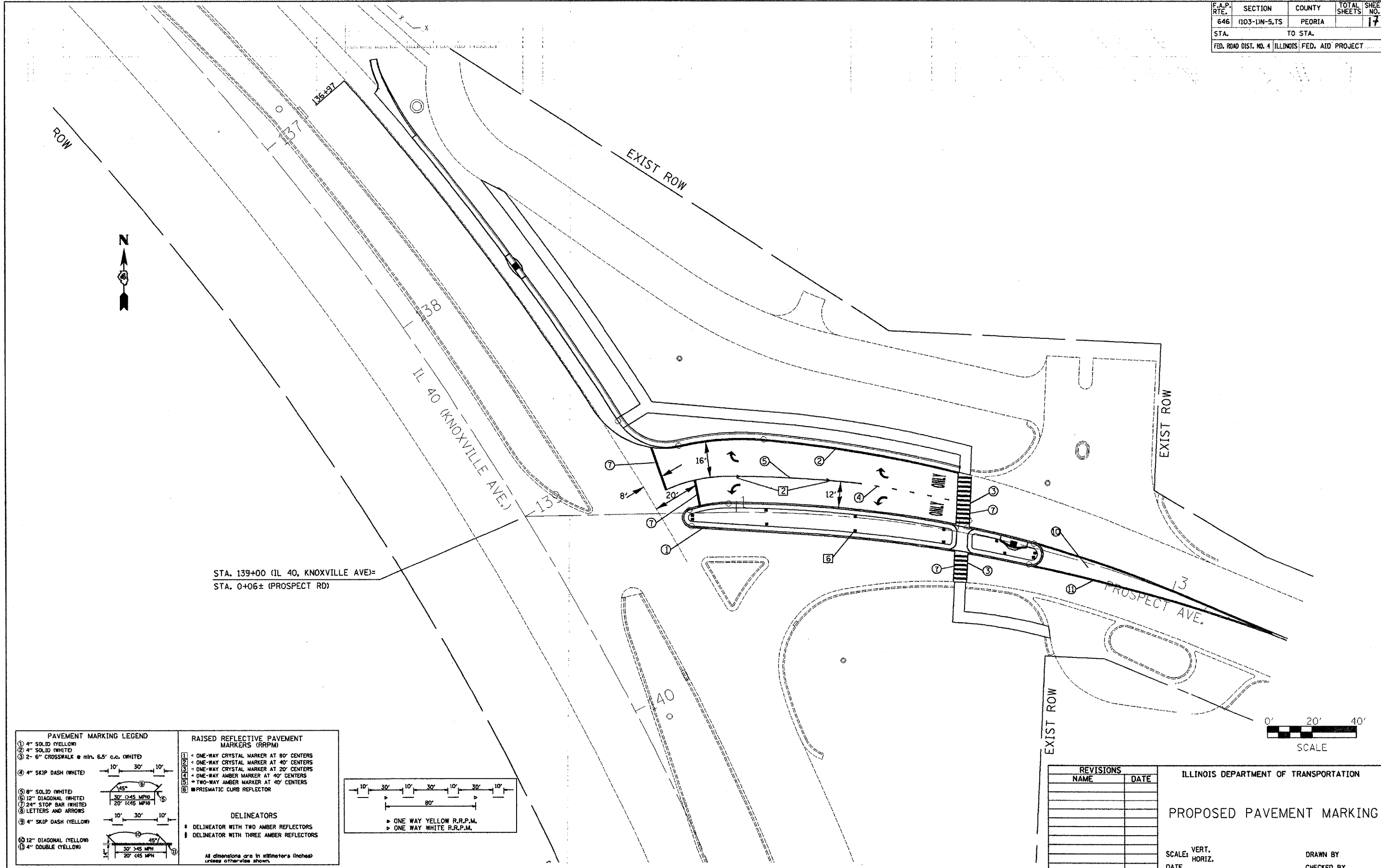

STA. 139+00 (IL 40, KNOXVILLE AVE)=  
STA. 0+06± (PROSPECT RD)



**PAVEMENT MARKING LEGEND**

① 4" SOLID YELLOW	⑥ 8" SOLID WHITE	⑩ 12" DIAGONAL (YELLOW)
② 4" SOLID WHITE	⑦ 12" DIAGONAL (WHITE)	⑪ 4" DOUBLE YELLOW
③ 2- 6" CROSSWALK @ min. 6.5' c.c. (WHITE)	⑧ 24" STOP BAR (WHITE)	
④ 4" SKIP DASH (WHITE)	⑨ 4" SKIP DASH (YELLOW)	

**RAISED REFLECTIVE PAVEMENT MARKERS (RRPM)**

① ONE-WAY CRYSTAL MARKER AT 80' CENTERS
② ONE-WAY CRYSTAL MARKER AT 40' CENTERS
③ ONE-WAY CRYSTAL MARKER AT 20' CENTERS
④ ONE-WAY AMBER MARKER AT 40' CENTERS
⑤ TWO-WAY AMBER MARKER AT 40' CENTERS
⑥ PRISMATIC CURB REFLECTOR

**DELINEATORS**

- ▬ DELINEATOR WITH TWO AMBER REFLECTORS
- ▬ DELINEATOR WITH THREE AMBER REFLECTORS

All dimensions are in millimeters (inches) unless otherwise shown.

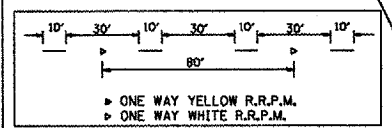

**REVISIONS**

NAME	DATE

ILLINOIS DEPARTMENT OF TRANSPORTATION

**PROPOSED PAVEMENT MARKING**

SCALE: VERT. \_\_\_\_\_  
HORIZ. \_\_\_\_\_

DATE \_\_\_\_\_

DRAWN BY \_\_\_\_\_  
CHECKED BY \_\_\_\_\_

PLOT DATE = 3/31/2008  
 FILE NAME = c:\pvc\prospect\1103-prospect\plan\sheet.dgn  
 USER NAME = ruzsistin  
 USER TITLE =