

F.A.P. RTE.	SECTION	COUNTY	TOTAL SHEETS	SHEET NO.
646	(130-DN-5,TS	PEORIA		18
STA.	TO STA.			
FED. ROAD DIST. NO. 4 ILLINOIS FED. AID PROJECT				
CONT. #68600				

**TRAFFIC SIGNAL LEGEND**

- EX. CONDUIT
- EX. 6' X 6' DETECTOR LOOP
- ▤ EX. 6' X 40' DETECTOR LOOP
- ⊗ EX. LUMINAIRE
- ⊠ EX. DOUBLE HANDHOLE
- ⊞ EX. HANDHOLE
- ⊞ EX. JUNCTION BOX
- EX. SERVICE INSTALLATION
- ⊞ EX. COMBINATION MAST ARM
- ⊞ EX. SIGNAL HEAD
- ⊞ EX. SIGNAL HEAD W/ BACKPLATE
- ⊞ EX. CONTROLLER WITH BBS

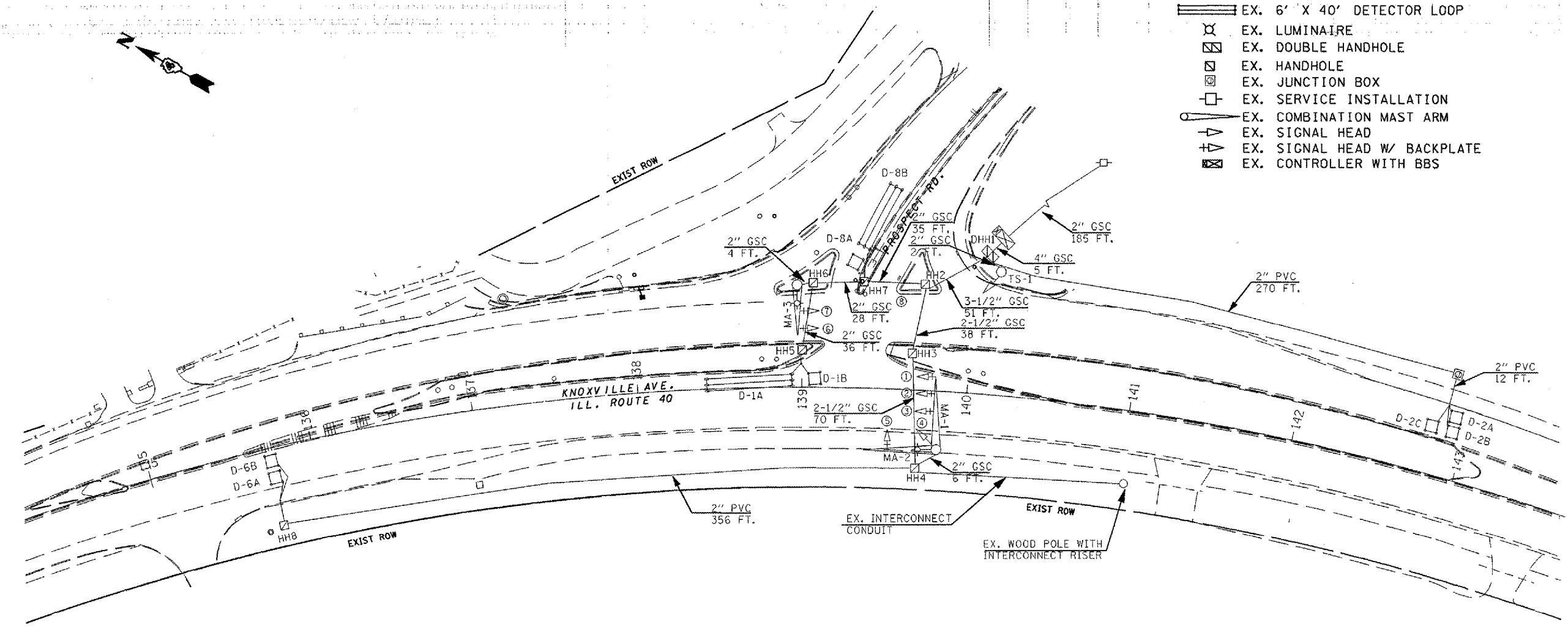

REMOVE EXISTING CONCRETE FOUNDATIONS - QTY. 2 EA.  
 QTY. LOCATIONS  
 1.0 EA. MA-1/2, MA-3

REMOVE EXISTING HANDHOLE - QTY. 2 EA.  
 QTY. LOCATIONS  
 1.0 EA. HH-6, HH-7

REMOVE EXISTING TRAFFIC SIGNAL EQUIPMENT - QTY. 1 EACH (INCLUDES ALL ITEMS LISTED BELOW)

THE FOLLOWING TRAFFIC SIGNAL EQUIPMENT SHALL BE REMOVED AND DELIVERED BY THE CONTRACTOR TO THE CITY OF PEORIA DRIES TRAFFIC OPERATIONS CENTER, 3505 N. DRIES LANE, PEORIA, IL. CONTACT CRAIG ESPINOSA (309) 494-8893 FORTY-EIGHT HOURS IN ADVANCE OF DELIVERY.

QTY.	ITEM
1.0	COMBINATION MAST ARM ASSEMBLY AND POLE WITH LUMINAIRES
1.0	COMBINATION MAST ARM ASSEMBLY AND POLE WITH DUAL ARMS AND LUMINAIRE
6.0	SIGNAL HEAD, 1-FACE, 3 OR 5-SECTION WITH BACKPLATE, MAST ARM MOUNTED
2.0	SIGNAL HEAD, 1-FACE, 3 OR 5-SECTION, BRACKET MOUNTED
1.0	CONTROLLER CABINET AND CONTENTS
1.0	TRAFFIC SIGNAL POST

THE FOLLOWING ITEMS SHALL BE REMOVED AND DISPOSED OF BY THE CONTRACTOR OFF OF THE RIGHT-OF-WAY. THE SALVAGE VALUE OF THIS EQUIPMENT SHALL BE REFLECTED IN THE UNIT BID PRICE FOR REMOVE EXISTING TRAFFIC SIGNAL EQUIPMENT.

QTY.	ITEM
ALL	ELECTRIC CABLE (NOT REQUIRED OR RE-USED FOR PROPOSED TRAFFIC SIGNALS)

- EXISTING TRAFFIC SIGNAL AND REMOVAL NOTES**
1. THE REMOVAL ITEMS ARE AS INDICATED ON THE PLANS. THE CONTRACTOR SHALL VERIFY ALL REMOVAL ITEMS PRIOR TO BIDDING.
  2. THE EXISTING TRAFFIC SIGNALS SHALL REMAIN IN OPERATION DURING THE CONSTRUCTION OF THE TEMPORARY TRAFFIC SIGNALS.
  3. ANY MAINTENANCE OF THE EXISTING SIGNALS SHALL BE CONSIDERED EXTRA WORK IN ACCORDANCE WITH ARTICLE 109.04 OF THE STANDARD SPECIFICATIONS.
  4. FULL DEPTH SAW CUTS SHALL BE REQUIRED AT ALL REMOVAL LIMITS. IF THE CONTRACTOR REMOVES OR DAMAGES THE EXISTING SIDEWALK OR BITUMINOUS SURFACE OUTSIDE THE REMOVAL LIMITS DESIGNATED BY THE ENGINEER, THE CONTRACTOR SHALL REMOVE AND/OR REPLACE THAT PORTION AT THE CONTRACTOR'S EXPENSE.
  5. THE EXISTING HANDHOLES SHALL BE REMOVED. THIS WORK WILL BE PAID FOR AS "REMOVE EXISTING HANDHOLE".

REVISIONS	
NAME	DATE

ILLINOIS DEPARTMENT OF TRANSPORTATION

EXISTING TRAFFIC SIGNALS  
 IL 40 (KNOXVILLE) & PROPSPECT

SCALE: VERT. DATE  
 HORIZ. CHECKED BY

\$\$\$DATE\$\$\$  
 \*DGN-ONLY\*