

SCHEDULE OF QUANTITIES		
ITEM DESCRIPTION	UNIT	QTY
GROUNDING EXISTING HANDHOLE FRAME AND COVER	EACH	2
CONDUIT IN TRENCH, 2" DIA., PVC	FOOT	166
CONDUIT IN TRENCH, 3" DIA., PVC	FOOT	37
CONDUIT IN TRENCH, 3 1/2" DIA., PVC	FOOT	20
CONDUIT PUSHED, 3" DIA., PVC	FOOT	135
CONDUIT PUSHED, 3 1/2" DIA., PVC	FOOT	110
CONCRETE HANDHOLE	EACH	1
TRENCH AND BACKFILL FOR ELECTRICAL WORK	FOOT	223
ELECTRIC CABLE IN CONDUIT, 600V, (XLP-TYPE USE) 1/C NO. 6	FOOT	796
LUMINAIRE, SODIUM VAPOR, HORIZONTAL MOUNT, 400 WATT	EACH	2
LIGHT POLE, STEEL GALVANIZED, TRANSFORMER BASE,	EACH	1
45 FT. MH, 12 FT. MAST ARM	EACH	1
LIGHT POLE FOUNDATION	EACH	1
FULL-ACTUATED CONTROLLER IN TYPE IV CABINET, SPECIAL	EACH	1
ELECTRIC CABLE IN CONDUIT, SIGNAL, NO. 14 3C	FOOT	474
ELECTRIC CABLE IN CONDUIT, SIGNAL, NO. 14 5C	FOOT	1647
ELECTRIC CABLE IN CONDUIT, SIGNAL, NO. 14 7C	FOOT	290
TRAFFIC SIGNAL POST, GALVANIZED STEEL, 14 FT.	EACH	1
TRAFFIC SIGNAL POST, GALVANIZED STEEL, 15 FT.	EACH	1
STEEL MAST ARM ASSEMBLY AND POLE 55 FT.	EACH	1
STEEL COMBINATION MAST ARM ASSEMBLY AND POLE 50 FT.	EACH	1
CONCRETE FOUNDATION, TYPE A	FOOT	3
CONCRETE FOUNDATION, TYPE E, 36-INCH DIAMETER	FOOT	30
DRILL EXISTING HANDHOLE	EACH	6
TRAFFIC SIGNAL BACKPLATE, LOUVERED, FORMED PLASTIC	EACH	5
INDUCTIVE LOOP DETECTOR	EACH	5
REMOVE EXISTING TRAFFIC SIGNAL EQUIPMENT	EACH	1
REMOVE EXISTING HANDHOLE	EACH	2
REMOVE EXISTING CONCRETE FOUNDATION	EACH	2
VIDEO VEHICLE DETECTION SYSTEM, 2 CAMERA	EACH	1
ELECTRIC CABLE IN CONDUIT, 1/C, NO. 6 GROUNDING	FOOT	578
SIGNAL HEAD, LED, 1-FACE, 3-SECTION, MAST ARM MOUNTED	EACH	4
SIGNAL HEAD, LED, 1-FACE, 3-SECTION, BRACKET MOUNTED	EACH	5
SIGNAL HEAD, LED, 1-FACE, 4-SECTION, MAST ARM MOUNTED	EACH	1
SIGNAL HEAD, LED, 1-FACE, 4-SECTION, BRACKET MOUNTED	EACH	1

TRAFFIC SIGNAL LEGEND

- ▣ PROP. CONCRETE HANDHOLE
- ▣ PROP. PEDESTRIAN SIGNAL HEAD
- ⊙ PROP. PEDESTRIAN PUSH BUTTON
- ▣ PROP. SIGNAL HEAD WITH BACKPLATE
- ▣ PROP. SIGNAL HEAD
- ⓧ PROP. VIDEO DETECTION CAMERA
- ▣ PROP. TRAFFIC SIGNAL CONTROLLER
- PROP. TRAFFIC SIGNAL POST
- ⊗ PROP. LUMINAIRE
- PROP. SERVICE INSTALLATION

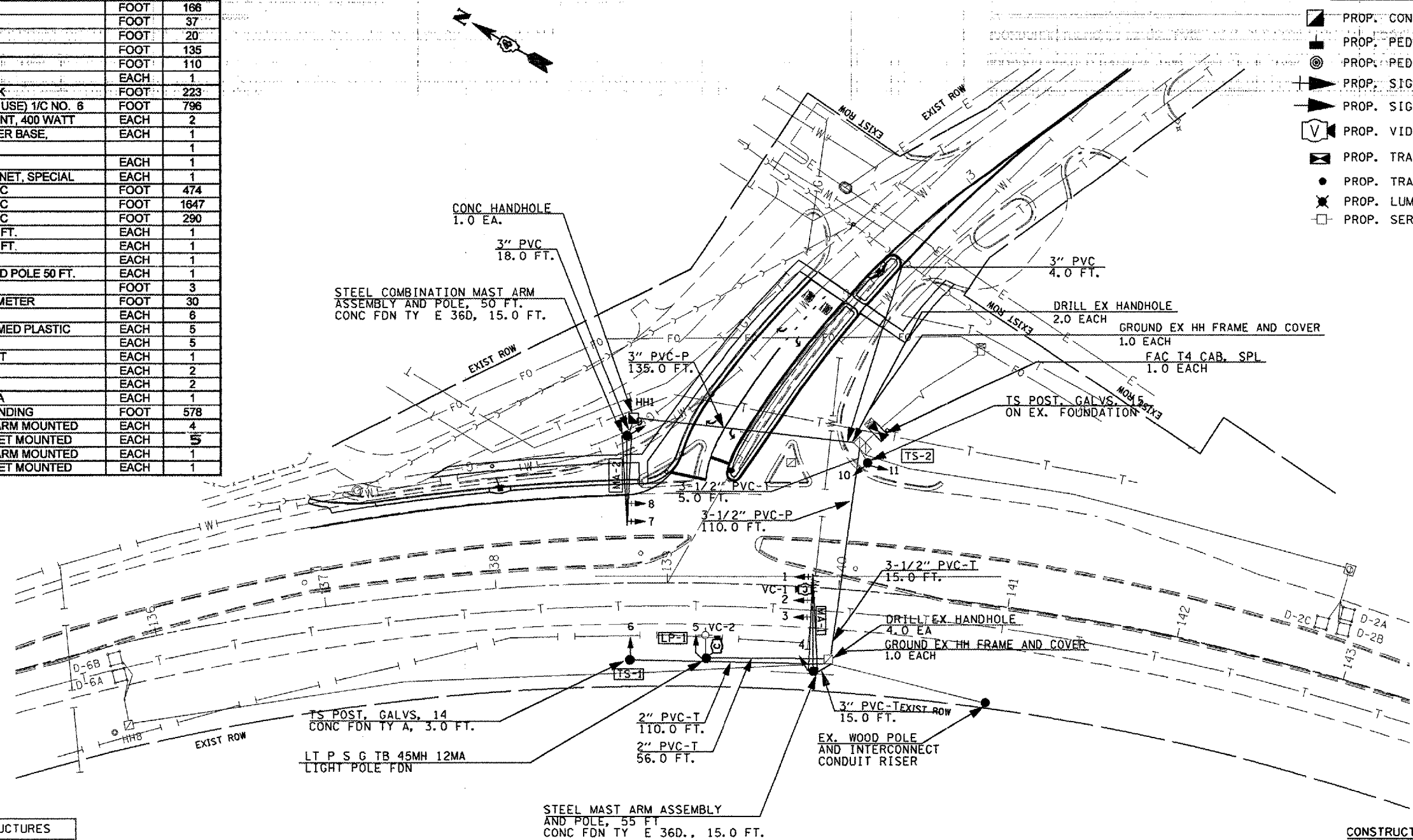

SCHEDULE OF TRAFFIC SIGNAL STRUCTURES			
REF.	LOCATION	TYPE	LENGTH
LP-1	SE QUADRANT	LT P S G TB 45MH 12 DA	45 FT.
TS-1	W QUADRANT	TS POST GALVS	15 FT.
TS-2	SE QUADRANT	TS POST GALVS	10 FT.
MA-1	SW QUADRANT	S MAA & P	55 FT.
MA-2	NE QUADRANT	S COMB MAA & P	40 FT.

SCHEDULE OF SIGNAL HEADS			
QTY	UNIT	ITEM	LOCATION
4.0	EA.	SH, LED, 1F, 3-SEC, MAM	2, 3, 7, 8
1.0	EA.	SH, LED, 1F, 3-SEC, BM	4, 5, 11, 9, 6
1.0	EA.	SH, LED, 1F, 4-SEC, MAM W/ DUAL INDICATION ARROW	1
1.0	EA.	SH, LED, 1F, 4-SEC, MAM W/ DUAL INDICATION ARROW	10
5.0	EA.	TRAFFIC SIGNAL BACKPLATE LOUVERED	1, 2, 3, 7, 8

MA-1 SHALL BE LOCATED A MINIMUM OF 26 FT. BEHIND THE EDGE OF THE ROADWAY IN ACCORDANCE WITH CLEAR ZONE REQUIREMENTS

CONSTRUCTION NOTES

1. THE CONTRACTOR SHALL REMOVE ALL EXISTING SIGNS FROM THE MAST ARMS AND RELOCATE THEM ONTO THE THE PROPOSED MAST ARMS, POSTS AND/OR LIGHT POLE. THIS WORK WILL NOT BE PAID FOR SEPARATELY, BUT SHALL BE INCLUDED IN THE CONTRACT UNIT BID PRICES FOR THE STRUCTURES.
2. THE CONTRACTOR SHALL DISCONNECT THE EXISTING INTERCONNECT AND ADVANCED DETECTOR LOOP CABLES FROM THE CONTROLLER CABINET AND PULL THE CABLE BACK TO THE NEAREST HANDHOLE NOT AFFECTED BY CONSTRUCTION. THE EXISTING CABLES SHALL BE RE-INSTALLED IN THE PROPOSED CONDUITS AND CONTROLLER CABINET. THIS WORK WILL NOT BE PAID FOR SEPARATELY, BUT SHALL BE INCLUDED IN THE CONTRACT UNIT BID PRICES FOR THE PROJECT.

CONSTRUCTION STAGING NOTES

ALL TRAFFIC SIGNAL WORK MUST BE COMPLETED BEFORE THE INTERSECTION IMPROVEMENTS CAN COMMENCE. IF THE CONTRACTOR ELECTS ALTERNATE STAGING, ALL COSTS ASSOCIATED WITH THE STAGING CHANGE, INCLUDING BUT NOT LIMITED TO TRAFFIC SIGNAL MODIFICATIONS, TEMPORARY CABLE, AND TEMPORARY TRAFFIC SIGNALS, WILL BE THE SOLE RESPONSIBILITY OF THE CONTRACTOR.

REVISIONS	
NAME	DATE

ILLINOIS DEPARTMENT OF TRANSPORTATION
 PROPOSED TRAFFIC SIGNALS
 IL 40 (KNOXVILLE) & PROSPECT
 SCALE: VERT. _____
 HORIZ. _____
 DATE _____ DRAWN BY _____
 CHECKED BY _____

\$\$\$DATE\$\$\$
 DGN-ONLY