

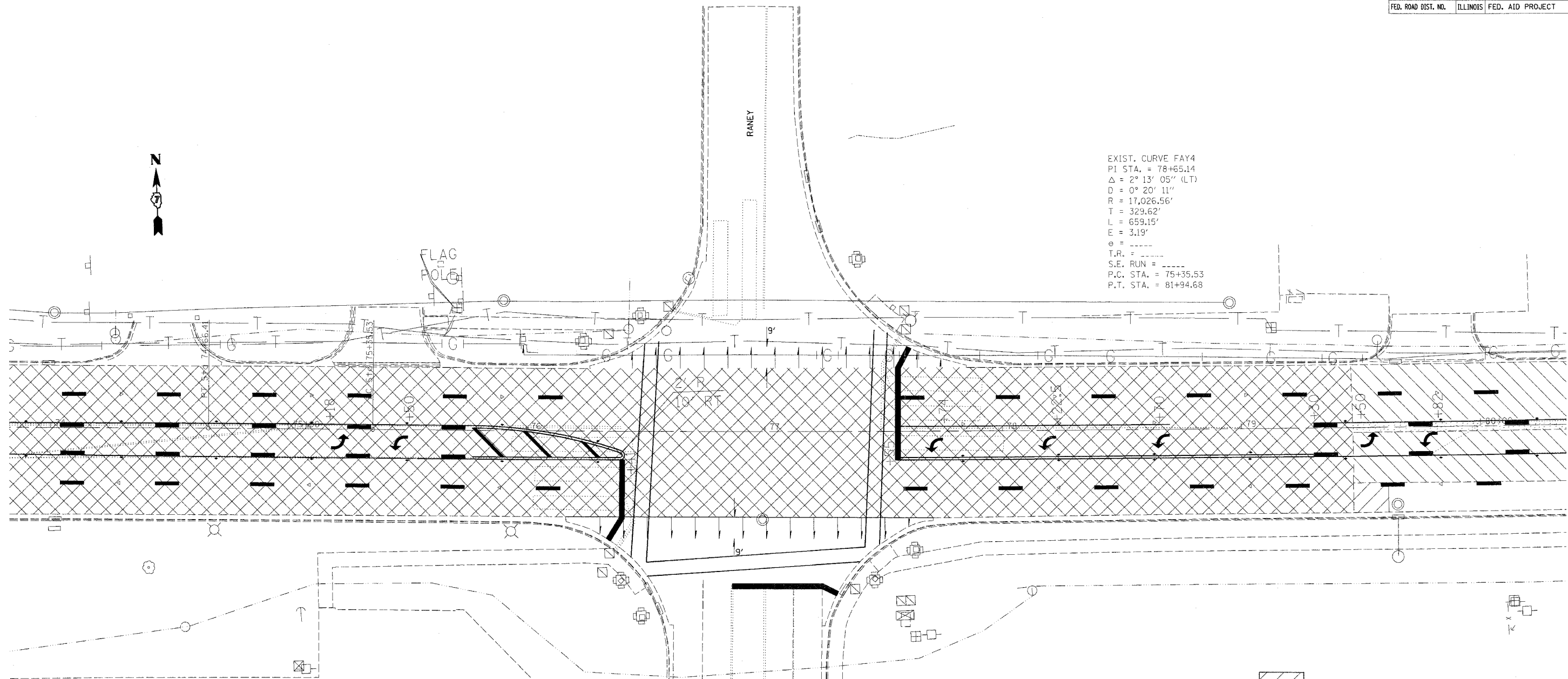

district
3/30/2006
c:\projects\74063dp\d04304pa.dgn

CONTRACT NO. 74063

F.A.P. RTE.	SECTION	COUNTY	TOTAL SHEETS	SHEET NO.
95	18RS	EFFINGHAM	13	9
STA.		TO STA.		
FED. ROAD DIST. NO.		ILLINOIS FED. AID PROJECT		

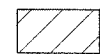

EXIST. CURVE FAY4
 PI STA. = 78+65.14
 $\Delta = 2^\circ 13' 05''$ (LT)
 $D = 0^\circ 20' 11''$
 $R = 17,026.56'$
 $T = 329.62'$
 $L = 659.15'$
 $e = 3.19'$
 $T.R. =$
 $S.E. RUN =$
 $P.C. STA. = 75+35.53$
 $P.T. STA. = 81+94.68$

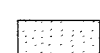
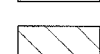

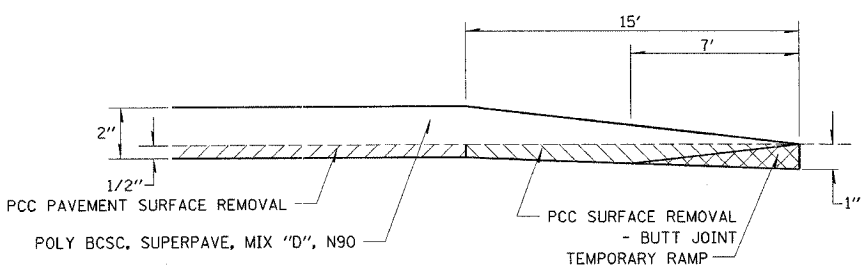
-  PCC SURFACE REMOVAL - BUTT JOINT (SQ YD)
-  PCC PAVEMENT SURFACE REMOVAL (SQ YD)
-  MEDIAN REMOVAL PARTIAL DEPTH (SQ FT)
-  BITUMINOUS SURFACE REMOVAL (SPECIAL) (SQ YD)



BUTT JOINT DETAIL
 RT STA 79+47 TO RT STA 79+62

-  ONE-WAY CRYSTAL MARKER
-  TWO-WAY AMBER MARKER

REVISIONS	
NAME	DATE

ILLINOIS DEPARTMENT OF TRANSPORTATION

PAVEMENT MARKING
STA 74+00 TO STA 80+00

SCALE: VERT. _____
 HORIZ. _____

DATE _____

DRAWN BY _____
 CHECKED BY _____

PLOT DATE = 3/30/2006
 PLOT SCALE = AS SHOWN
 USER NAME = district