

F.A.P. RTE.	SECTION	COUNTY	TOTAL SHEETS	SHEET NO.
750	(112) Y, WRS	FAYETTE	52	21
STA. 46+00		TO STA. 78+00		
FED. ROAD DIST. NO. 7 ILLINOIS FED. AID PROJECT				

CONTRACT NO. 74080

WARNING
 HIGH-PRESSURE PIPELINE
 EXCAVATION AND/OR CONSTRUCTION
 PROHIBITED WITHOUT FIRST CONTACTING
 CHICAP PIPE LINE CO.
 26" CRUDE PIPELINE, 30" CASING
 PERMIT #7-8985 1967
 APPROX. DEPTH 60"

EXXON MOBILE PIPELINE CO.
 18" CRUDE PIPELINE, 22" CASING
 PERMIT #7-2704 1939
 APPROX. DEPTH 40"

DATE	BY
DATE	BY
DATE	BY
DATE	BY
DATE	BY

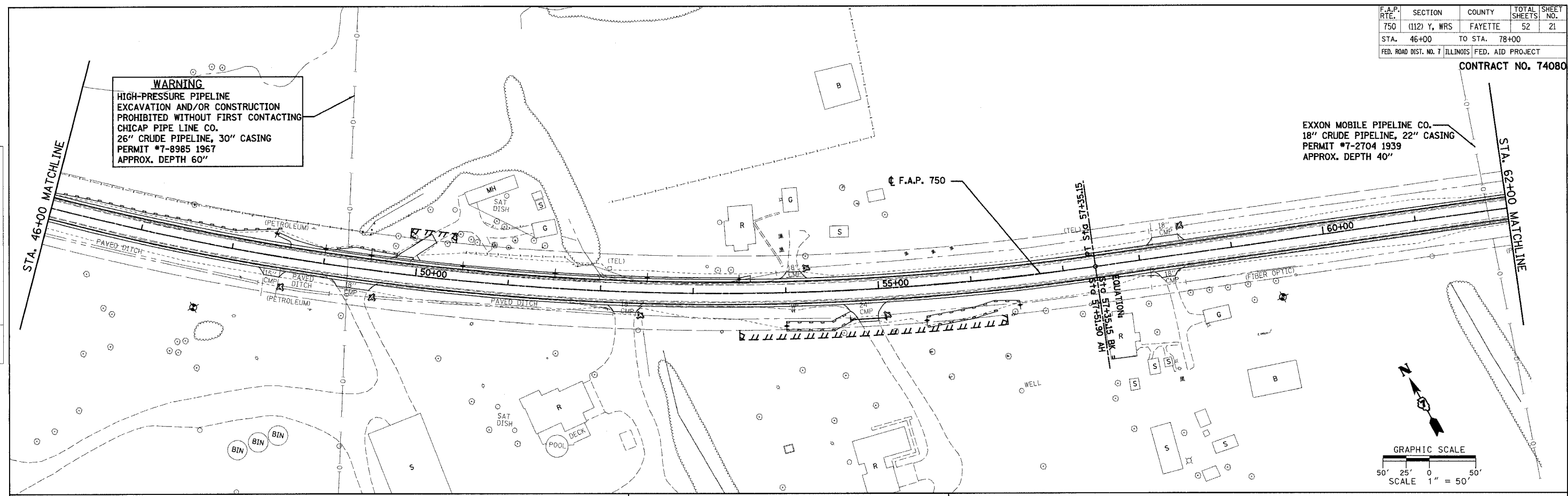

TEMPORARY EROSION CONTROL LEGEND

	RIPRAP TO REMAIN AFTER CONSTRUCTION
	TEMPORARY DITCH CHECK
	EROSION CONTROL FIBER BLANKET
	PERIMETER EROSION BARRIER
	INLET AND PIPE PROTECTION

DATE	BY
DATE	BY
DATE	BY
DATE	BY
DATE	BY

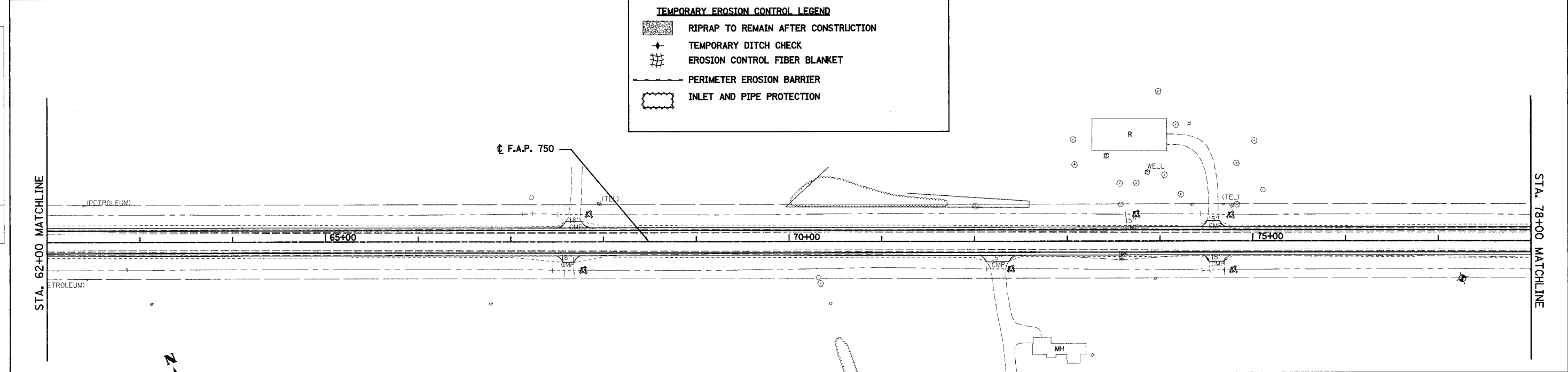

REVISIONS	
NAME	DATE

ILLINOIS DEPARTMENT OF TRANSPORTATION
 EROSION CONTROL PLAN
 SHEET 3 OF 5
 F.A.P. 750 (IL. RTE. 185)
 SECTION 112 - FAYETTE CO.
 SCALE: 1"=50'
 DATE: September 23, 2005
 DRAWN BY: CRO
 CHECKED BY: RCY

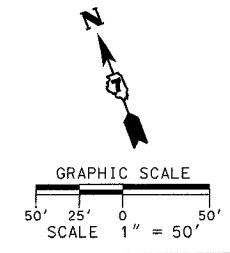

I:\2003\030045\0002\civil\phase 1\kdp.dgn.plt,erc750.03.dgn 9/21/2005 9:20:54 PM