

F.A.P. RTE.	SECTION	COUNTY	TOTAL SHEETS	NO.
750	(112) Y, WRS	FAYETTE	52	48
STA.	TO STA.			
FED. ROAD DIST. NO. 7	ILLINOIS	FED. AID PROJECT		

CONTRACT NO. 74080

FINAL SURVEY	DATE
SURVEYED	BY
PLOTTED	
TEMPLATE	
NOTE BOOK	
NO. _____	
AREAS CHECKED	

ORIGINAL SURVEY	DATE
SURVEYED	BY
PLOTTED	
TEMPLATE	
NOTE BOOK	
NO. _____	
AREAS CHECKED	

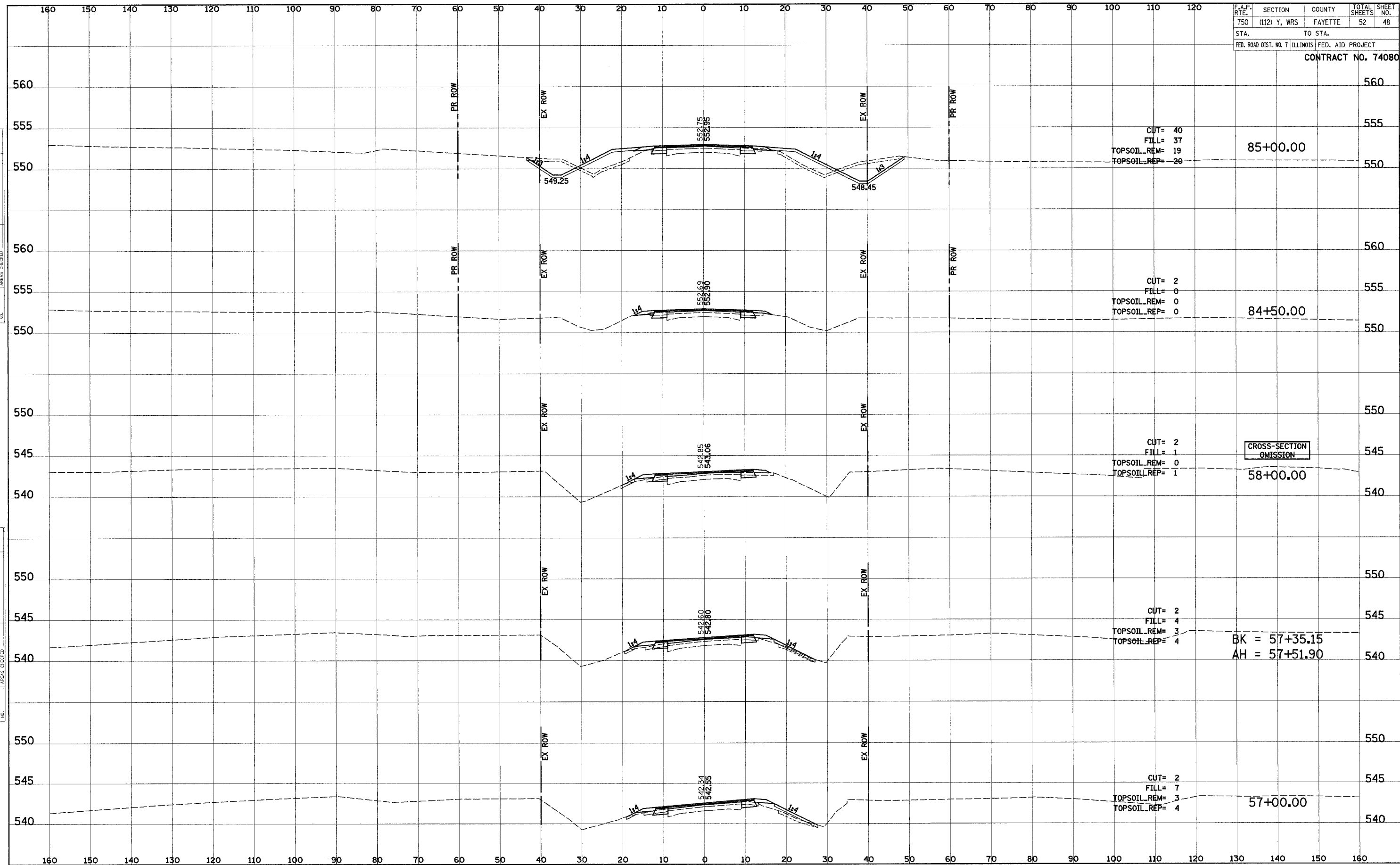

CROSS-SECTION OMISSION

BK = 57+35.15
AH = 57+51.90