

F.A.P. RTE.	SECTION	COUNTY	TOTAL SHEETS	SHEET NO.
774	107 WRS-2, L	EFFINGHAM	127	43
FED. ROAD DIST. NO.		ILLINOIS	FED. AID PROJECT	

CONTRACT NO. 74130

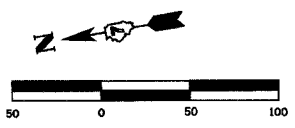

BITUMINOUS SURFACE REMOVAL - BUTT JOINT
STA. 49+90.00 - STA. 50+30.00 107 SO YD

REMOVE PAVEMENT, SUBGRADE AND SHOULDERS AS SCHEDULED.
GRADE TO DRAIN PER CROSS SECTIONS AND/OR AS DIRECTED
BY THE ENGINEER.

PLAN	SURVEYED	BY	DATE
	ALIGNED		
	ADJUSTED		
	RT. OF WAY CHECKED		
	PAID FILE NAME		

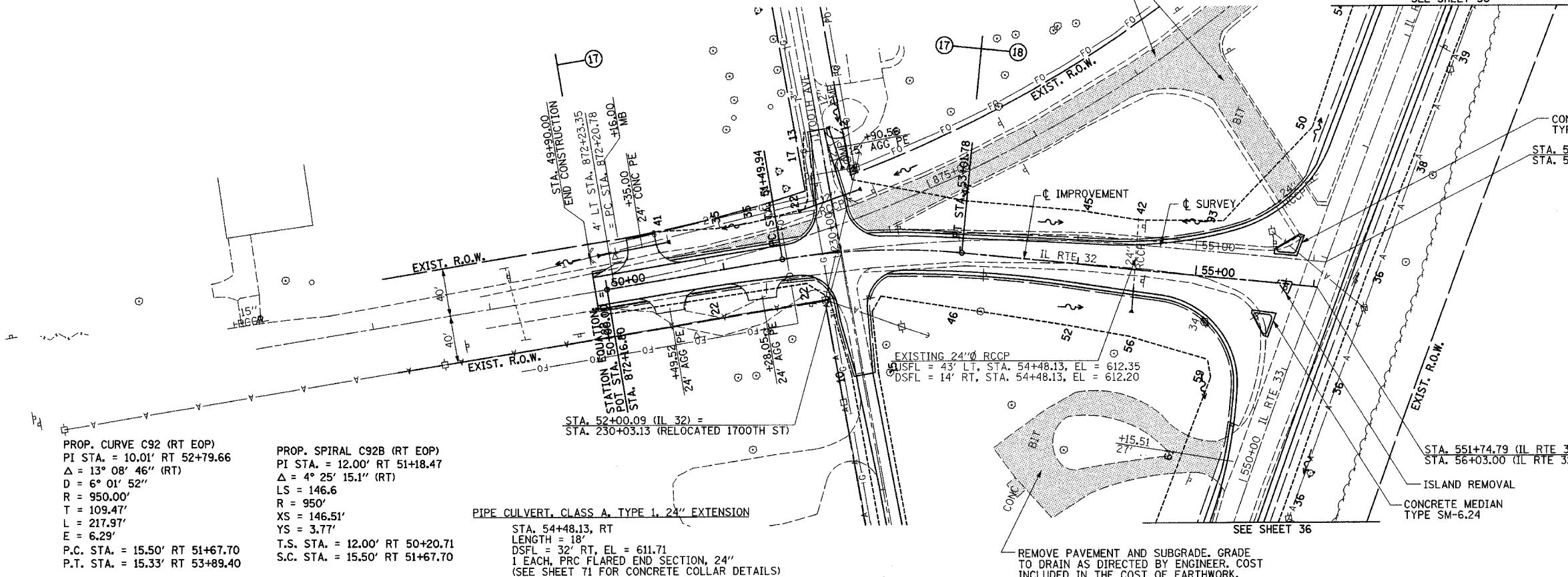

PROP. CURVE C92 (RT EOP)
PI STA. = 10.01' RT 52+79.66
 $\Delta = 13^\circ 08' 46''$ (RT)
D = 6' 01' 52"
R = 950.00'
T = 109.47'
L = 217.97'
E = 6.29'
P.C. STA. = 15.50' RT 51+67.70
P.T. STA. = 15.33' RT 53+89.40

PROP. SPIRAL C92B (RT EOP)
PI STA. = 12.00' RT 51+18.47
 $\Delta = 4^\circ 25' 15.1''$ (RT)
LS = 146.6
R = 950'
XS = 146.51'
YS = 3.77'
T.S. STA. = 12.00' RT 50+20.71
S.C. STA. = 15.50' RT 51+67.70

PIPE CULVERT, CLASS A, TYPE 1, 24" EXTENSION
STA. 54+48.13, RT
LENGTH = 18'
DSFL = 32' RT, EL = 611.71
1 EACH, PRC FLARED END SECTION, 24"
(SEE SHEET 71 FOR CONCRETE COLLAR DETAILS)

PROP. CURVE C98
PI STA. = 52+26.30
 $\Delta = 14^\circ 59' 59''$ (RT)
D = 9' 52' 43"
R = 580.01'
T = 76.36'
L = 151.84'
E = 5.00'
 $e = 4.00\%$
P.C. STA. = 51+49.94
P.T. STA. = 53+01.78
SE ATTAINED STA. 50+20.00 TO STA. 51+90.00
SE REMOVED STA. 52+60.00 TO STA. 54+30.00

FOR IL RTE 32 PROPOSED
EDGE OF PAVEMENT GEOMETRICS
SEE SHEET NO 46 & 47

PROFILE	SURVEYED	BY	DATE
	PLotted		
	CHECKED		
	BY		
	NOTED		
	STRUCTURE NOTATION'S DRWG		

