

**STATE OF ILLINOIS
DEPARTMENT OF TRANSPORTATION
DIVISION OF HIGHWAYS**

**FAI ROUTE 70 (I-55/64/70)
POPLAR STREET BRIDGE APPROACHES
SECTION 82-3HVB-3R-3
PROJECT IM-70
PLANS FOR PROPOSED
ROADWAY REHABILITATION
ST. CLAIR COUNTY**

ROUTE NO.	SECTION	COUNTY	TOTAL SHEETS	SHEET NO.
F.A.I. 70	*	ST. CLAIR	111	24
FED. ROAD DIST. NO. 7	ILLINOIS	FED. AID PROJECT - IM-70		
		* 82-3HVB-3R-3	SHEET S-1 OF S-44	
CONTRACT NO. 76305				

**SET 1 OF
2 SETS**

ENCOMPASSING THE FOLLOWING ROADWAYS
• SN-082-0144 (ROADWAY D)

LOADING HS20-44

SEISMIC DATA

Seismic Performance Category (SPC) = B
Bedrock Acceleration Coefficient (A) = 0.12g
Site Coefficient (S) = 1

DESIGN SPECIFICATIONS

2002 AASHTO
1995 Seismic Retrofitting Manual for
Highway Bridges FHWA-RD-94-052

HIGHWAY CLASSIFICATION

F.A.I. Route 70 - Poplar Street Complex
Functional Class: Collector - Distributor
Roadways
A.D.T.: 3,500 (2,005)
D.H.V.: 100
Design Speed: 50 mph
Posted Speed: 50 mph

DESIGN STRESSES

FIELD UNITS (ORIGINAL)

f_c = 1,400 psi
(Super-, and Sub-structures)
 f_s = 20,000 psi (A36 Structural Steel)
 f_s = 20,000 psi (Reinforcement)
 f_y = 40,000 psi (Reinforcement)

FIELD UNITS (Previous Repair)

f_c = 3,500 psi
 f_y = Varies, 36,000 - 50,000 psi
(Structural Steel)
 f_y = 60,000 psi (Reinforcement)

FIELD UNITS (NEW)

f_c = 4,000 psi
 f_y = 36,000 psi (M270 Grade 36)
 f_y = 50,000 psi (M270 Grade 50)
 f_y = 70,000 psi (M270 Grade HPS 70W)
 f_y = 60,000 psi (Reinforcement)

INDEX OF DRAWINGS

SHEET(S)	TITLE
S-1	TITLE SHEET - ROADWAY D
S-2	GENERAL NOTES
S-3	SCOPE OF WORK
S-4	KEY PLAN
S-5	TOTAL BILL OF MATERIAL
S-6 - S-9	PROJECT PLAN, ELEVATION, AND SECTIONS
S-10 - S-14	TABLES OF ROADWAY ELEVATIONS
S-15 - S-18	DECK AND PARAPET REPAIR PLANS
S-19 - S-23	INFRARED THERMOGRAPHIC MAPPING RESULTS
S-24 - S-26	CONCRETE PARAPET DETAILS
S-27 - S-28	CONCRETE REPAIR DETAILS
S-29 - S-32	EXPANSION JOINT REPAIR DETAILS
S-33 - S-36	DECK DRAINAGE DETAILS
S-37	STEEL PAINTING DETAILS
S-38 - S-39	ELASTOMERIC BEARING REPLACEMENT
S-40 - S-41	FATIGUE RETROFIT DETAILS
S-42 - S-44	SEISMIC ISOLATION DETAILS AND PIER ELEVATIONS

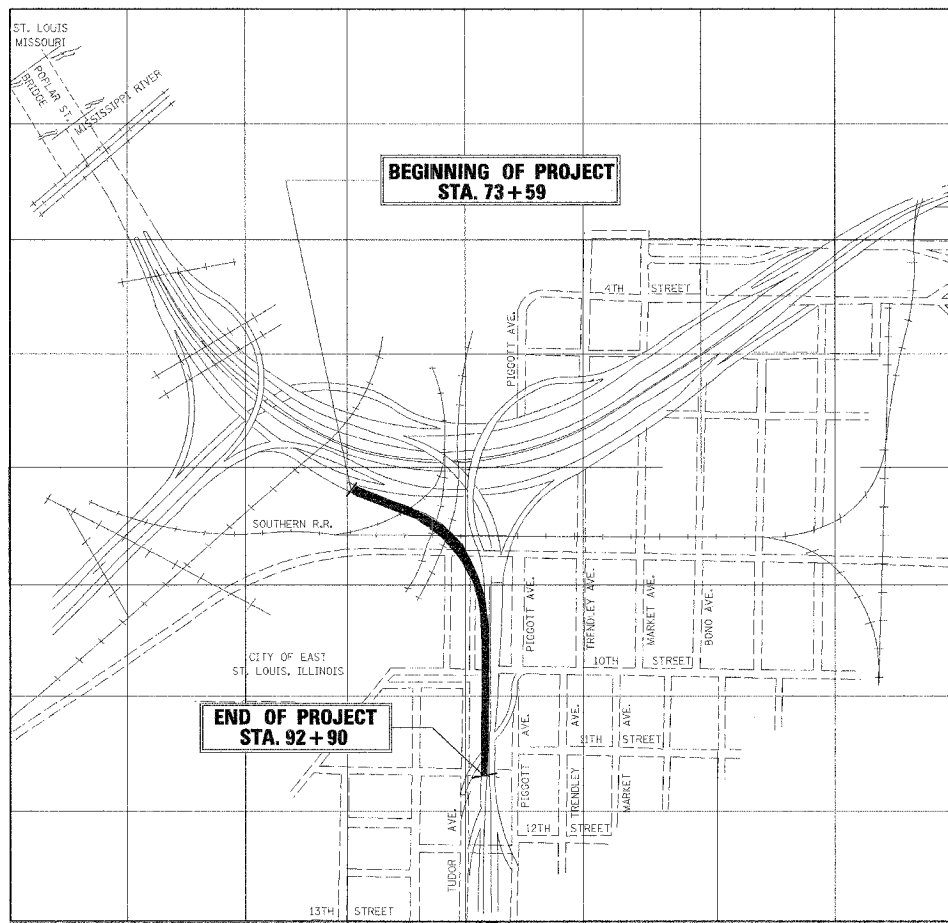
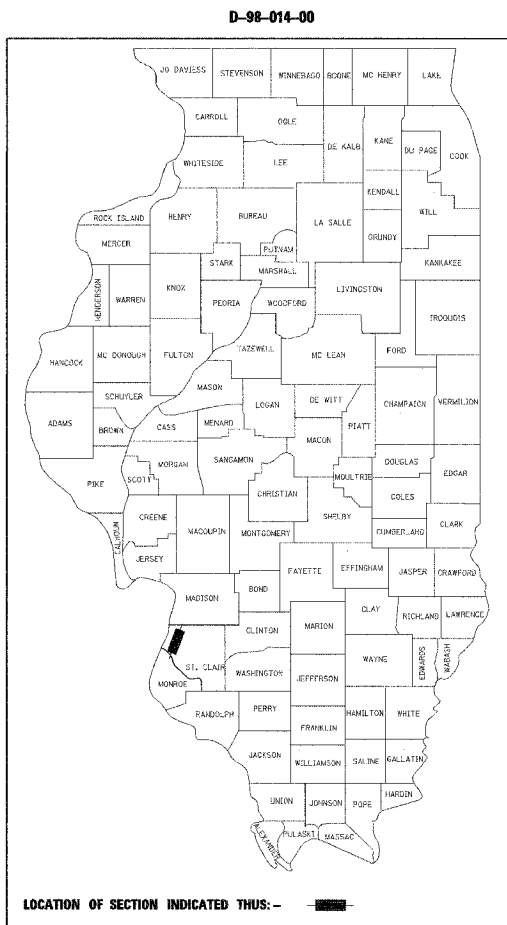

LOCATION PLAN

**STATE OF ILLINOIS
DEPARTMENT OF TRANSPORTATION
DIVISION OF HIGHWAYS**

SUBMITTED _____ 20 _____

DISTRICT ENGINEER

_____ 20 _____

ENGINEER OF PROJECT DEVELOPMENT AND IMPLEMENTATION

_____ 20 _____

ENGINEER OF DESIGN AND ENVIRONMENT

_____ 20 _____

DIRECTOR, DIVISION OF HIGHWAYS

CONTRACT NO. 76305

Howard J. Hill, Ph.D., SE
Illinois Licensed Structural Engineer
License No. 081-004819
License Expires: 11/30/06

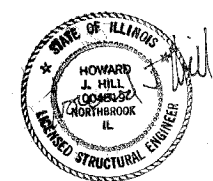

WJE WISS, JANNEY, ELSTNER ASSOCIATES, INC.
Engineers, Architects, Material Scientists
330 PINGSTEN ROAD
NORTHBROOK, ILLINOIS 60062
(847) 272-7400 FAX: (847) 291-4813

DATE: 4/19/2006 FILENAME: P:\2001\1201-1300\2001.1240\Drafting\Roadway\Rehab_DS\Reamp\D_Title.dgn