

ROUTE NO.	SECTION	COUNTY	TOTAL SHEETS	SHEET NO.
F.A.I. 70	*	ST. CLAIR	111	41
FED. ROAD DIST. NO. 7	ILLINOIS	FED. AID PROJECT - IM-79		

\* 82-3HV8-3R-3 SHEET S-18 OF S-44  
 CONTRACT NO. 76305

**SUPERSTRUCTURE BILL OF MATERIAL**

Bar	No.	Size	Length	Shape
a <sub>30</sub> (E)	32	#5	2'-0"	
a <sub>35</sub> (E)	102	#5	3'-0"	
d(E)	218	#4	17'-2"	
a <sub>1</sub> (E)	78	#4	23'-2"	
a <sub>2</sub> (E)	86	#4	22'-2"	
a <sub>4</sub> (E)	54	#4	20'-4"	
b <sub>30</sub> (E)	10	#5	27'-4"	
b <sub>31</sub> (E)	4	#5	27'-4"	
b <sub>32</sub> (E)	15	#5	34'-2"	
b <sub>33</sub> (E)	6	#5	34'-2"	
b <sub>34</sub> (E)	30	#5	31'-0"	
b <sub>35</sub> (E)	12	#5	31'-0"	
b <sub>36</sub> (E)	20	#5	29'-3"	
b <sub>37</sub> (E)	8	#5	29'-3"	
b <sub>41</sub> (E)	111	#4	27'-0"	
b <sub>42</sub> (E)	108	#4	29'-10"	
b <sub>43</sub> (E)	68	#4	27'-10"	
d(E)	482	#5	3'-0"	
d <sub>1</sub> (E)	482	#5	2'-7"	
d <sub>2</sub> (E)	482	#4	3'-0"	
d <sub>6</sub> (E)	58	#4	3'-4"	
d <sub>7</sub> (E)	424	#4	3'-2"	
e <sub>75</sub> (E)	54	#4	35'-0"	
e <sub>76</sub> (E)	6	#4	19'-1"	
e <sub>77</sub> (E)	6	#4	31'-4"	
e <sub>78</sub> (E)	6	#4	21'-11"	
e <sub>79</sub> (E)	6	#4	19'-10"	
e <sub>80</sub> (E)	6	#4	23'-0"	
e <sub>81</sub> (E)	6	#4	22'-1"	
e <sub>82</sub> (E)	18	#5	35'-0"	
e <sub>83</sub> (E)	2	#5	19'-7"	
e <sub>84</sub> (E)	2	#5	32'-4"	
e <sub>85</sub> (E)	2	#5	22'-11"	
e <sub>86</sub> (E)	2	#5	20'-10"	
e <sub>87</sub> (E)	2	#5	23'-6"	
e <sub>88</sub> (E)	2	#5	22'-7"	
e <sub>89</sub> (E)	18	#8	35'-0"	
e <sub>90</sub> (E)	2	#8	37'-0"	
e <sub>91</sub> (E)	2	#8	6'-6"	
e <sub>92</sub> (E)	2	#8	27'-7"	
e <sub>93</sub> (E)	2	#8	25'-6"	
e <sub>94</sub> (E)	2	#8	25'-10"	
e <sub>95</sub> (E)	2	#8	24'-11"	
Reinforcement Bars, Epoxy Coated			Pound	24,120
Bar Splicer			Ea.	218
Concrete Removal			Cu. Yd.	114.7
Concrete Superstructure			Cu. Yd.	108.4
Bituminous Concrete Removal - (Deck)			Sq. Yd.	812
Bridge Deck Hydro-Scarification - 2"			Sq. Yd.	812
Bridge Deck Microsilica Concrete Overlay - 4"			Sq. Yd.	871
Drainage Scuppers - DS12			Ea.	8
Protective Coat			Sq. Yd.	1,229
Bridge Deck Grooving			Sq. Yd.	871
Bituminous Concrete Curb Removal			Foot	7.5
Protective Shield			Sq. Yd.	370
Mechanical Splice			Ea.	70

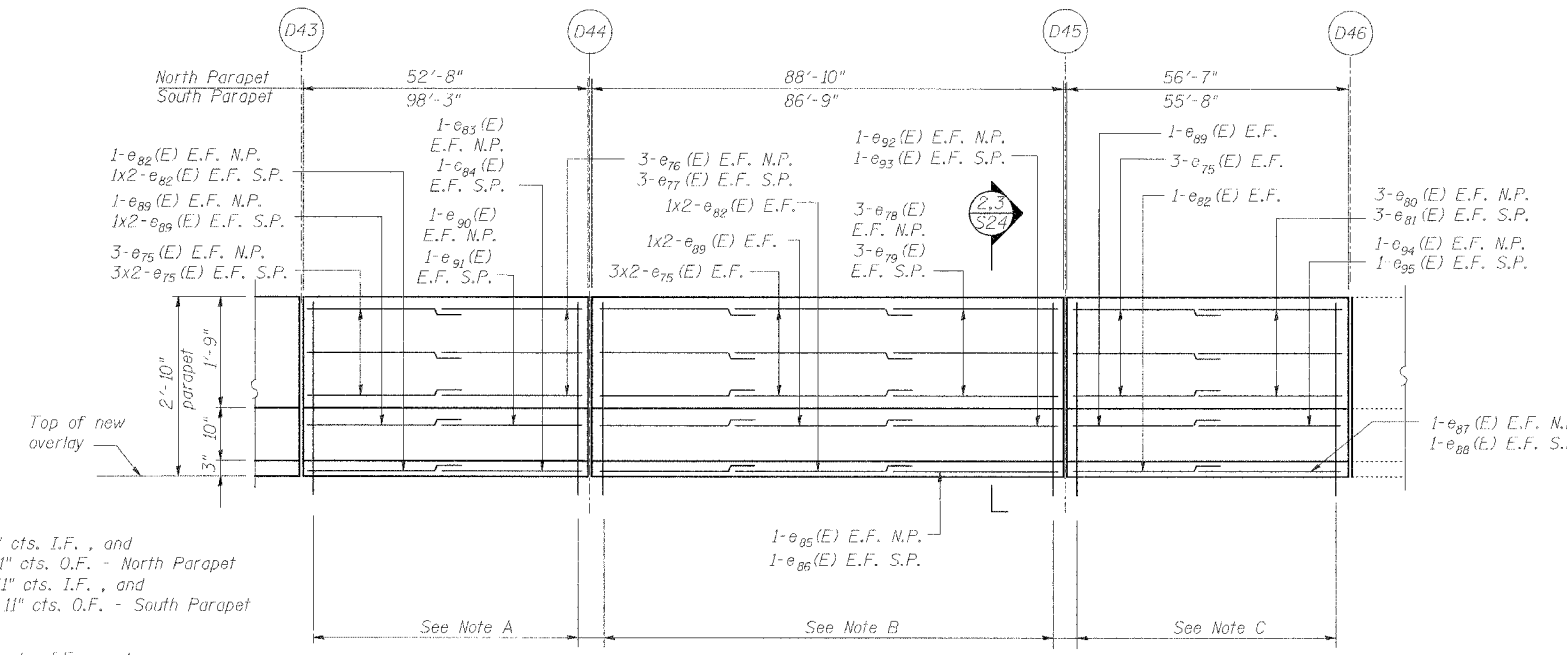

**Note A:**  
 58 - d(E) and 58 - d<sub>1</sub>(E) @ 11" cts. I.F., and  
 58 - d<sub>2</sub>(E) and 58 - d<sub>6</sub>(E) @ 11" cts. O.F. - North Parapet  
 108 - d(E) and 108 - d<sub>1</sub>(E) @ 11" cts. I.F., and  
 108 - d<sub>2</sub>(E) and 108 - d<sub>7</sub>(E) @ 11" cts. O.F. - South Parapet

**Note B:**  
 97 - d(E) and 97 - d<sub>1</sub>(E) @ 11" cts. I.F., and  
 97 - d<sub>2</sub>(E) and 97 - d<sub>7</sub>(E) @ 11" cts. O.F. - North Parapet  
 95 - d(E) and 95 - d<sub>1</sub>(E) @ 11" cts. I.F., and  
 95 - d<sub>2</sub>(E) and 95 - d<sub>7</sub>(E) @ 11" cts. O.F. - South Parapet

**Note C:**  
 62 - d(E) and 62 - d<sub>1</sub>(E) @ 11" cts. I.F., and  
 62 - d<sub>2</sub>(E) and 62 - d<sub>7</sub>(E) @ 11" cts. O.F.

**INSIDE ELEVATION OF NORTH PARAPET**

South parapet similar except as noted  
 All dimensions measured along bottom of inside face of parapet  
 E.F. indicates each face  
 I.F. indicates inside face  
 O.F. indicates outside face

#4	1'-8"
#5	2'-2"
#6	2'-7"
#8	4'-6"

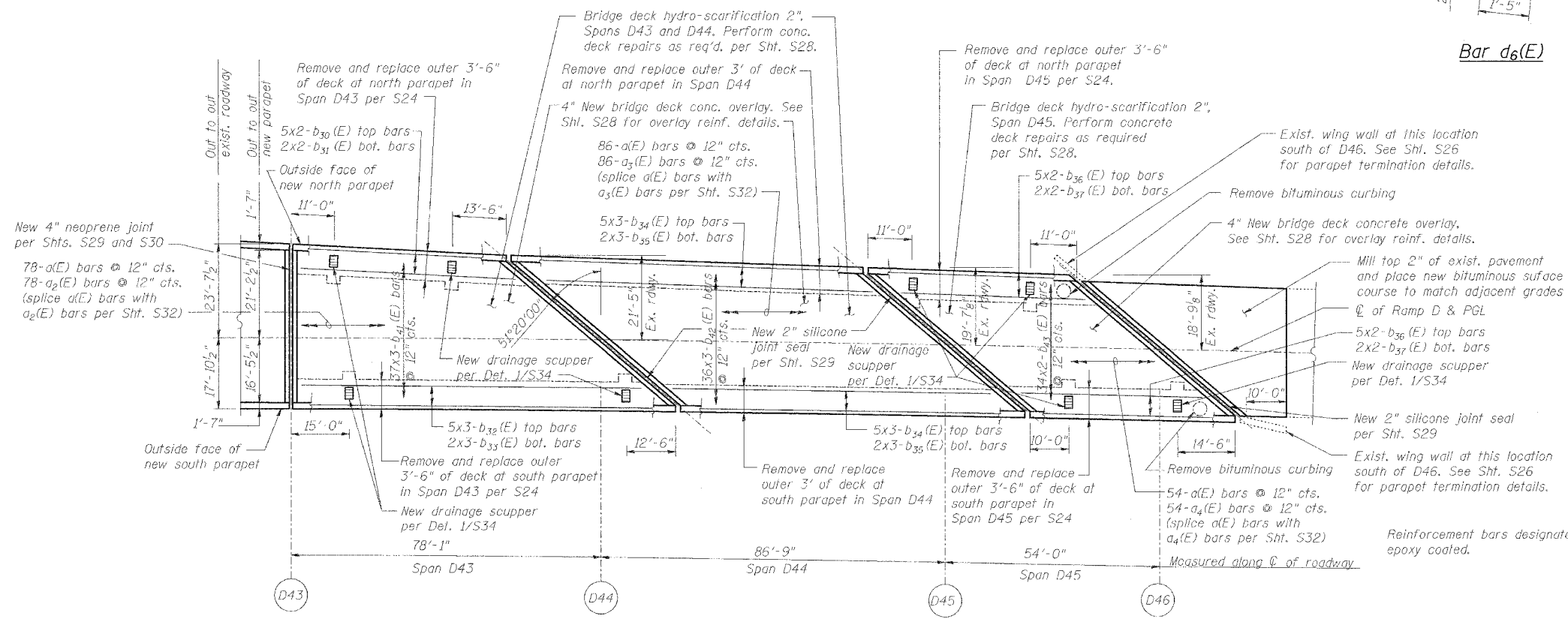
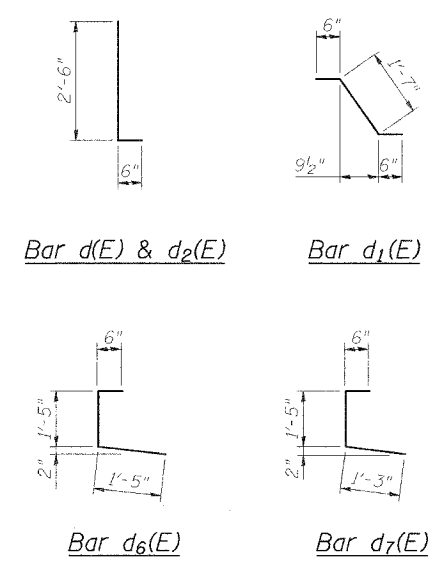

**DECK & PARAPET REPAIRS - SPANS D43 - D45**

REVISIONS	
NAME	DATE

STATE OF ILLINOIS  
 DEPARTMENT OF TRANSPORTATION  
 REHABILITATION AND RETROFIT REPAIRS  
 FAI ROUTE 70  
 POPLAR STREET BRIDGE APPROACHES  
 ST. CLAIR COUNTY

STRUCTURE NO. 082-0142 (RAMP) S1  
 SCALE:  
 DATE: 02/28/2006

**Note:**  
 Cut bars in field to fit skew and use the remainder of bars at other end of deck.  
 Reinforcement bars designated (E) shall be epoxy coated.

DATE: 4/9/2006 FILENAME: P:\2001\1201-1300\2001.1240\drafting\roadway\rehab\_ds\parapet\parapet-deck.d dp4345.dgn

DESIGNED	JPD
CHECKED	JEL
DRAWN	CLK
CHECKED	JPD

**DECK PLAN OF SPANS D43 - D45**

