

| ROUTE NO. | SECTION | COUNTY | TOTAL SHEETS | SHEET NO. |
|-----------------------|----------|-------------------------|--------------|-----------|
| F.A.I. 70 | * | ST. CLAIR | 111 | 71 |
| FED. ROAD DIST. NO. 7 | ILLINOIS | FED. AID PROJECT- IH-70 | | |

* 82-3HVB-3R-3 SHEET S-4 OF S-44
CONTRACT NO. 76305

D-98-014-00

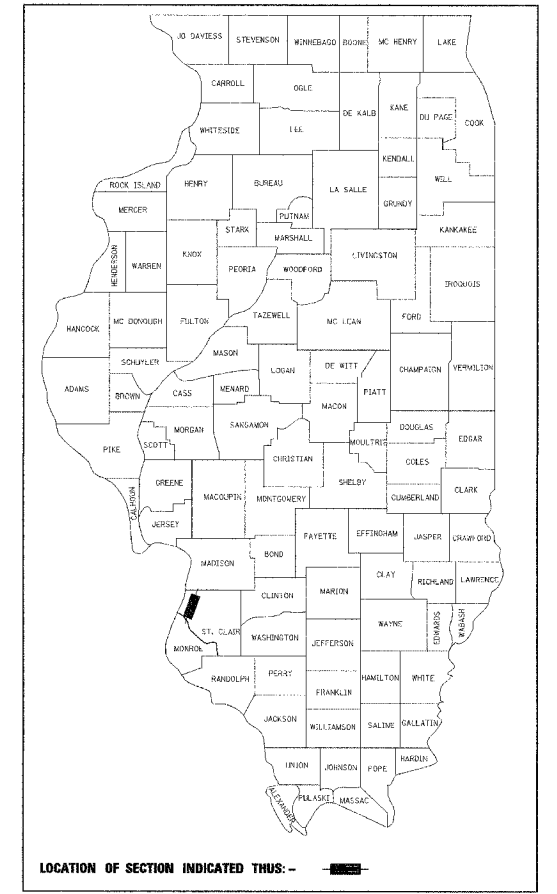

LOCATION OF SECTION INDICATED THUS: - [rectangle] -

LOCATION SKETCH

OVERALL PROJECT PLAN

| Roadway / Ramp | Segment / Pier No. | Structure No. | Year / Structure Type |
|----------------|--------------------|---------------|------------------------|
| S | G12-S23 | 082-0142 | 1967 Two Girder System |
| G | G14-G12 | 082-0254 | 1967 Two Girder System |

KEY PLAN

STATE OF ILLINOIS
DEPARTMENT OF TRANSPORTATION
REHABILITATION AND RETROFIT REPAIRS
FAI ROUTE 70
POPLAR STREET BRIDGE APPROACHES
ST. CLAIR COUNTY

STRUCTURE NO. 082-0142 (RAMP S)

SCALE:

DATE: 02/28/2006

| REVISIONS | |
|-----------|------|
| NAME | DATE |
| | |
| | |
| | |
| | |
| | |

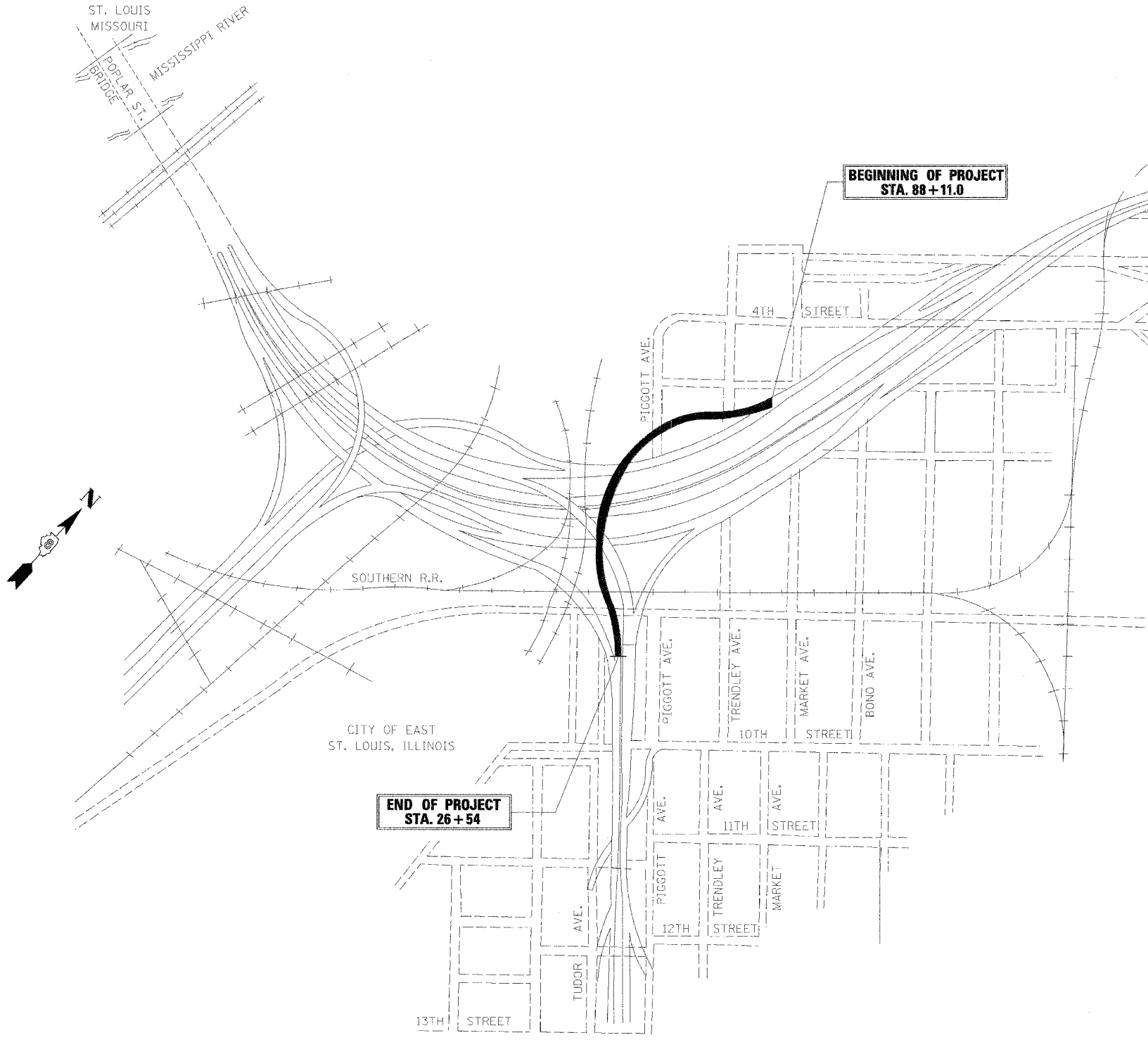

DATE: 4/19/2006
FILENAME: p:\2001\1201-1300\2001.1240\drafting\roadwayrehab_db\rapms\rapms_keypl.dgn

| | |
|----------|---------|
| DESIGNED | VARIOUS |
| CHECKED | HH |
| DRAWN | CLK |
| CHECKED | JEL |