

ROUTE NO.	SECTION	COUNTY	TOTAL SHEETS	SHEET NO.
F.A.I. 70	*	ST. CLAIR	111	86
FED. ROAD DIST. NO. 7	ILLINOIS	FED. AID PROJECT - IM-78		

* 82-3HVB-3R-3 SHEET S-19 OF S-44
 CONTRACT NO. 76305

SUPERSTRUCTURE BILL OF MATERIAL

Bar	No.	Size	Length	Shape
$d_{11}(E)$	8	#5	2'-0"	
$d_{12}(E)$	40	#5	3'-0"	
$b_1(E)$	85	#5	40'-0"	
$b_2(E)$	38	#5	40'-0"	
$b_3(E)$	20	#6	40'-0"	
$b_{23}(E)$	5	#5	28'-5"	
$b_{24}(E)$	5	#5	10'-3"	
$b_{25}(E)$	2	#5	28'-5"	
$b_{26}(E)$	2	#5	10'-3"	
$d(E)$	757	#5	3'-0"	
$d_1(E)$	757	#5	2'-7"	
$d_2(E)$	757	#4	3'-0"	
$d_3(E)$	757	#4	2'-7"	
$d_4(E)$	3	#6	4'-8"	
$d_5(E)$	5	#6	8'-11"	
$e_{100}(E)$	72	#4	35'-0"	
$e_{101}(E)$	60	#4	17'-9"	
$e_{102}(E)$	6	#4	24'-10"	
$e_{103}(E)$	6	#4	20'-4"	
$e_{104}(E)$	6	#4	23'-10"	
$e_{105}(E)$	6	#4	19'-4"	
$e_{106}(E)$	6	#4	13'-10"	
$e_{107}(E)$	6	#4	10'-6"	
$e_{108}(E)$	24	#5	35'-0"	
$e_{109}(E)$	20	#5	17'-9"	
$e_{110}(E)$	2	#5	25'-10"	
$e_{111}(E)$	2	#5	21'-4"	
$e_{112}(E)$	2	#5	24'-10"	
$e_{113}(E)$	2	#5	20'-4"	
$e_{114}(E)$	2	#5	14'-10"	
$e_{115}(E)$	2	#5	11'-6"	
$e_{116}(E)$	24	#8	35'-0"	
$e_{117}(E)$	20	#8	17'-9"	
$e_{118}(E)$	2	#8	30'-6"	
$e_{119}(E)$	2	#8	26'-0"	
$e_{120}(E)$	2	#8	29'-6"	
$e_{121}(E)$	2	#8	25'-0"	
$e_{122}(E)$	2	#8	19'-6"	
$e_{123}(E)$	2	#8	16'-2"	
Reinforcement Bars, Epoxy Coated	Pound		22,360	
Concrete Removal	Cu. Yd.		164.0	
Concrete Superstructure	Cu. Yd.		147.9	
Bituminous Concrete Removal - (Deck)	Sq. Yd.		848	
Bridge Deck Hydro-Scarification - 1/2"	Sq. Yd.		848	
Bridge Deck Microsilica Concrete Overlay - 2 1/2"	Sq. Yd.		960	
Drainage Scuppers - DS12	Ea.		?	
Protective Coat	Sq. Yd.		1,527	
Bridge Deck Grooving	Sq. Yd.		960	
Protective Shield	Sq. Yd.		560	
Mechanical Splice	Ea.		34	

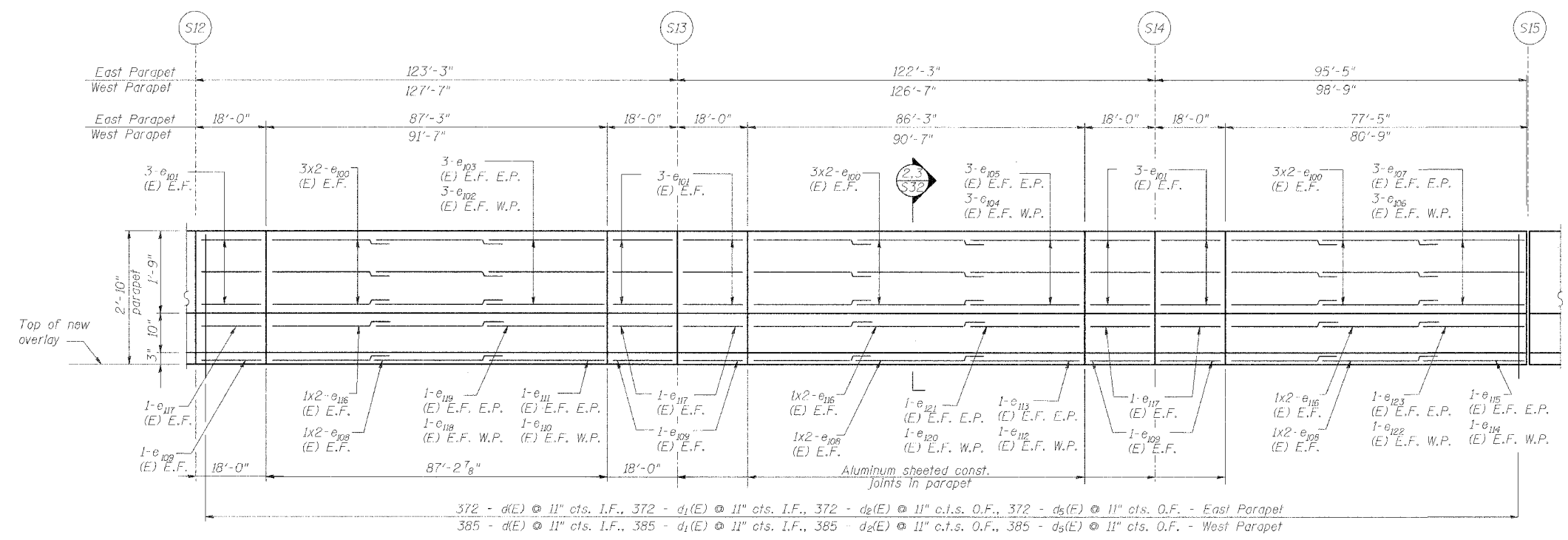

INSIDE ELEVATION OF EAST PARAPET

West Parapet similar except as noted
 All dimensions measured along bottom of inside face of parapet
 E.F. indicates each face
 I.F. indicates inside face
 O.F. indicates outside face

Min Bar Laps

#4	1'-8"
#5	2'-2"
#6	2'-7"
#8	4'-6"

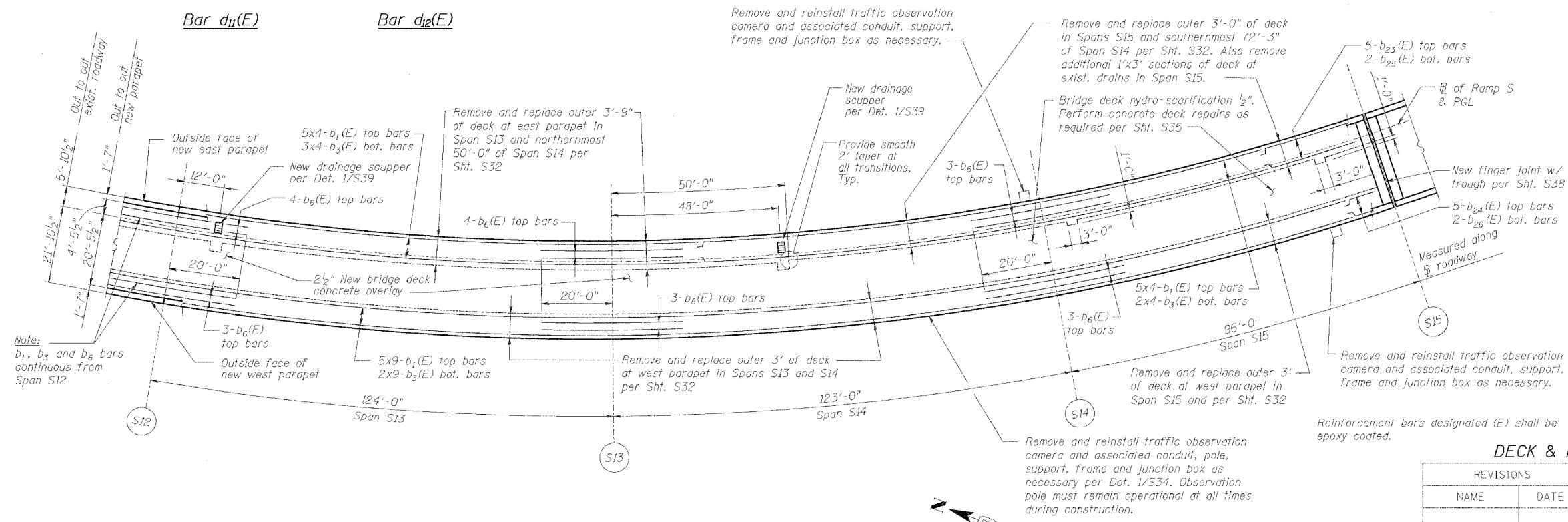
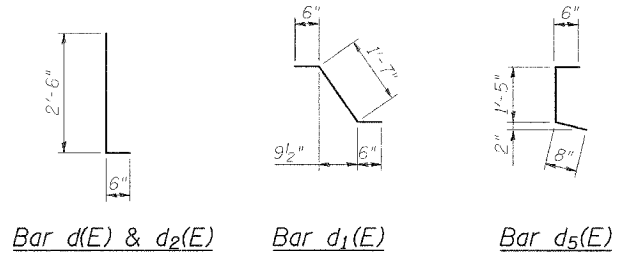
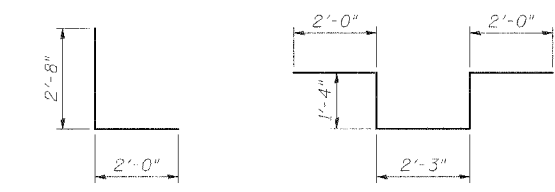

DECK PLAN OF SPANS S13 - S15

DECK & PARAPET REPAIRS - SPANS S13 - S15

REVISIONS	
NAME	DATE

STATE OF ILLINOIS
 DEPARTMENT OF TRANSPORTATION
 REHABILITATION AND RETROFIT REPAIRS
 FAT ROUTE 70
 POPLAR STREET BRIDGE APPROACHES
 ST. CLAIR COUNTY

STRUCTURE NO. 082-0142 (RAMP S)
 SCALE:
 DATE: 02/28/2006

DATE: 4/19/2006
 FILENAME: P:\2001\1201-1300\2001.1240\drafting\roadwayrehab_ds\parapet-deck\p1315.dgn

DESIGNED	JPD
CHECKED	JEL
DRAWN	CLK
CHECKED	JPD/JEL