

F.A.U. R.T.E.	SECTION	COUNTY	TOTAL SHEETS	SHEET NO.
3580	04-00043-00-TL	WILL	54	49
STA.	TO STA.			
FED. ROAD DIST. NO.	ILLINOIS FED. AID PROJECT			
CONTRACT NO.: 83855				

RESTORATION OF WORK AREA, RESTORATION OF THE TRAFFIC SIGNAL WORK AREA SHALL BE INCIDENTAL TO THE RELATED PAY ITEM SUCH AS FOUNDATION, CONDUIT, HANDHOLE, TRENCH AND BACKFILL, ETC., AND NO EXTRA COMPENSATION SHALL BE ALLOWED. ALL ROADWAY SURFACES SUCH AS SHOULDERS, MEDIANS, SIDEWALKS, PAVEMENT, ETC. SHALL BE REPLACED IN KIND. ALL DAMAGE TO MOWED LAWNS SHALL BE REPLACED WITH AN APPROVED SOD, AND ALL DAMAGE TO UNMOWED FIELDS SHALL BE SEEDING IN ACCORDANCE WITH STANDARD SPECIFICATIONS 252 AND 250 RESPECTIVELY.

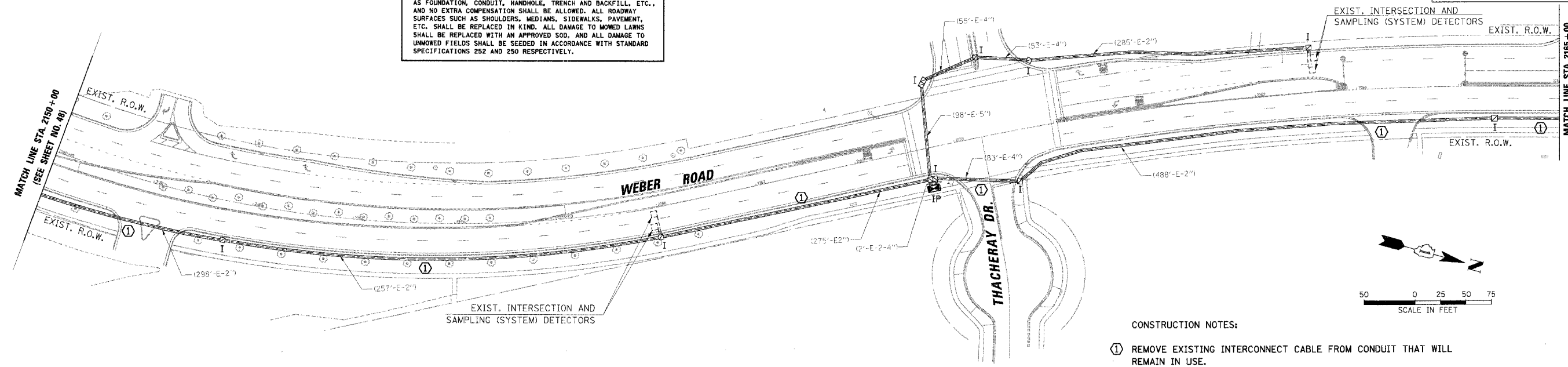

CONSTRUCTION NOTES:
 ① REMOVE EXISTING INTERCONNECT CABLE FROM CONDUIT THAT WILL REMAIN IN USE.

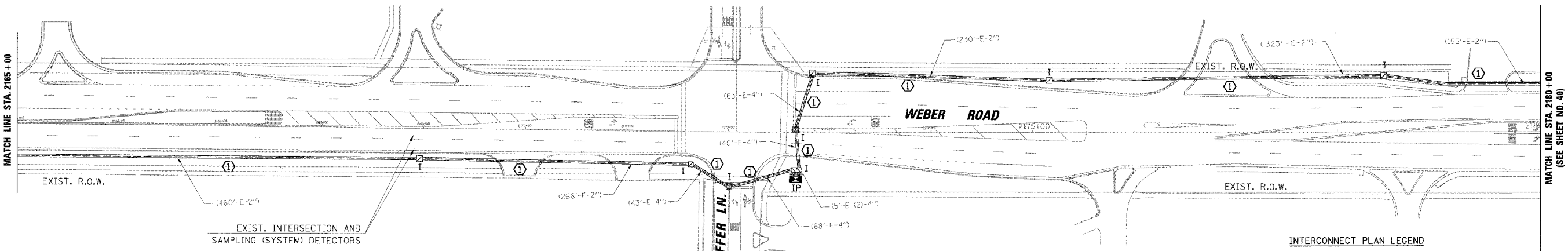

INTERCONNECT PLAN LEGEND

	PROPOSED	EXISTING
CONTROLLER		
HANDHOLE		
DOUBLE HANDHOLE		
HEAVY-DUTY HANDHOLE		
G.S. CONDUIT IN TRENCH (T) OR PUSHED (P)		
DETECTOR LOOP		
SYSTEM	S	I
INTERSECTION	IP	I
UNIT DUCT	UD	
COMMON TRENCH	CT	

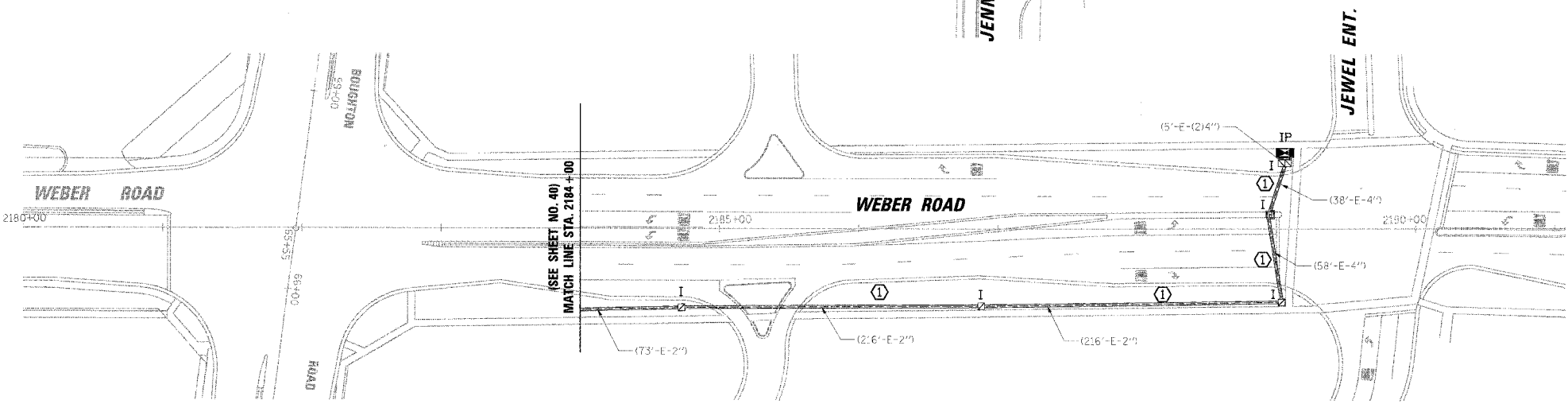

REVISIONS	NAME	DATE

ILLINOIS DEPARTMENT OF TRANSPORTATION
INTERCONNECT PLAN
 WEBER ROAD
 BOLINGBROOK, ILLINOIS
 SCALE: 1" = 50'
 DATE: 4/7/2006
 DRAWN BY: FCP/FPB
 DESIGNED BY: MKW
 CHECKED BY: MJT

DATE: _____ BY: _____
 SUPERVISOR: _____
 ALTERNATE CHECKED: _____
 RT. OF WAY CHECKED: _____
 CADD FILE NAME: _____
 PLAN: _____
 NOTE BOOK NO.: _____
 CHRISTOPHER B. BURKE ENGINEERING LTD.
 9575 West Higgins Road, Suite 600
 Rosemont, Illinois 60018
 (630) 823-9500
 PROFILE: _____
 DATE: _____ BY: _____
 SUPERVISOR: _____
 ALTERNATE CHECKED: _____
 RT. OF WAY CHECKED: _____
 CADD FILE NAME: _____