

F.A. RTE.	SECTION	COUNTY	TOTAL SHEETS	SHEET NO.
303	03-00520-00-WR	WINNEBAGO	254	42
STA. 200+00 TO STA. 206+00				
FED. ROAD DIST. NO.	ILLINOIS	FED. AID PROJECT		



WISCONSIN ROAD MAY BE CLOSED TO ALL TRAFFIC. ACCESS TO BE PROVIDED FROM THE NORTH. SIGNAGE AT WISCONSIN ROAD AND SEWARD AVENUE SHALL BE IN ACCORDANCE WITH BLR STANDARD 22. RH-4 SIGNAGE SHALL BE POSTED ON THE TYPE III BARRICADES. AT NO TIME SHALL OHIO PARKWAY, WISCONSIN ROAD, AND COLORADO AVENUE BE CLOSED TOGETHER. ONLY ONE OF THESE STREETS MAY BE CLOSED TO TRAFFIC AT ANY ONE TIME.

MAINTAIN ACCESS TO LOCAL RESIDENCES ALONG HARRISON AVENUE AT ALL TIMES. USE TEMPORARY GRANULAR SURFACE AS NECESSARY.

PLAN	DATE	BY
DESIGNED		
PROFILING		
ALIGNED		
CHECKED		
NO.		

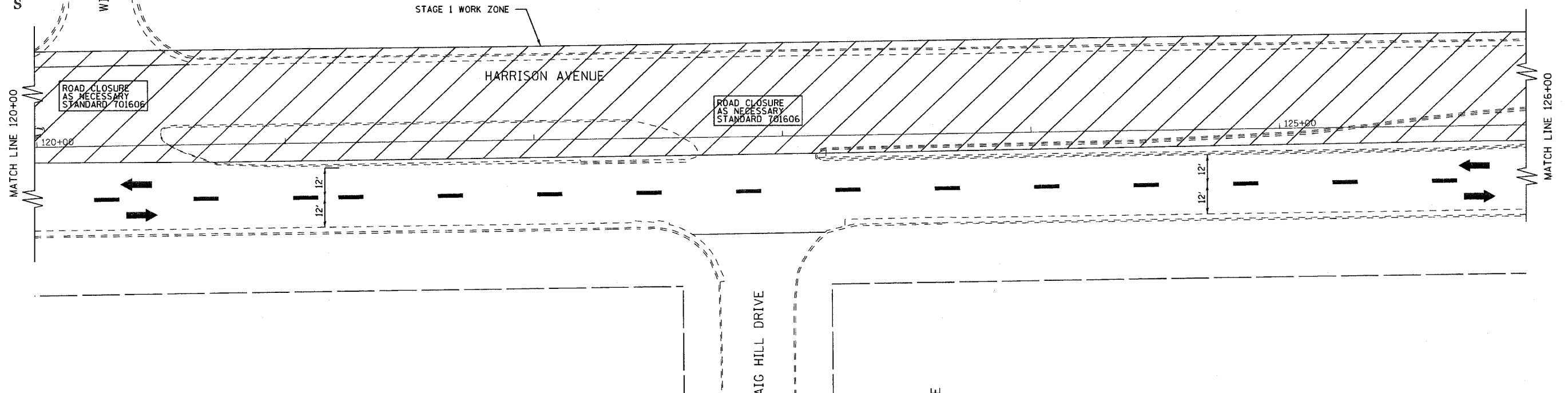

MAINTAIN ACCESS TO LOCAL RESIDENCES ALONG HARRISON AVENUE AT ALL TIMES. USE TEMPORARY GRANULAR SURFACE AS NECESSARY.

COLORADO AVENUE MAY BE CLOSED TO ALL TRAFFIC. ACCESS TO BE PROVIDED FROM THE NORTH. SIGNAGE AT COLORADO AVENUE AND SEWARD AVENUE SHALL BE IN ACCORDANCE WITH BLR STANDARD 22. RH-4 SIGNAGE SHALL BE POSTED ON THE TYPE III BARRICADES. AT NO TIME SHALL OHIO PARKWAY, WISCONSIN ROAD, AND COLORADO AVENUE BE CLOSED TOGETHER. ONLY ONE OF THESE STREETS MAY BE CLOSED TO TRAFFIC AT ANY ONE TIME.

PROFILE	DATE	BY
DESIGNED		
PROFILING		
CHECKED		
NO.		

