

ROUTE NO.	SECTION	COUNTY	SHEET NO.	TOTAL SHEETS
	17	WOODFORD	8	

* Section 02-08143-00-BR
CONTRACT NO. 89390

DATE: 04/13/06

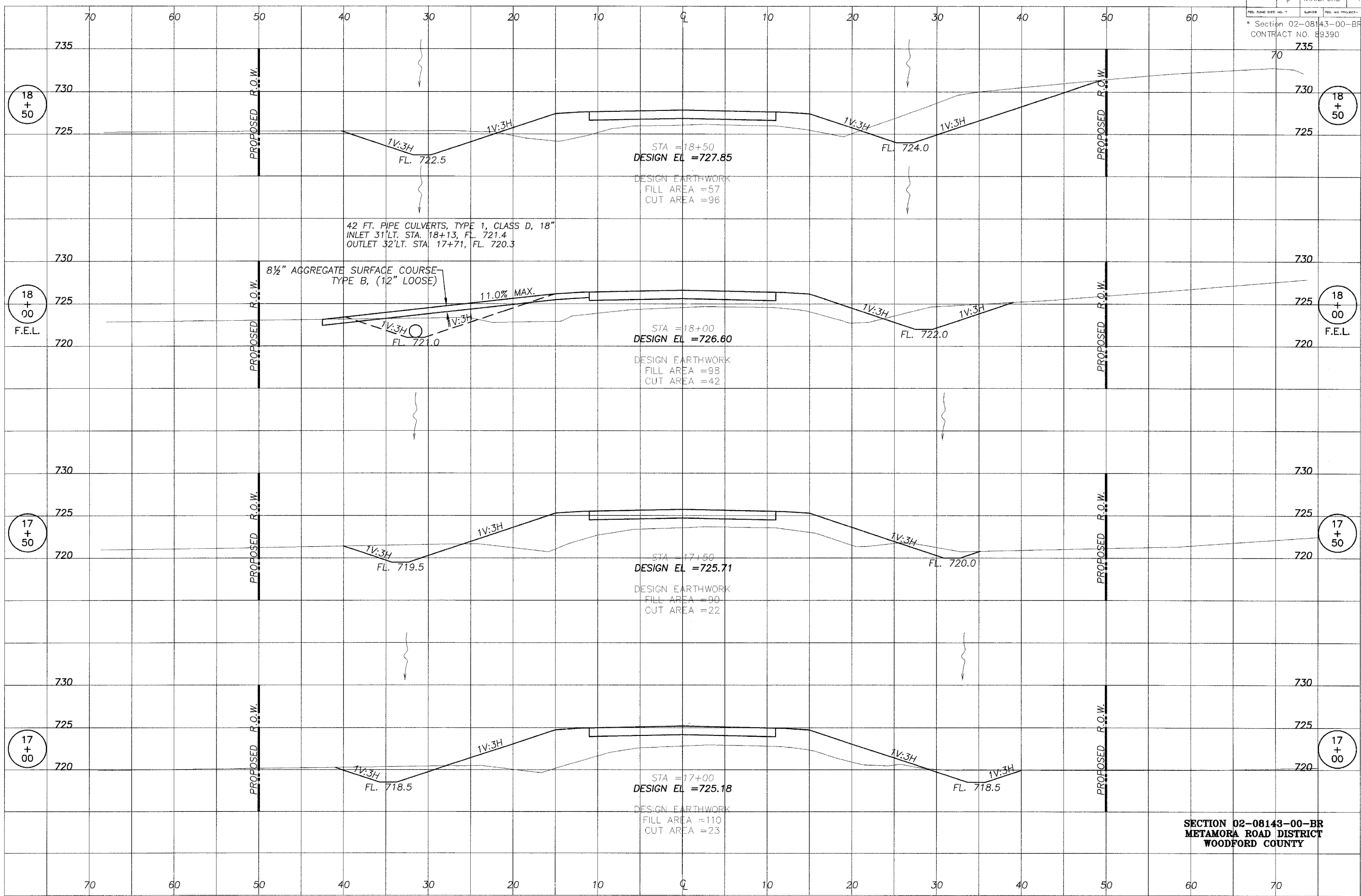

42 FT. PIPE CULVERTS, TYPE 1, CLASS D, 18"
INLET 31' LT. STA. 18+13, FL. 721.4
OUTLET 32' LT. STA. 17+71, FL. 720.3

8 1/2" AGGREGATE SURFACE COURSE -
TYPE B, (12" LOOSE)

11.0% MAX.

SECTION 02-08143-00-BR
METAMORA ROAD DISTRICT
WOODFORD COUNTY

698 TIMBER CREEK ROAD - P.O. BOX 486 - DIXON, IL 61021 - 815-288-2261
28 E. MARION - SUITE 3 - PRINCETON, IL 61556 - 815-879-4731
1778 WEST STATE ST. - STICAMORE, IL 60178 - 815-885-5008
804 FREEMONT RD. - STERLING, IL 61081 - (815) 626-4428
E-MAIL: info@wendler.net

WENDLER ENGINEERING SERVICES, INC.
Structural & Civil Engineers - Land Surveying - Environmental Services
Illinois Professional Design Firm No. 184-000848



1968 - 2005
AFTER
37
YEARS,
WE'RE STILL
Turning Ideas
Into Reality!