

SEC. 29, T. 19 N., R. 8 E., 3rd P.M.

F.A.I. RTE.	SECTION	COUNTY	TOTAL SHEETS	SHEET NO.
57	10-32HB-3,K	CHAMPAIGN	352	57
STA. 253+00		TO STA. 259+00		
FED. ROAD DIST. NO.		ILLINOIS FED. AID PROJECT		
CONTRACT NO. 90758				

INLET AND PIPE PROTECTION
 STA. 255+38 LT.
 STA. 257+45 RT.

PERIMETER EROSION BARRIER
 EXPLORATION TRENCH

PROPOSED R.O.W. LINE &
 CONSTRUCTION LIMITS

PIPE CULVERT, CLASS D, TYPE 1, ERS 30" - 66.0 FEET
 END SECTIONS, ERS 30" - 2 EACH
 STA. 255+38.56, 35.35' LT., U.S.F.L. = 698.83
 STA. 254+72.69, 37.84' LT., D.S.F.L. = 698.63

EXISTING 32"x15" CMP
 PIPE CULVERT REMOVAL - 32 FEET

257+00
 46.18' LT.

SECTION 10-32HB-3, K ENDS
 STA. 257+00 (STALEY ROAD)

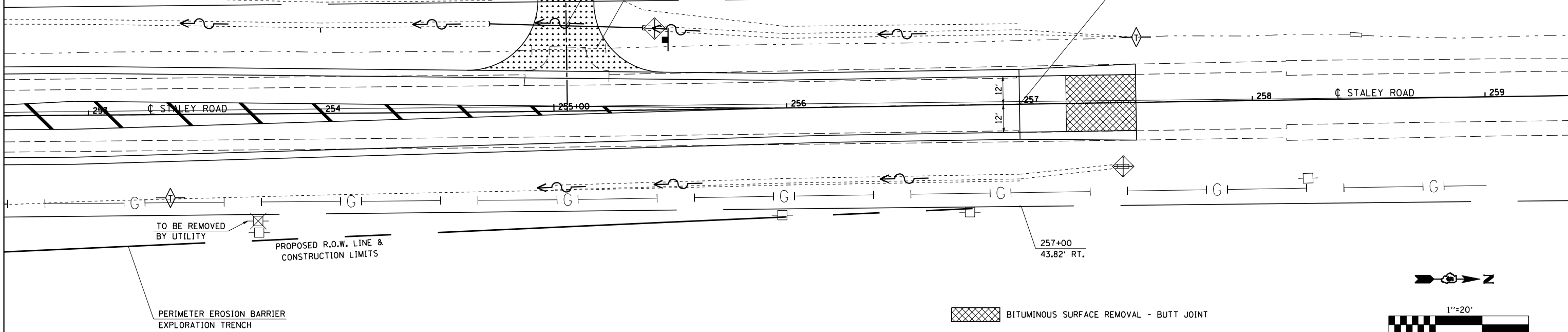

TO BE REMOVED
 BY UTILITY

PROPOSED R.O.W. LINE &
 CONSTRUCTION LIMITS

PERIMETER EROSION BARRIER
 EXPLORATION TRENCH

BITUMINOUS SURFACE REMOVAL - BUTT JOINT

AGGREGATE SURFACE COURSE, TYPE B 6"

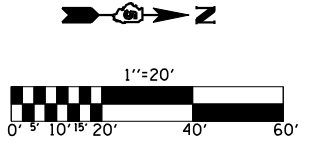

SEC. 28, T. 19 N., R. 8 E., 3rd P.M.

**SEE SIGNING PLANS
 FOR DETAILS**

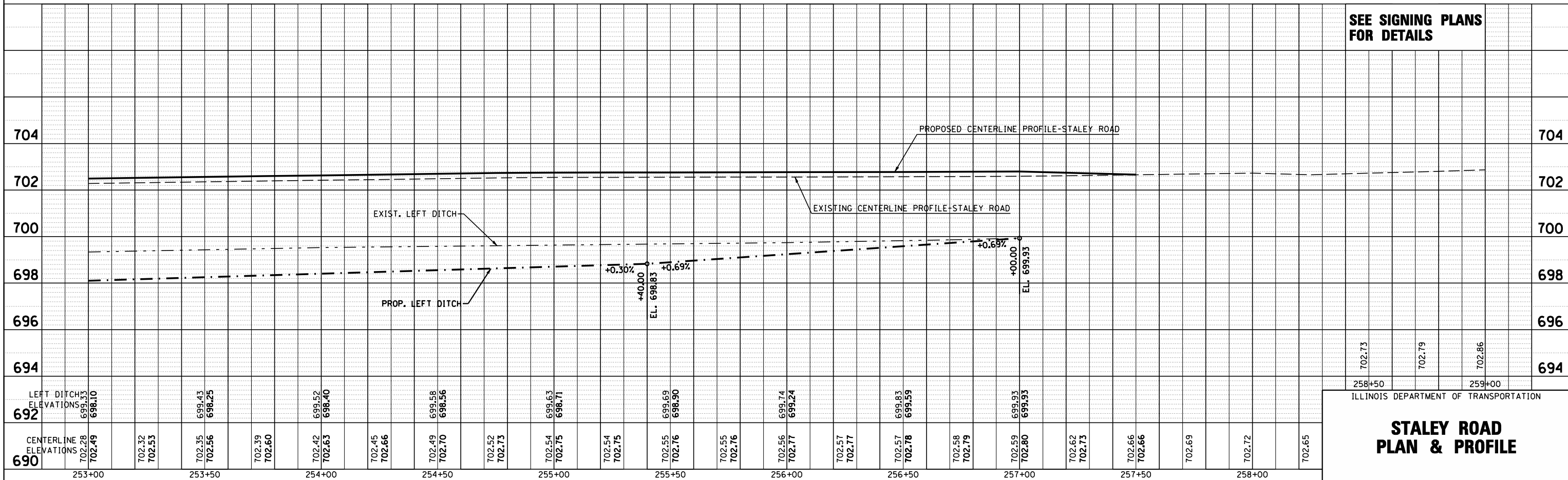

ILLINOIS DEPARTMENT OF TRANSPORTATION

**STALEY ROAD
 PLAN & PROFILE**

PLAN	DATE
BY	
CHECKED	
NO. OF WAY CHECKED	
CADD FILE NAME	

PROFILE	DATE
BY	
CHECKED	
NO. NOTED	
STRUCTURE NOTATIONS CHRD	