

**STATE OF ILLINOIS**  
**DEPARTMENT OF TRANSPORTATION**  
**DIVISION OF HIGHWAYS**  
**RIGHT OF WAY PLANS**  
**FOR PROPOSED**  
**FEDERAL AID HIGHWAY**

RTE.	SECTION	COUNTY	TOTAL SHEETS	SHEET NO.
FAI 57	10-32HB-3,K	CHAMPAIGN	4	1
F.H.W.A. REG.	ILLINOIS	PROJECT		

**REGION 3 / DISTRICT 5**

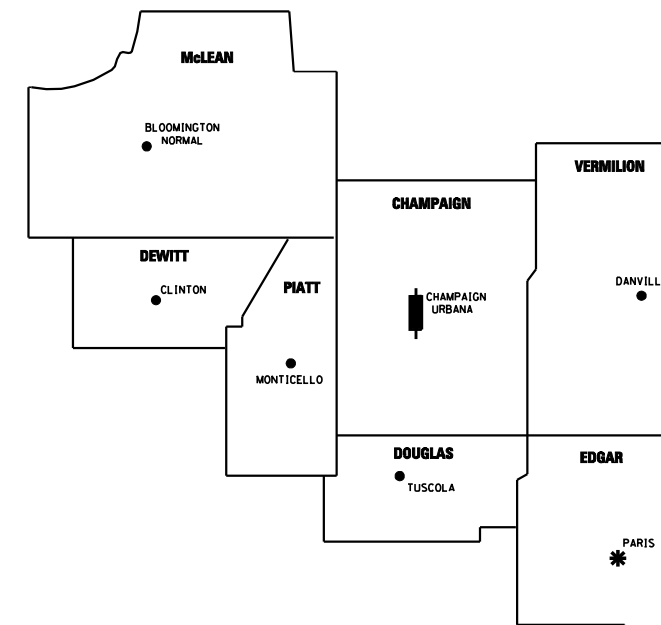

\* DISTRICT HEADQUARTERS  
 ■ PROJECT LOCATION

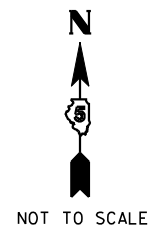

**FAI ROUTE 57**  
**SECTION 10-32HB-3,K**  
**JOB R-95-060-04**  
**CHAMPAIGN COUNTY**

R. 8 E. OF 3RD P.M.

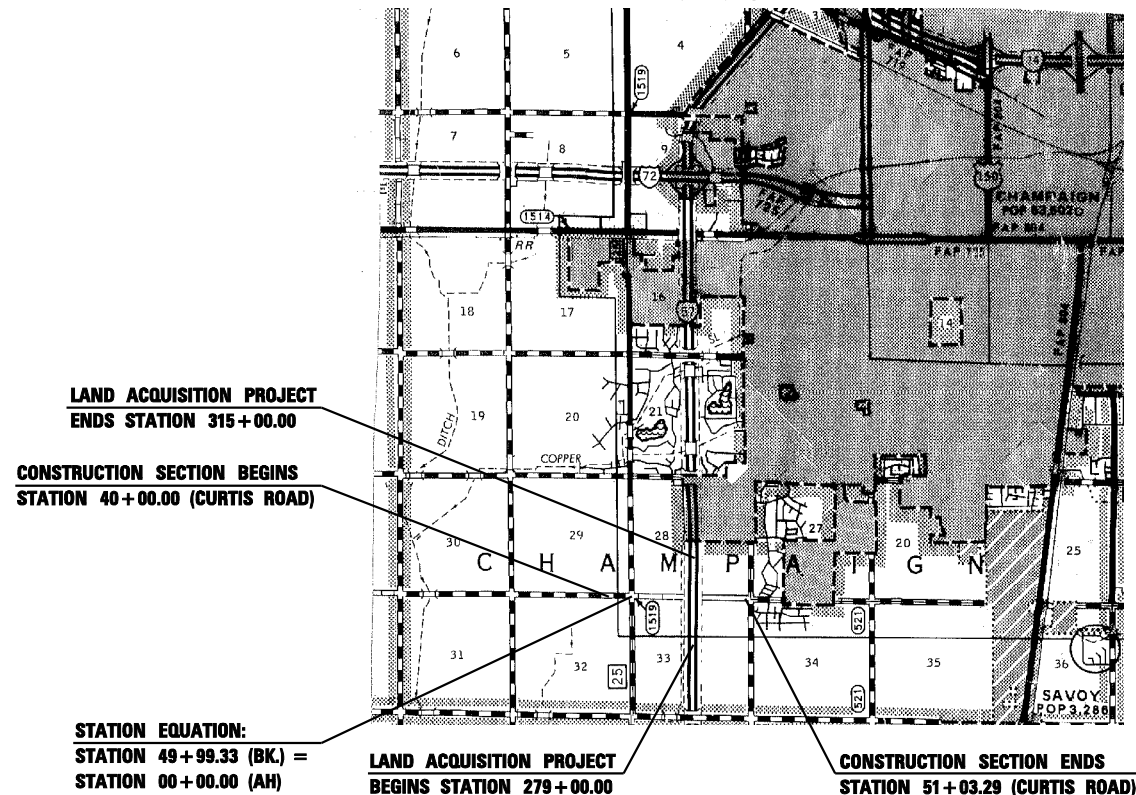

**STATION EQUATION:**  
 STATION 49+99.33 (BK.) =  
 STATION 00+00.00 (AH)

**LAND ACQUISITION PROJECT**  
**BEGINS STATION 279+00.00**

**CONSTRUCTION SECTION ENDS**  
**STATION 51+03.29 (CURTIS ROAD)**



THIS IS TO CERTIFY THAT THIS IS A TRUE AND CORRECT SET OF RIGHT OF WAY PLANS MADE UNDER MY DIRECTION FOR THE DIVISION OF HIGHWAYS, STATE OF ILLINOIS

ILLINOIS PROFESSIONAL LAND SURVEYOR NO. 2845  
 LICENSE EXPIRES 11/30/06

**STATE OF ILLINOIS**  
**DEPARTMENT OF TRANSPORTATION**  
**DIVISION OF HIGHWAYS**

SUBMITTED \_\_\_\_\_ 20\_\_

JOSEPH E. CROWE, P.E.  
 DEPUTY DIRECTOR OF HIGHWAYS  
 REGION 3 ENGINEER

EXAMINED \_\_\_\_\_ 20\_\_

DISTRICT CHIEF OF PLATS & PLANS

PASSED \_\_\_\_\_ 20\_\_

DISTRICT LAND ACQUISITION ENGINEER

LENGTH OF LAND ACQUISITION PROJECT = 3,600 LIN. FT. = 0.662 MILE