

F.A.I. RTE.	SECTION	COUNTY	TOTAL SHEETS	SHEET NO.
57	10-32HB-3,K	CHAMPAIGN	352	149

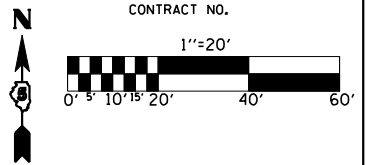

PROP. CURVE A1
 PI STA. = 14+43.64
 $\Delta = 49^\circ 10' 46''$ (LT)
 $D = 12^\circ 52' 32''$
 $R = 445.00'$
 $T = 203.64'$
 $L = 381.96'$
 $E = 44.38'$
 $e = 6\%$
 $T.R. = 45'$
 $S.E. RUN = 180'$
 $P.C. STA. = 12+40.00$
 $P.T. STA. = 16+21.96$

PROP. CURVE B2
 PI STA. = 23+73.78
 $\Delta = 45^\circ 44' 57''$ (LT)
 $D = 12^\circ 52' 32''$
 $R = 445.00'$
 $T = 187.74'$
 $L = 355.32'$
 $E = 37.98'$
 $e = 6\%$
 $T.R. = 45'$
 $S.E. RUN = 180'$
 $P.C. STA. = 21+86.03$
 $P.T. STA. = 25+41.35$

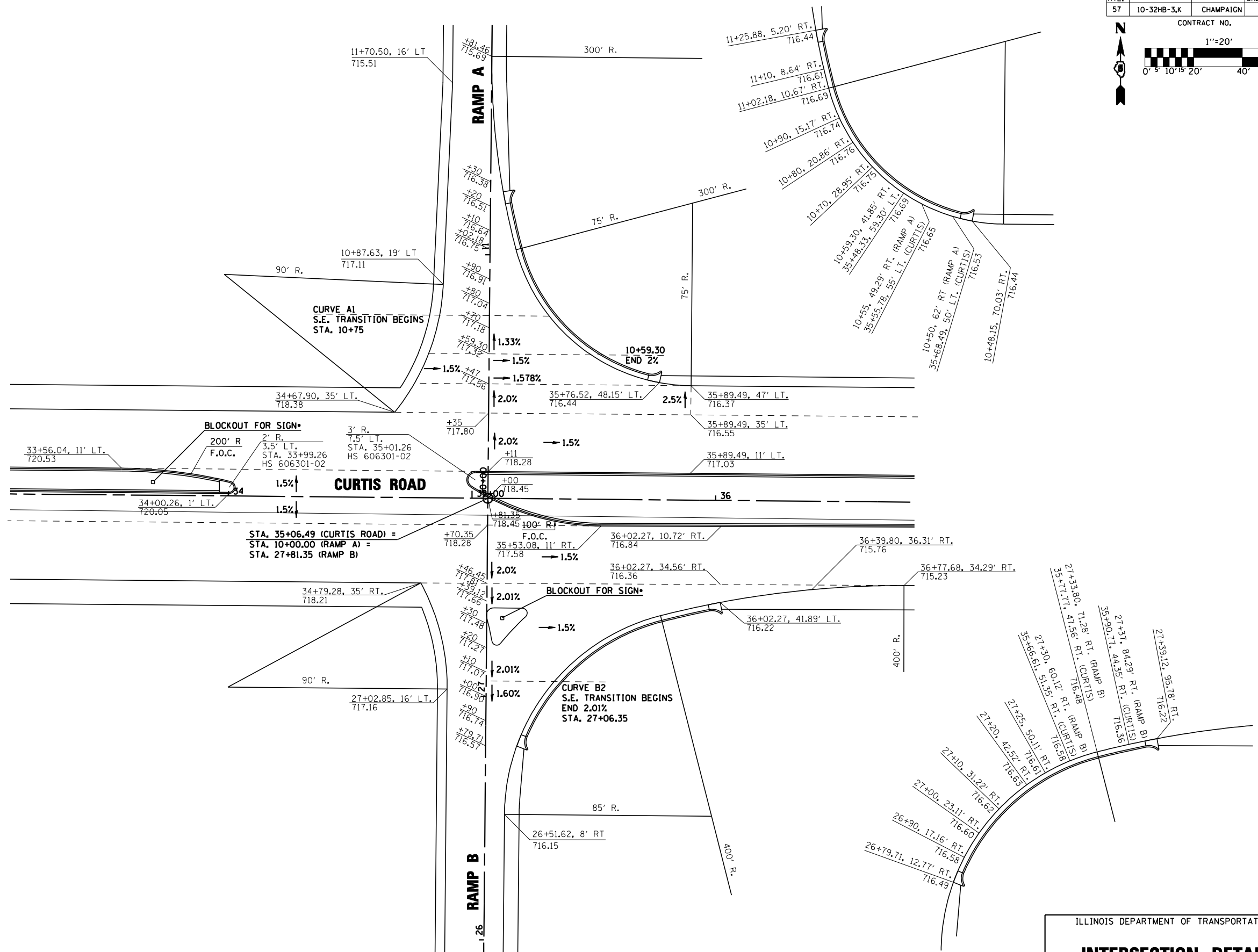

ILLINOIS DEPARTMENT OF TRANSPORTATION

**INTERSECTION DETAIL
 RAMPS A AND B**

•SEE DETAIL "LOCATION & DESIGN
 OF BLOCKOUTS FOR SIGN POSTS"