

F.A.I. RTE.	SECTION	COUNTY	TOTAL SHEETS	SHEET NO.
57	10-32HB-3,K	Champaign	352	180

CONTRACT NO. 90758

DETAIL OF OUTLET SPECIAL

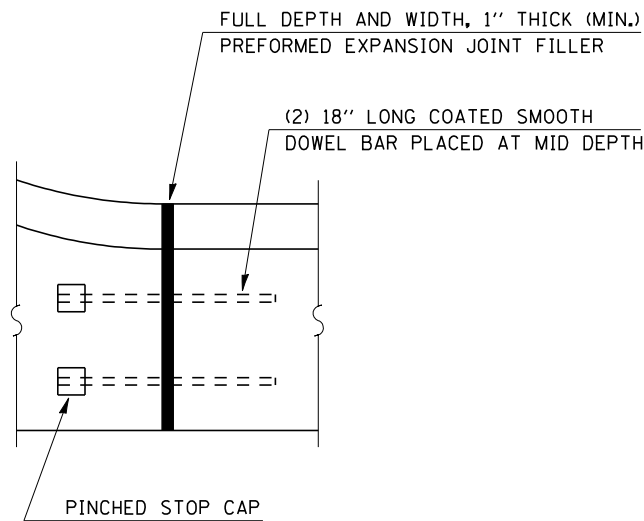

DETAIL OF EXPANSION JOINT

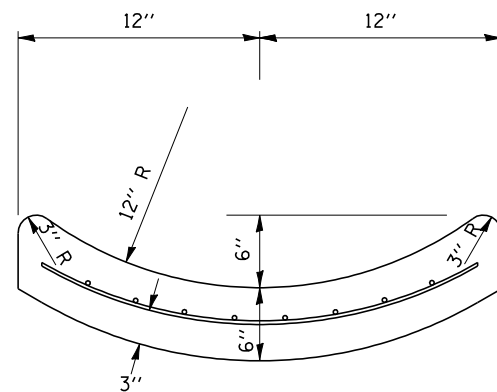

SECTION B-B

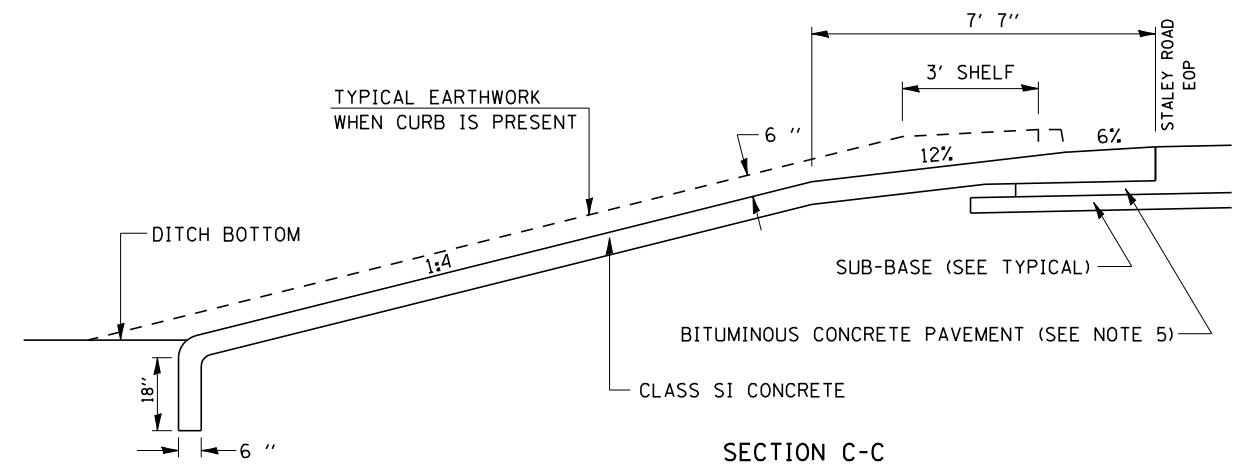

SECTION C-C

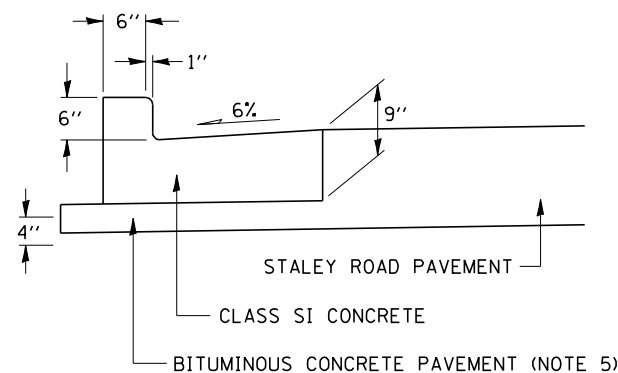

SECTION A-A

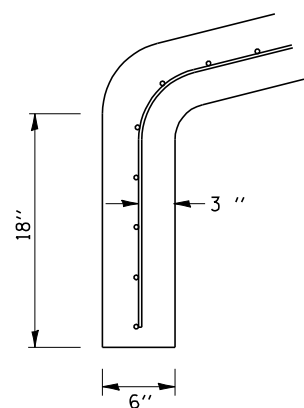

SECTION OF CURTAIN WALL

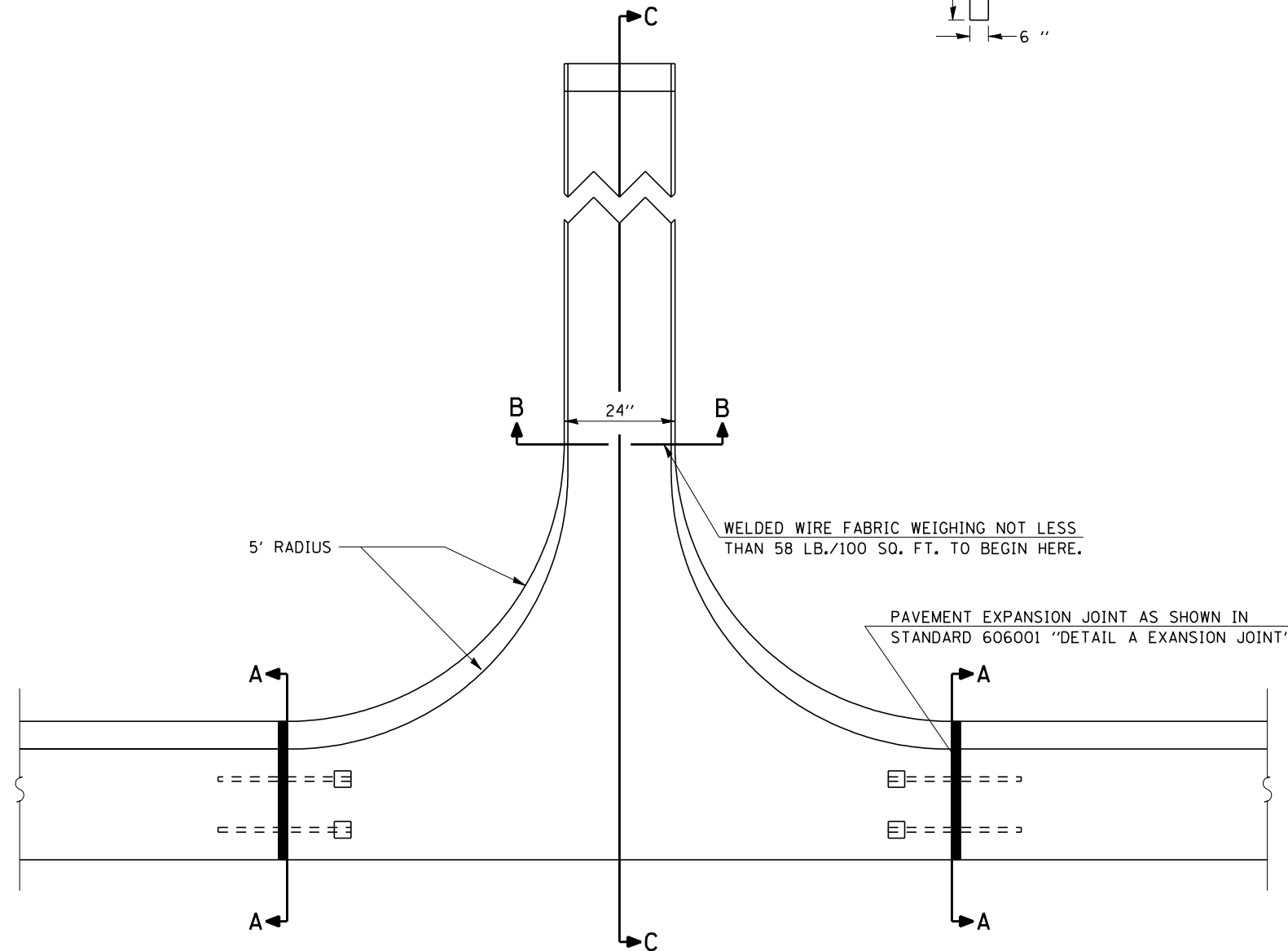

GENERAL NOTES

1. CLASS SI CONCRETE SHALL BE USED THROUGHOUT.
2. TIE BARS SHALL BE NO. 6 UNLESS OTHERWISE SHOWN.
3. TIE BARS SHALL NOT BE PAID FOR SEPARATELY, BUT SHALL BE CONSIDERED INCIDENTAL TO OUTLET SPECIAL.
4. THIS WORK SHALL BE PAID FOR AT THE CONTRACT UNIT PRICE PER EACH FOR OUTLET SPECIAL WHICH PRICE SHALL INCLUDE ALL LABOR AND MATERIAL AS SPECIFIED AND NO ADDITIONAL COMPENSATION SHALL BE ALLOWED.
5. COST OF BITUMINOUS MATERIAL BENEATH THE B-6.24 CC&G AND EXTENDING 6" BEYOND THE BACK OF CURB SHALL BE INCLUDED IN THE COST OF THE BOTTOM LAYER OF ADJACENT BITUMINOUS PAVEMENT AND NO ADDITIONAL COMPENSATION WILL BE ALLOWED.
6. QUANTITY FOR OUTLET SPECIAL FROM SECTION A-A TO SECTION B-B AND CURTAIN WALL = 1.27 CU. YDS CLASS SI CONCRETE. QUANTITY FOR SECTION B-B = 0.042 CU. YDS. CLASS SI CONCRETE PER LIN. FT.

ILLINOIS DEPARTMENT OF TRANSPORTATION

DETAILS