

F.A.I. RTE.	SECTION	COUNTY	TOTAL SHEETS	SHEET NO.
57	10-32HB-3,K	CHAMPAIGN	352	332
STA. 44+00.00		TO STA. 45+00.00		
FED. ROAD DIST. NO.		ILLINOIS FED. AID PROJECT		

RAMP C

DATE	
BY	
FINAL SURVEY	
SURVEYED	
PLOTTED	
NOTE BOOK	
AREAS CHECKED	
NO.	

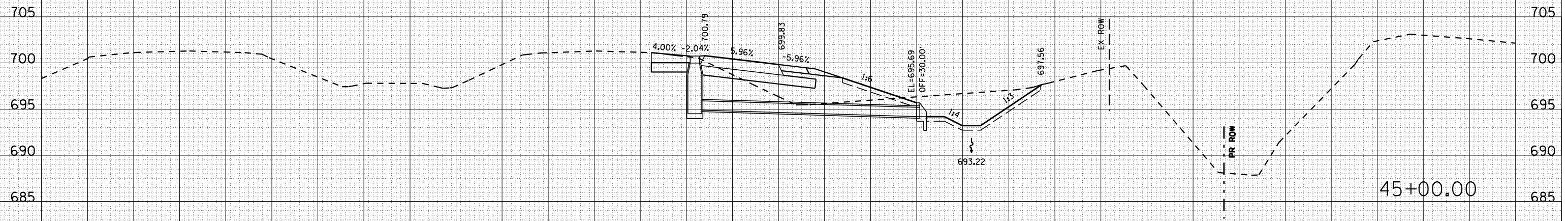

TSC=0.0  
 C=73.6  
 F=67.0  
 TSF=21.8

DATE	
BY	
ORIGINAL SURVEY	
SURVEYED	
PLOTTED	
NOTE BOOK	
AREAS CHECKED	
NO.	

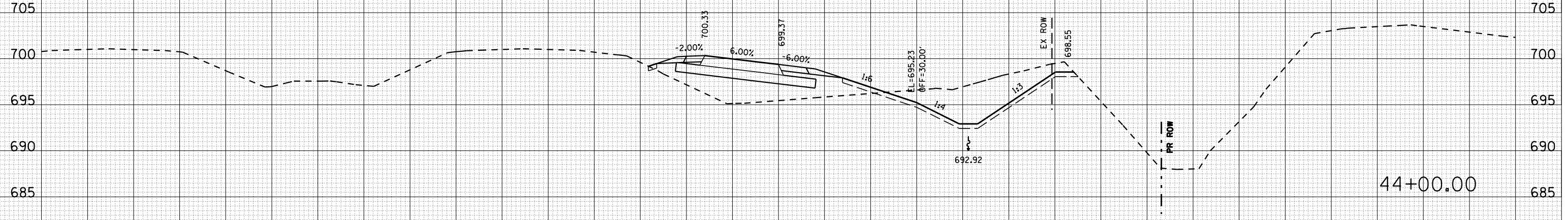

TSC=0.0  
 C=114.3  
 F=113.0  
 TSF=25.1