

ROUTE NO.	SECTION	COUNTY	SHEET NO.	TOTAL SHEETS
*	CRAWFORD	10	3	

* SEC. 05-04118-00-BR

B.M. - SEE PLAN-PROFILE
Existing Structure - SEE PLAN-PROFILE

Salvage - SEE SPEC. PROVISIONS

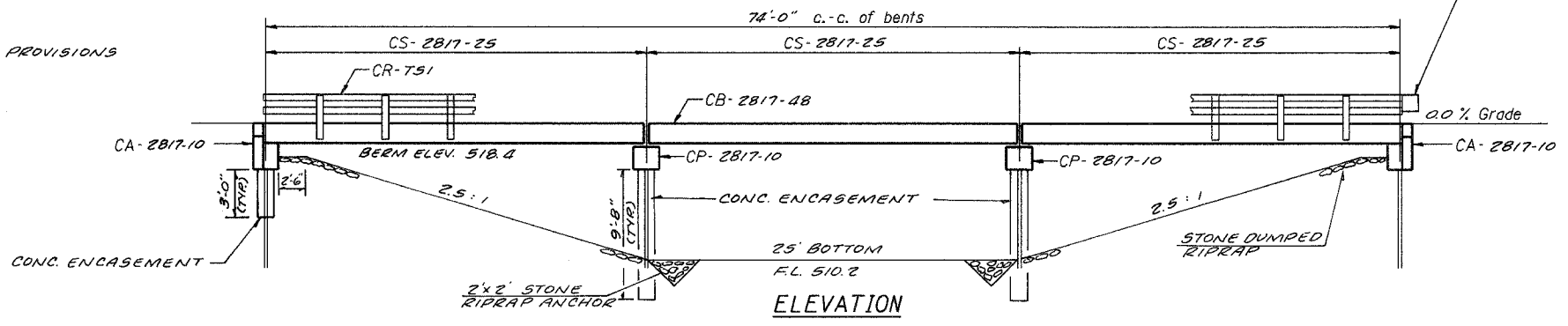

GENERAL NOTES

1. The Contractor shall drive 2 test piles, as specified, in a permanent location as directed by the Engineer before ordering the remaining piles.
2. See Special Provisions for boring logs.
3. A Corrosion inhibitor, as covered in the Special Provisions, shall be used in the concrete for precast prestressed concrete deck beams.

TOTAL BILL OF MATERIAL

Item	Unit	Super	Sub.		Total
			Piers	Abuts.	
Removal of Existing Structures	Each				1
Bituminous-Concrete Surface Course, Superpave	Ton				
Waterproofing Membrane System	Sq. Yd.				
Concrete Structures	Cu. Yd.		17.2	19.0	36.2
Precast Prestressed Concrete Deck Beams (17" Depth)	Sq. Ft.	2100			2100
Steel Bridge Rail, Type SM	Foot				
Steel Railing, Type S-1	Foot	150			150
Reinforcement Bars	Pound		1760	2500	4260
Furnishing STEEL PILES HP 10x42	Foot		270	270	540
Driving STEEL PILES	Foot		270	270	540
Test Piles STEEL HP 10x42	Each		1	1	2
Name Plates	Each			1	1
Concrete Encasement	Cu. Yd.		8.3	2.6	10.9
Portland Cement Mortar Fairing Course	Foot				
STONE DUMPED RIPRAP CLASS A4	TON				110

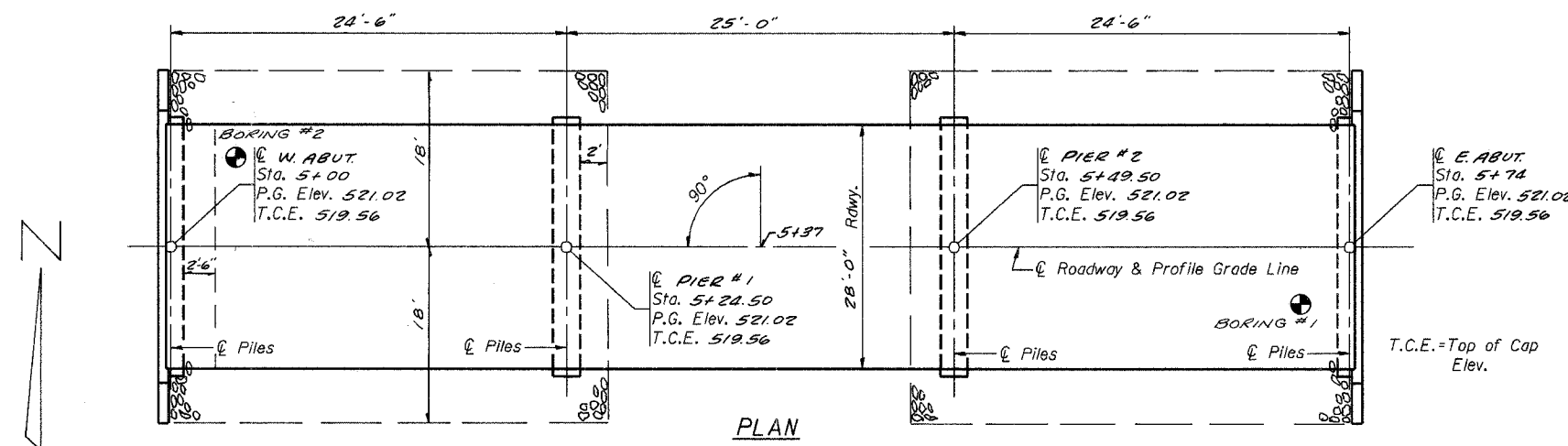

STONE DUMPED RIPRAP CL. A4
MIN. THICKNESS 12" = 110 TON

DESIGN SPECIFICATIONS

2002 AASHTO Standard Specifications - 17th ed.

LOADING HS20-44

Allow 25#/sq. ft. for future wearing surface.

SEISMIC DATA

Seismic Performance Category (SPC) =
Bedrock Acceleration Coefficient (A) =
Site Coefficient (S) =

PILE DATA (2-PIERS)

Type STEEL HP 10x42
Capacity 45 Tons
Estimated Length 30 Feet
Number Required 10 (Includes 1 Test Pile located in PIER #2)

PILE DATA (2-ABUTS.)

Type STEEL HP 10x42
Capacity 45 Tons
Estimated Length 30 Feet
Number Required 10 (Includes 1 Test Pile located in W. ABUT.)

STATION 5+37
MUDDY CREEK
SEC. 05-04118-00-BR BUILT 20
ROAD DIST.
CRAWFORD COUNTY
LOADING HS20
STR. NO. 017-3425

LETTERING FOR NAME PLATE

Locate Name Plate at S.W.
Corner of Bridge (See Std. CN)

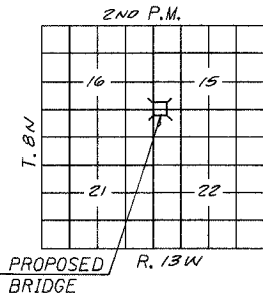

WATERWAY INFORMATION

Drainage Area = 9.78 SQ. MI. Low Grade Elev. = 516.4 @ Sta. 2+00

Flood	Freq. Yr.	Q C.F.S.	Opening Sq. Ft.		Nat. H.W.E.	Head - Ft.		Headwater El.		APPROACH OPENING SQ. FT.	
			Exist.	PROP.		Exist.	PROP.	EXIST	PROP		
Design	15	1474	302	375	518.4	0	0	518.4	518.4	251	127
Base	100	2327	337	432	519.2	0	0	519.2	519.2	536	353
Overtopping											
Max. Calc.	500										

INDEX OF SHEETS

1. General Plan & Elevation
2. Standard CS-2817-25
3. Standard CB-2817-48
4. Standard CA-2817-10
5. Standard CP-2817-10
6. Standard CR-751
7. Standard CN
8. Standard CX-1
9. Standard

GENERAL PLAN & ELEVATION
TR ROUTE 86
OVER MUDDY CREEK
SECTION 05-04118-00-BR
CRAWFORD COUNTY
STATION 5+37