

REVISIONS

SMS ENGINEERS
 Sheppard, Morgan & Schwaab, Inc.
 CONSULTING ENGINEERS AND LAND SURVEYORS
 215 Market Street, P.O. Box E, Alton, IL 62002 • 618/462-9755 • Email: mail@smsengineers.com
 10 Central Industrial Drive, Granite City, IL 62040 • 618/877-9700 • E-mail: mail@smsengineers.com

FOSTERBURG ROAD IMPROVEMENTS-PHASE 1
 ALTON, ILLINOIS
 FAU ROUTE 9002
 ALTON SECTION 03-00218-00-WR
 TRAFFIC CONTROL PLAN

B-Traffic Control.DWG
 REF. BK. PG.
 JOB NO. 205889
 DSN. BY: CLA
 DWN. BY: CDP
 CHK. BY: JHH
 DATE: JANUARY, 2006
 SCALE: 1"=50'
 SHEET 5 OF 38

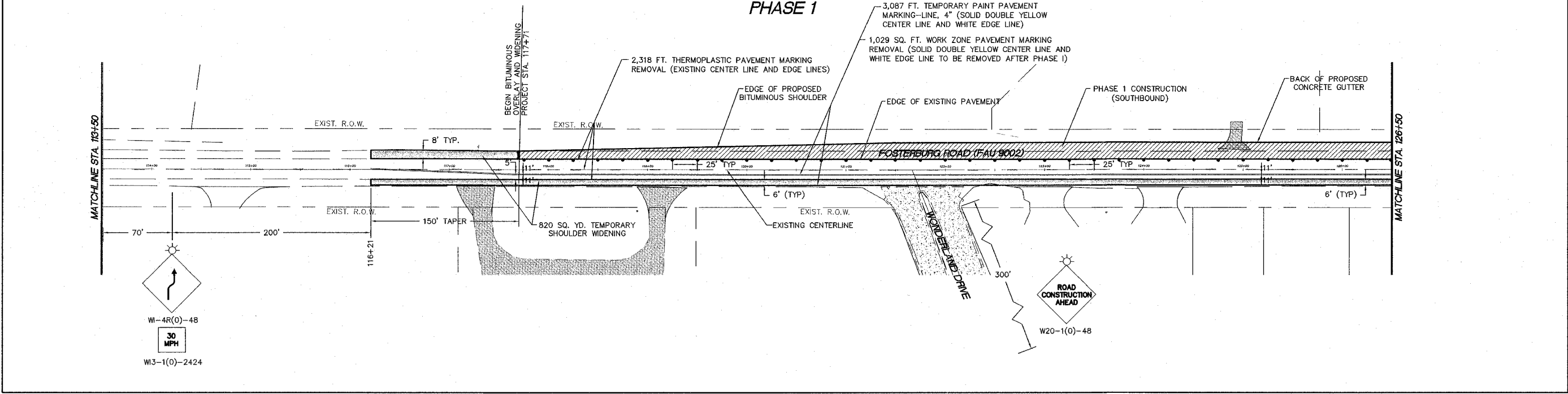
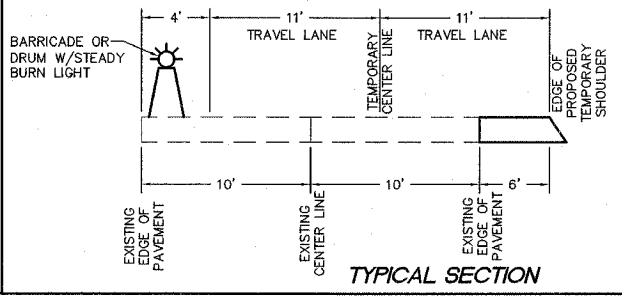
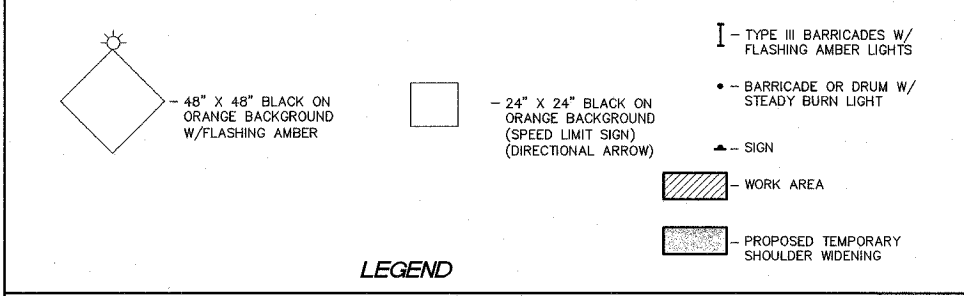
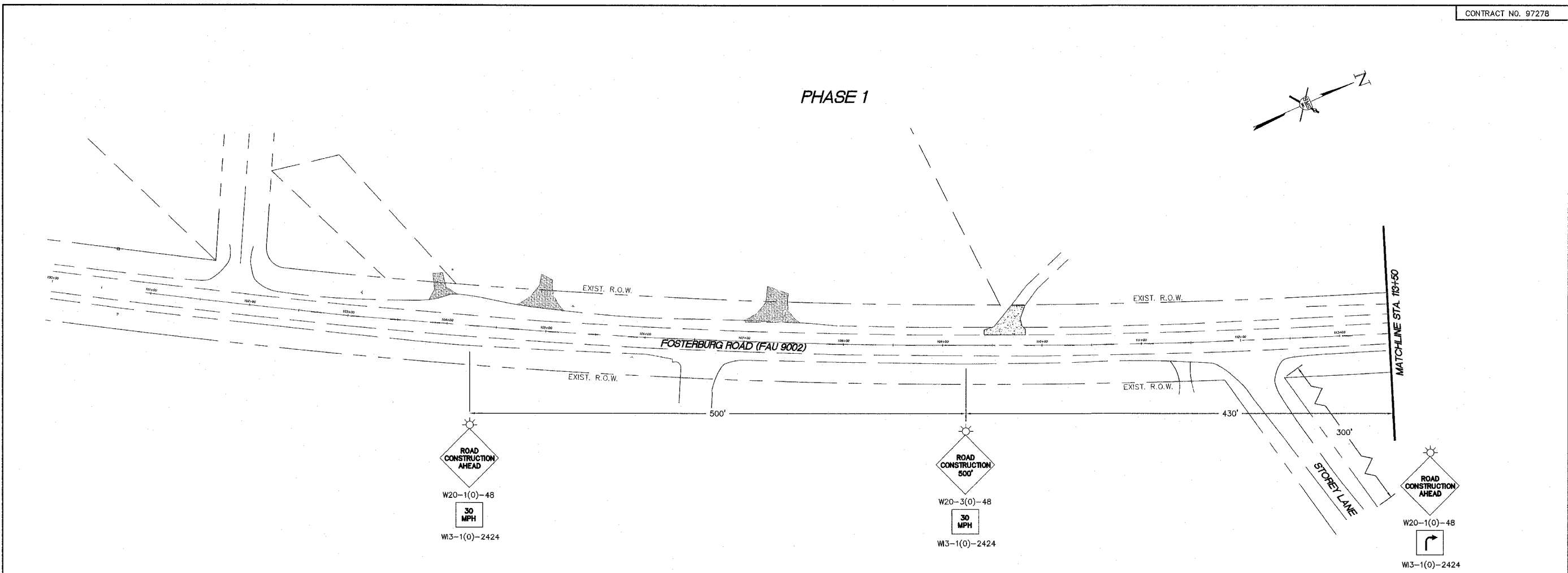

C:\p\land projects\Alton Fosterburg Road (205889) at blv\p18-Traffic Control.dwg, 3/31/2006 8:21:59 AM, cprint, 1/50