

REVISIONS

**SMS ENGINEERS**  
Sheppard, Morgan & Schwaab, Inc.  
CONSULTING ENGINEERS AND LAND SURVEYORS  
215 Market Street, P.O. Box E, Alton, IL 62002 • 618462-9755 • Email: mail@smsengineers.com  
10 Central Industrial Drive, Granite City, IL 62040 • 618877-8700 • E-mail: mail@smsengineers.com

**FOSTERBURG ROAD IMPROVEMENTS-PHASE 1**  
ALTON, ILLINOIS  
FAU ROUTE 9002  
ALTON SECTION 03-00218-00-WR  
TRAFFIC CONTROL PLAN

8-Traffic Control.DWG  
REF. BK. PG.  
JOB NO. 205889  
DSN. BY: CLA  
DWN. BY: CDP  
CHK. BY: JHH  
DATE: JANUARY, 2006  
SCALE: 1"=50'  
SHEET 7 OF 38

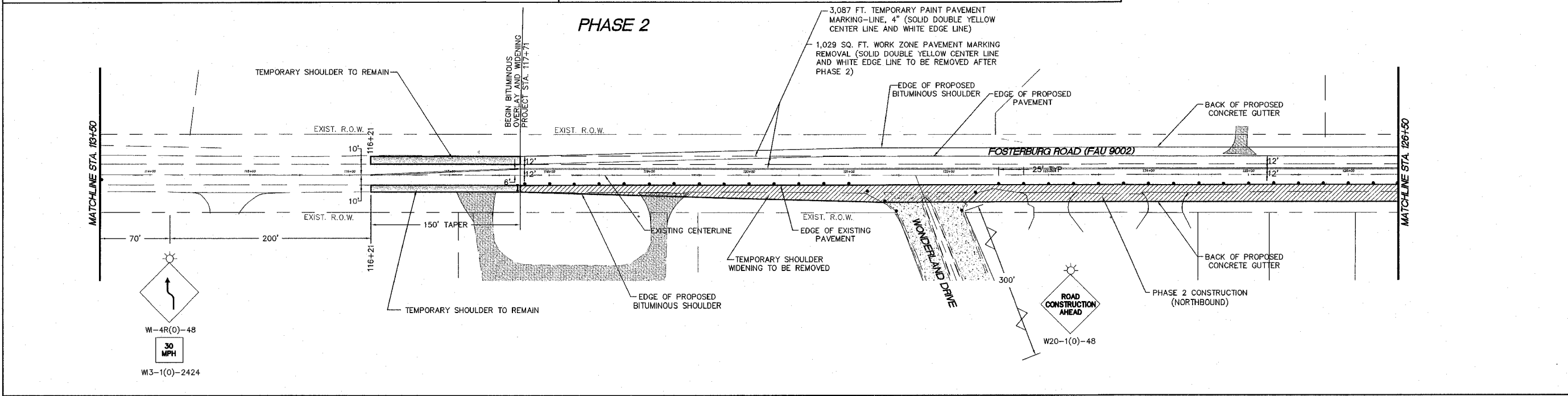
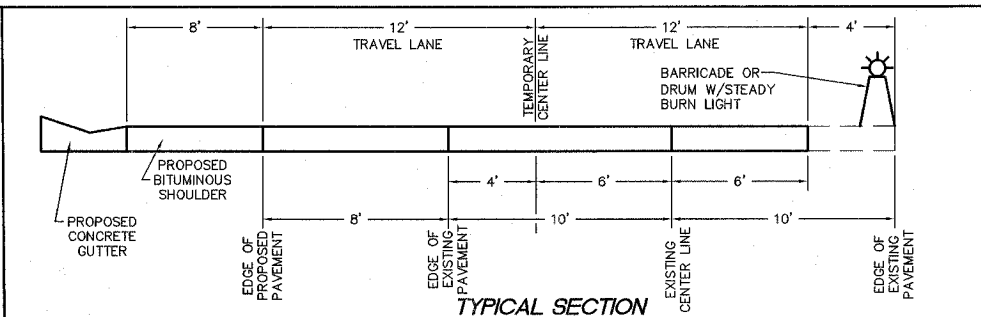
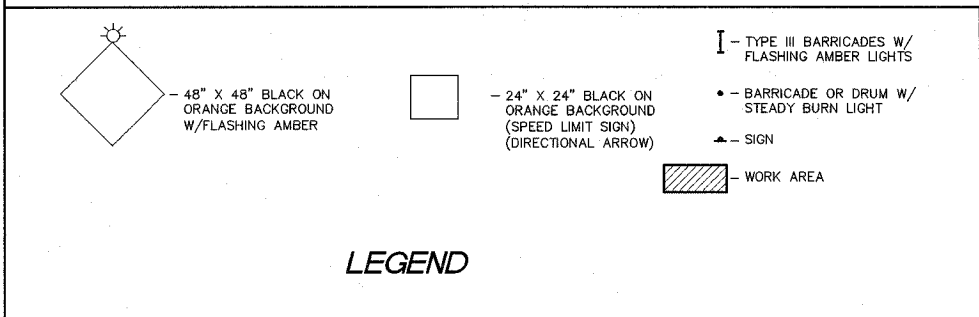
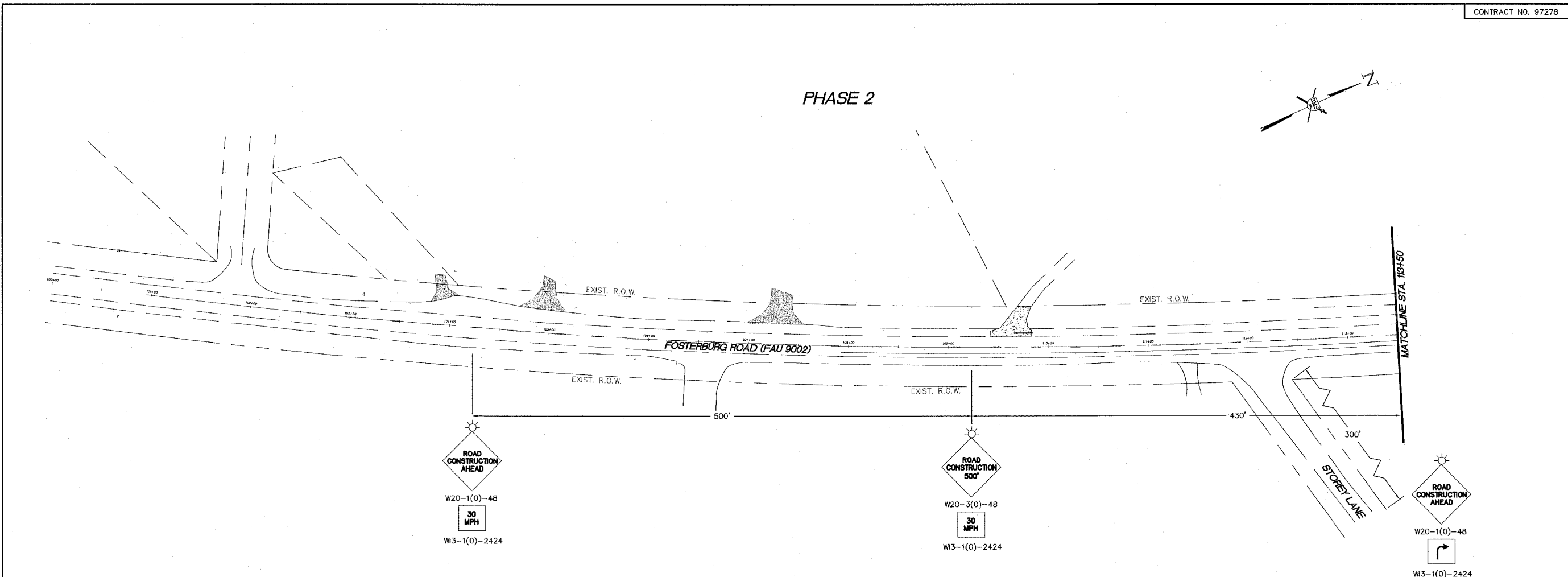

ig:\land projects\alton\_fosterburg\_road (205889) at\dwg\18-Traffic Control.dwg, 3/31/2006 8:22:35 AM, gmat, 1/30