

**PAVEMENT MARKING SCHEDULE**

ITEM	QUANTITY	UNIT
THERMOPLASTIC PAVEMENT MARKING-LINE 4" (YELLOW)	9,362	FOOT
THERMOPLASTIC PAVEMENT MARKING-LINE 4" (WHITE)	6,779	FOOT
<b>TOTAL THERMOPLASTIC 4"</b>	<b>16,141</b>	<b>FOOT</b>
THERMOPLASTIC PAVEMENT MARKING-LINE 12" (YELLOW)	345	FOOT
THERMOPLASTIC PAVEMENT MARKING-LINE 12" (WHITE)	39	FOOT
<b>TOTAL THERMOPLASTIC 12"</b>	<b>384</b>	<b>FOOT</b>
THERMOPLASTIC PAVEMENT MARKING-LETTERS & SYMBOLS	390	SQ. FT.
▲ RAISED REFLECTIVE PAVEMENT MARKERS (ONE-WAY CRYSTAL)	5	EACH
▲ RAISED REFLECTIVE PAVEMENT MARKERS (ONE-WAY AMBER)	38	EACH
◆ RAISED REFLECTIVE PAVEMENT MARKERS (TWO-WAY AMBER)	132	EACH
<b>TOTAL REFLECTORS</b>	<b>175</b>	<b>EACH</b>
RAISED REFLECTIVE PAVEMENT MARKER REMOVAL	86	EACH

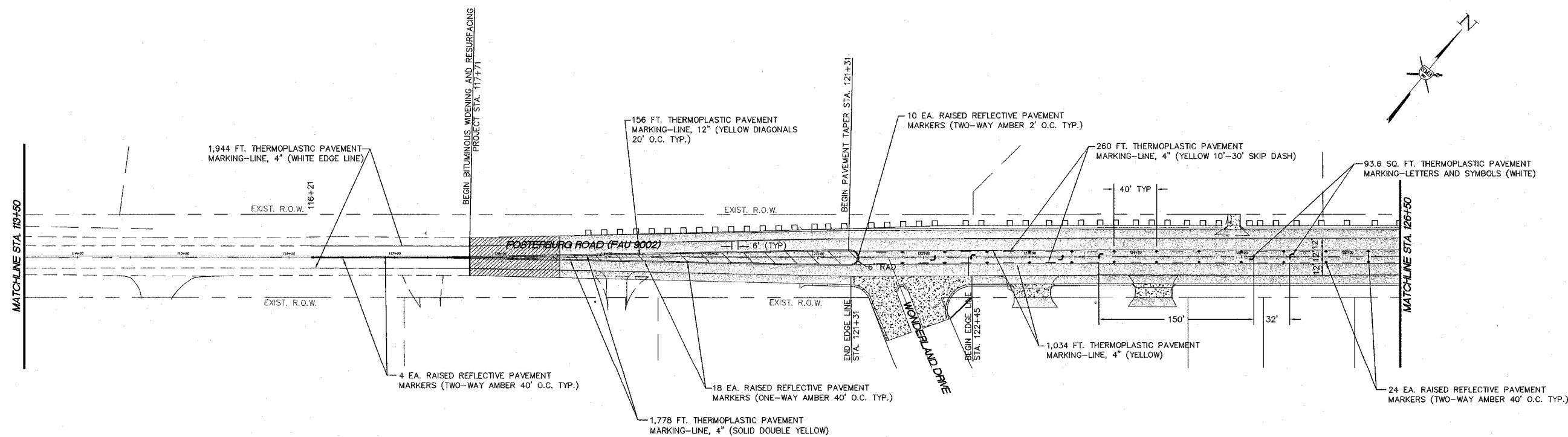
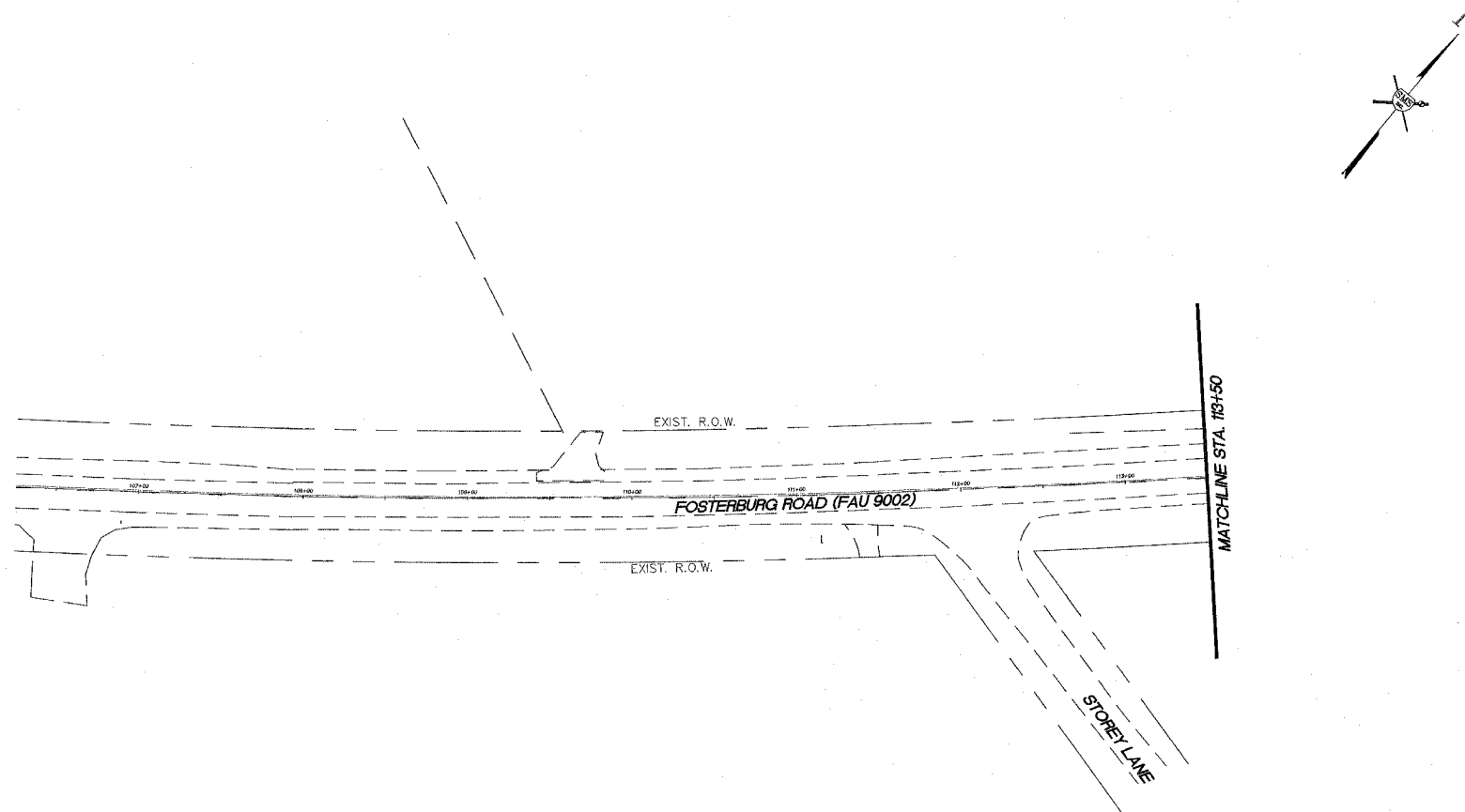

NO.	DATE	DESCRIPTION

**SMS ENGINEERS**  
**Sheppard, Morgan & Schwaab, Inc.**  
 CONSULTING ENGINEERS AND LAND SURVEYORS  
 215 Market Street, P.O. Box E, Alton, IL 62002-618462-9755 • Email: mail@smsengineers.com  
 10 Central Industrial Drive, Granite City, IL 62040-618077-5700 • Email: mail@smsengineers.com

**FOSTERBURG ROAD IMPROVEMENTS - PHASE 1**  
**ALTON, ILLINOIS**  
**FAU ROUTE 9002**  
**ALTON SECTION 03-0021B-00-WR**  
**PAVEMENT MARKING PLAN**

B--PROPOSED STRIPING.DWG  
 REF. BK. PG.  
 JOB NO. 20588G  
 DSN. BY: CLA  
 DWN. BY: CDP  
 CHK. BY: JHH  
 DATE: JANUARY, 2006  
 SCALE: 1"=50'  
 SHEET 26 OF 38