

24+00 25+00 26+00 27+00 28+00 29+00 30+00 31+00 32+00 33+00

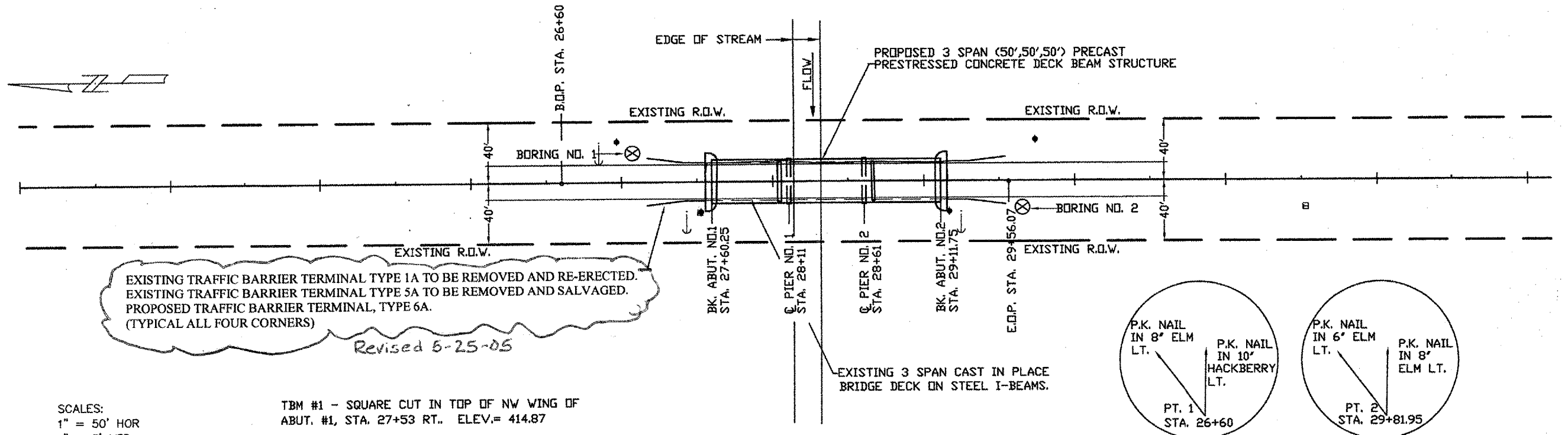

SCALES:
 1" = 50' HOR
 1" = 5' VER

TBM #1 - SQUARE CUT IN TOP OF NW WING OF
 ABUT. #1, STA. 27+53 RT.. ELEV.= 414.87

