

ROUTE	COUNTY	SECTION	SHEET/OF
CH 19	RANDOLPH	05-00039-04-BR	1/6+6
FEDERAL AID PROJECT			
CONTRACT NO. 97279			Total sheets 12

SHEET NO	INDEX OF SHEETS	CONTENT
1	COVER SHEET WITH LOCATION MAP	
2	TYPICAL SECTIONS, GENERAL NOTES, SUMMARY OF QUANTITIES	
3	POROUS GRANULAR EMBANKMENT DETAILS AND PAVEMENT SCHEDULE	
4	PLAN AND PROFILE	
5	GENERAL PLAN & ELEVATION	
6	MODIFIED ABUTMENT BASE SHEET	

STATE OF ILLINOIS  
DEPARTMENT OF TRANSPORTATION  
**PLANS FOR**  
**PROPOSED LOCAL AGENCY IMPROVEMENT**  
RANDOLPH COUNTY  
FAS 863 (COUNTY HIGHWAY 19)  
SECTION 05-00039-04-BR  
PROJECT NO. BRS-863(105)  
JOB NO C-98-360-06

HIGHWAY STANDARDS:  
BLR 21-6, 515001-02,  
631032-02 702001-06  
Rev. 5-25-06

BRIDGE STANDARDS:  
CB-2827-48, CS-2827-50, CP-2827-10,  
CR-TSM, CX-1, CN

UTILITIES

EGYPTIAN TELEPHONE CO-OP 618-774-1000      VERIZON NORTH 309-663-3422

CHARTER COMMUNICATIONS 618-242-9512      AMEREN/IP 618-236-6210

JULIE  
1-800-892-0123

EXISTING STRUCTURE: 3 SPAN, 162' LONG BRIDGE  
CONSISTING OF CAST IN PLACE CONCRETE DECK AND  
STEEL STRINGERS ON TIMBER PILES.

PROPOSED STRUCTURE: 3 SPAN, 150' LONG PPC DECK  
BEAM BRIDGE ON STEEL PILES.

DESIGN INFORMATION

RURAL COLLECTOR  
CLASS III ROADWAY  
DESIGN SPEED 50 MPH  
ADT (2005) - 1700  
(2015) - 2000

PAVEMENT DESIGN INFORMATION

STRUCTURAL DESIGN TRAFFIC: 2000 (YEAR 2015)      PV 1760  
SU 140  
MU 100

MINIMUM SOIL SUPPORT    IBR = 3

T.F. = 0.095    E<sub>r</sub> = 3

PAVEMENT STRUCTURE MATERIALS: SURFACE: BITUMINOUS CONCRETE CLASS I  
BASE COURSE: AGGREGATE TYPE A

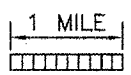
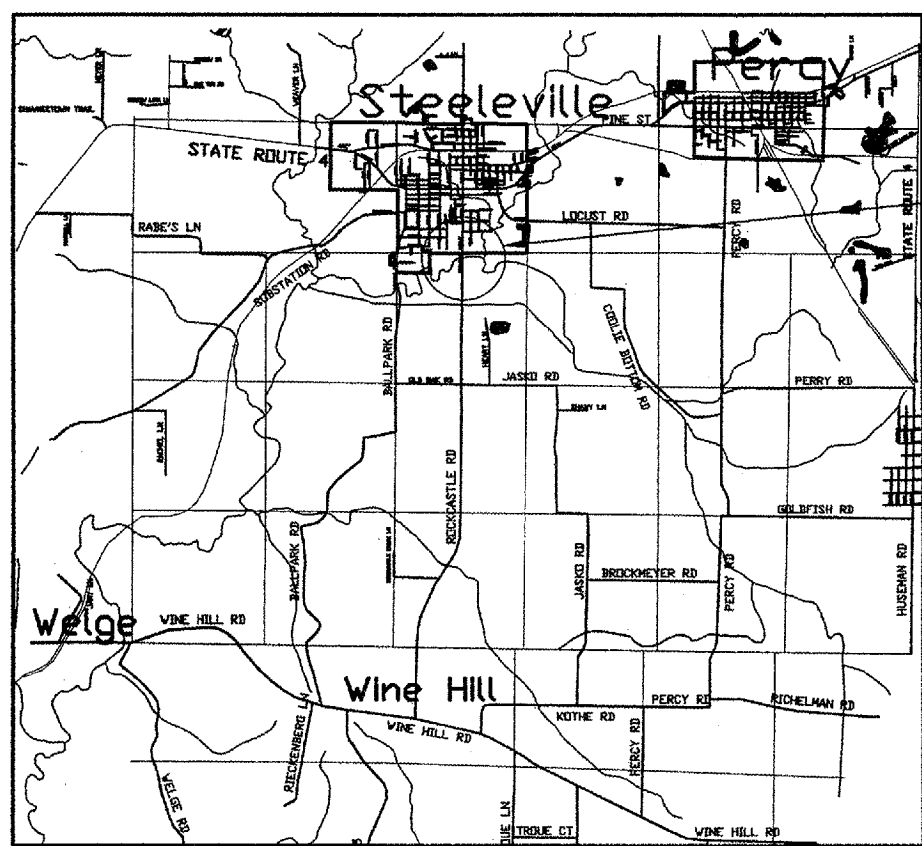
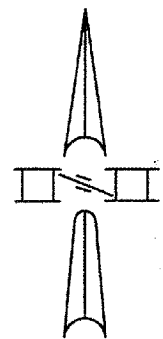

NET LENGTH OF IMPROVEMENT  
296.07 LIN FT. = .0561 MILES

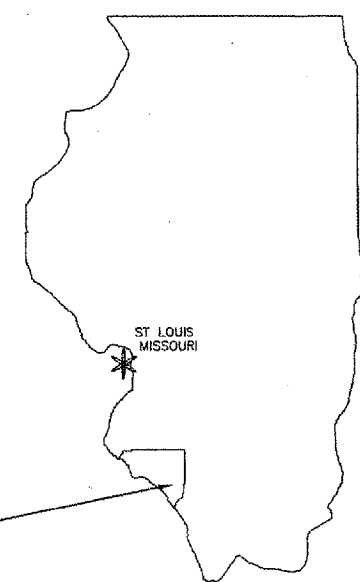

SITE OF PROPOSED IMPROVEMENT

PROPOSED IMPROVEMENT  
STA. 26+60 TO 29+56.07

THESE PLANS WERE PREPARED BY ME OR A  
MEMBER OF MY STAFF WORKING UNDER MY  
PERSONAL SUPERVISION.

*Michael Riebeling*  
COUNTY ENGINEER      3/09/2006  
DATE



11/30/2007  
EXPIRATION DATE

APPROVED	<i>March 9</i>	2006
	<i>Michael Riebeling</i>	COUNTY ENGINEER
PASSED	<i>April 17</i>	2006
	<i>Jennifer Obentins</i>	LOCAL ROADS & STREETS ENGINEER
APPROVED	<i>April 17</i>	2006
	<i>Mary C. Lamie</i>	DEPUTY DIRECTOR OF HIGHWAYS REGION FIVE ENGINEER
STATE OF ILLINOIS DEPARTMENT OF TRANSPORTATION		

CONTRACT NO. 97279

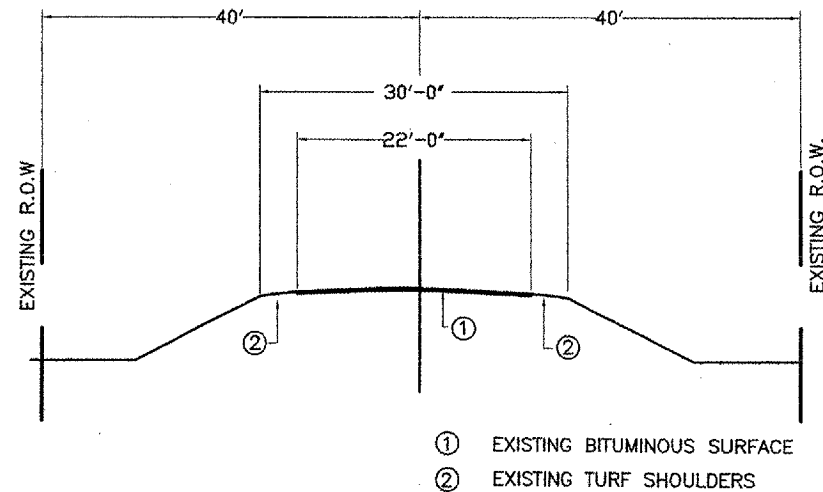

EXISTING TYPICAL SECTION

STA. 26+60 TO STA. 27+60.25  
STA. 29+11.75 TO STA. 29+56.07

SCALE: 1"=10'

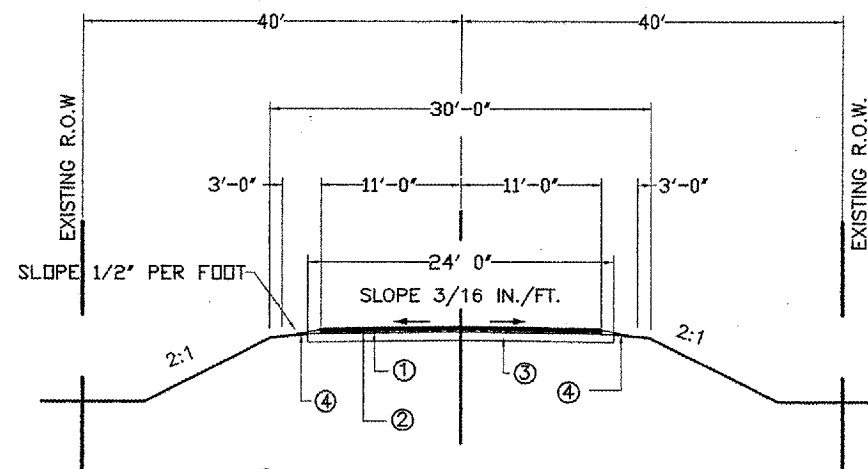

- ① Proposed 2" Bituminous Concrete Surface Course, Superpave, Mix "C", N50
- ② Proposed 2 1/2" Bituminous Concrete Binder Course, Superpave, IL-19.0, N50
- ③ Proposed 10" Aggregate Base Course, Type A
- ④ Proposed Aggregate Wedge Shoulder

PROPOSED TYPICAL SECTION

STA. 26+60 TO STA. 27+60.25  
STA. 29+11.75 TO STA. 29+56.07

QUANTITIES USED FOR ESTIMATING

BITUMINOUS MATERIALS (PRIME COAT)

0.3 GAL/SQ.YD. (AGGREGATE BASE)  
0.05 GAL/SQ.YD. (BITUMINOUS SURFACE)

SUMMARY OF QUANTITIES

BRIDGE CONSTR CODE - X081-2A

Quantity	Unit	Item	Item Number
50	TON	POROUS GRANULAR EMBANKMENT	20700110
204	TON	STONE DUMPED RIPRAP CLASS A4	28100807
22	TON	AGGREGATE BASE COURSE, TYPE A	35100100
18	GALLON	BITUMINOUS MATERIAL (PRIME COAT)	40600100
1	L SUM	REMOVAL OF EXISTING STRUCTURES	50100200
38	CU YD	CONCRETE STRUCTURES	50300225
4200	SQ FT	PRECAST PRESTRESSED CONCRETE DECK BEAMS (27" DEPTH)	50400505
4340	POUND	REINFORCEMENT BARS	50800105
300	FOOT	STEEL BRIDGE RAIL, TYPE SM	50901005
1591	FOOT	FURNISHING STEEL PILES HP10X42	51201400
1591	FOOT	DRIVING STEEL PILES	51202700
2	EACH	TEST PILE STEEL HP10X42	51203400
14.4	CU YD	CONCRETE ENCASEMENT	51204315
1	EACH	NAME PLATES	51500100
467	SQ YD	WATERPROOFING MEMBRANE SYSTEM	58100200
900	FOOT	PORTLAND CEMENT MORTAR FAIRING COURSE	58300100
4	EACH	REMOVE AND RE-ERECT TRAFFIC BARRIER TERMINAL, TYPE 1A	63301995
4	EACH	REMOVE AND SALVAGE Existing TRAFFIC BARRIER TERMINAL, TYPE 5A	63303700*
1	L SUM	MOBILIZATION	67100100
4	EACH	TERMINAL MARKER-DIRECT APPLIED	78201000
81	TON	BITUMINOUS CONCRETE SURFACE COURSE, SUPERPAVE, MIX "C", N50	X4066414
25	TON	BITUMINOUS CONCRETE BINDER COURSE, SUPERPAVE, IL-19.0, N50	X4066614
1	EACH	STRUCTURE EXCAVATION PROTECTION FOR PILE BENTS NO. 1	X5020301
1	EACH	STRUCTURE EXCAVATION PROTECTION FOR PILE BENTS NO. 2	X5020302
4	EACH	TRAFFIC BARRIER TERMINAL, TYPE 6A	63100087*

GENERAL NOTES

1. All advance warning signs shall be 48 in. Fluorescent Orange.
2. Pavement Marking to be done by others.

\*Revised 5-25-06

24+00      25+00      26+00      27+00      28+00      29+00      30+00      31+00      32+00      33+00

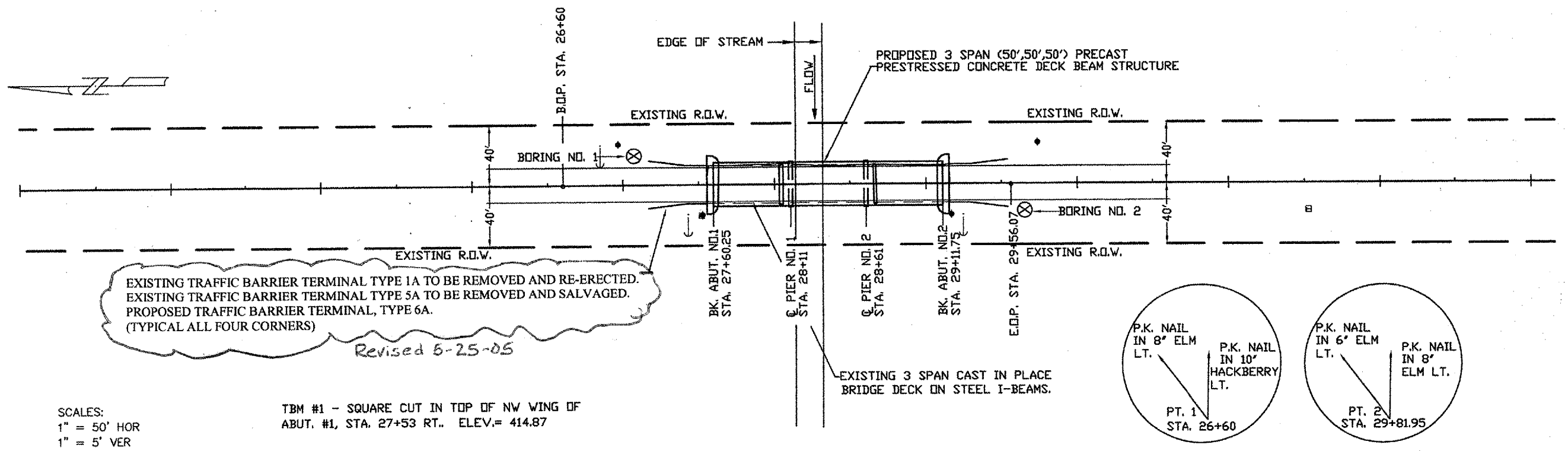

SCALES:  
 1" = 50' HOR  
 1" = 5' VER

TBM #1 - SQUARE CUT IN TOP OF NW WING OF  
 ABUT. #1, STA. 27+53 RT.. ELEV.= 414.87

