

ILL. RTE.	SECTION	COUNTY	TOTAL SHEETS	SHEET NO.
*	**	***	10	1

- OLD IL 13/ IL 127
- PAVEMENT PRESERVATION FY 06
- GALLATIN AND PERRY COUNTIES

D-99-037-05

STATE OF ILLINOIS

DEPARTMENT OF TRANSPORTATION

DIVISION OF HIGHWAYS

PROPOSED HIGHWAY PLANS

S.B.I. 1 (OLD ROUTE 13 / IL 127) SECTION PAVEMENT PRESERVATION FY 06 GALLATIN AND PERRY COUNTIES C-99-031-05

FOR INDEX OF SHEETS, SEE SHEET NO. 2
FOR SUMMARY OF QUANTITIES, SEE SHEET 4.
TRAFFIC DATA (2003):
LOCATION 1 - OLD IL 13 - OLD SHAWNEETOWN
ADT = 700
% OF TRUCKS = 2%
LOCATION 2 - OLD IL 13 - JUNCTION
ADT = 25
% OF TRUCKS = 0%
LOCATON 3 - IL 127 - PINCKNEYVILLE
ADT = 3600
% OF TRUCKS = 2.3%
PV = 2750
MU = 200
SU = 650

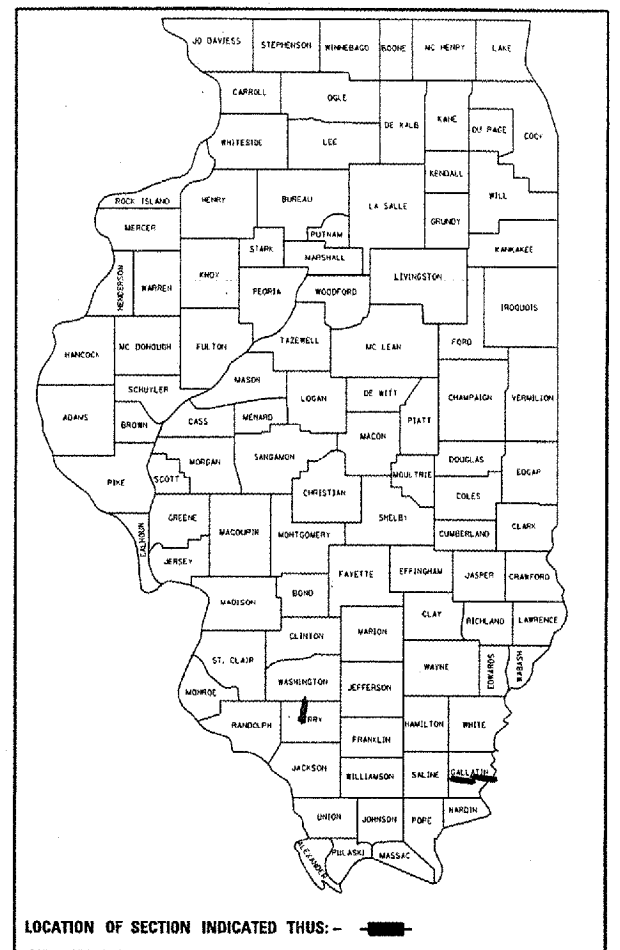

LOCATION 3 -
IL. RTE. 127 - NORTH OF PINCKNEYVILLE
3.02 MILES

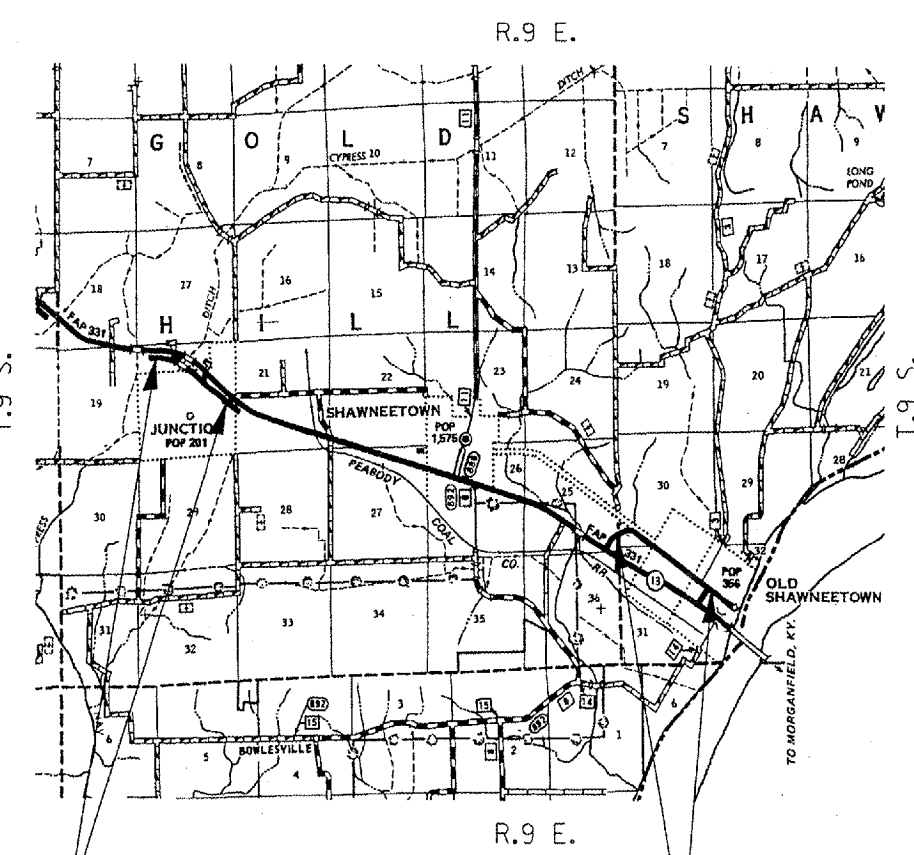
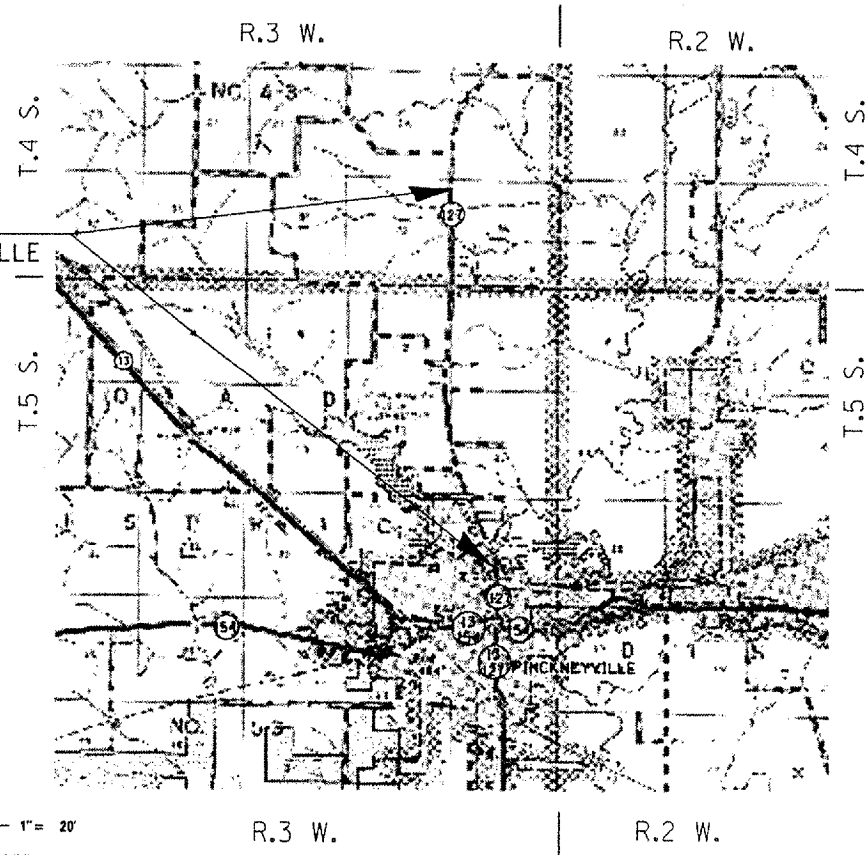

TOWNSHIPS: SHAWNEE; GOLD HILL; PINCKNEYVILLE

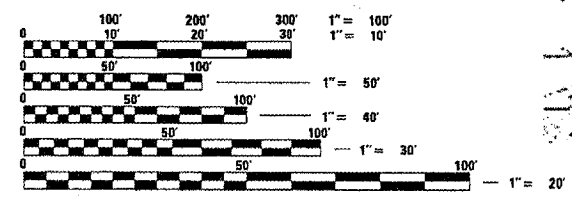

FULL SIZE PLANS HAVE BEEN PREPARED USING STANDARD ENGINEERING SCALES. REDUCED SIZED PLANS WILL NOT CONFORM TO STANDARD SCALES. IN MAKING MEASUREMENTS ON REDUCED PLANS, THE ABOVE SCALES MAY BE USED.

J.U.L.I.E.
JOINT UTILITY LOCATION INFORMATION FOR EXCAVATION
1-800-892-0123

LOCATION 2 -
OLD RTE. 13 AT JUNCTION
1.00 MILES

LOCATION 1 -
OLD RTE. 13 AT OLD SHAWNEETOWN
1.28 MILES

NET LENGTH OF PROJECT: 28,014 FT. = 5.30 MILES

STATE OF ILLINOIS
DEPARTMENT OF TRANSPORTATION
DIVISION OF HIGHWAYS

SUBMITTED *March 24, 2006*
Mike C. [Signature]
DEPUTY DIRECTOR OF HIGHWAYS, REGION ENGINEER

May 12, 2006
Mike [Signature]
ENGINEER OF DESIGN AND ENVIRONMENT

May 12, 2006
Milton R. Sees P.E.
DIRECTOR OF HIGHWAYS, CHIEF ENGINEER

PRINTED BY THE AUTHORITY OF THE STATE OF ILLINOIS

PROJECT ENGINEER: CHARLES STEIN - (618)351-5210
DESIGN TECHNICIAN: KATHI MCCORD - (618)351-5216