

F.A.I. RTE.	SECTION	COUNTY	TOTAL SHEETS	SHEET NO.
57	*	WILLIAMSON	60	43
STA. TO STA.		ILLINOIS FED. AID PROJECT		
FED. ROAD DIST. NO.		* [X1-(4,4-1,5,6,6-2)] R-1		

STAGE CONSTRUCTION VIII

PAVEMENT REPLACEMENT ON I-57 ADJACENT TO BRIDGE APPROACHES

WILLIAMSON COUNTY
NORTHBOUND LANES ONLY
FAI RTE 57
(LOOKING IN DIRECTION OF TRAVEL)

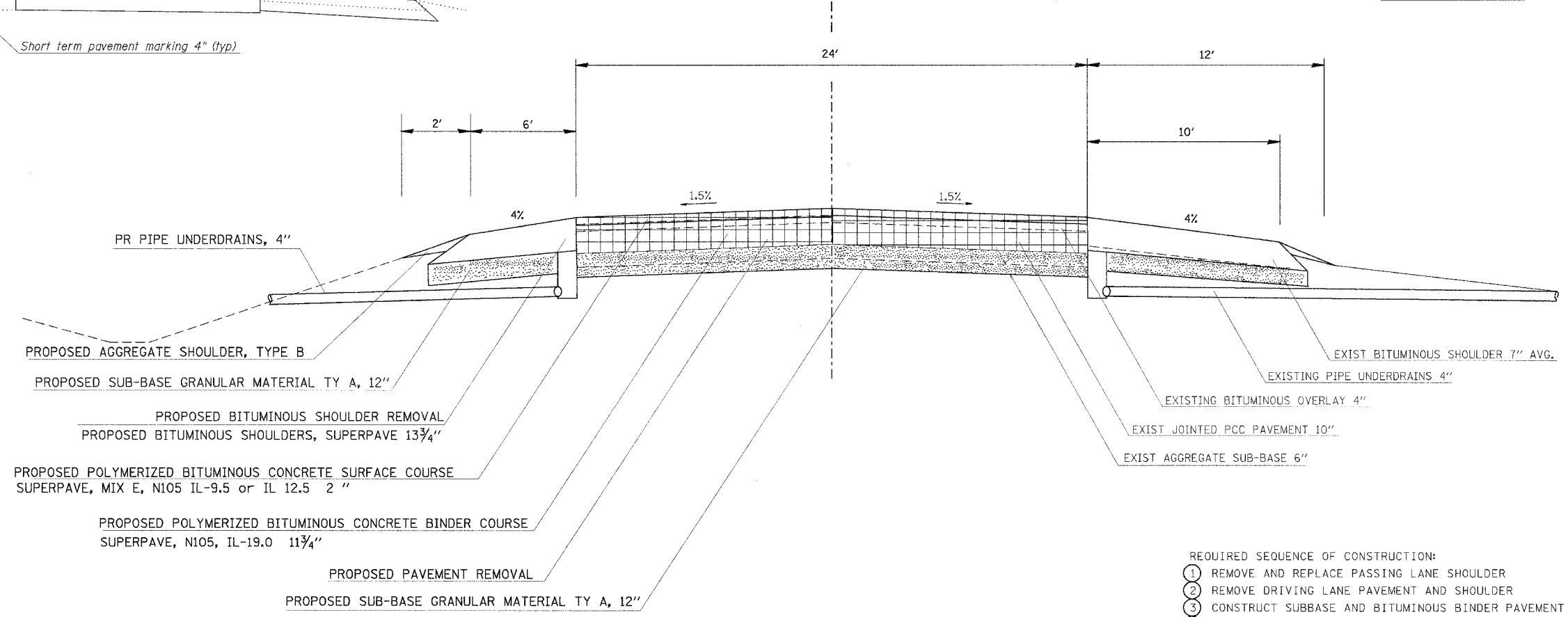
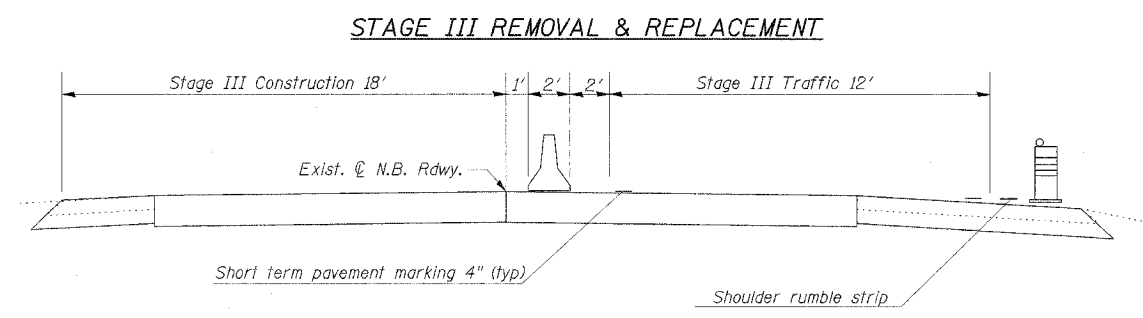
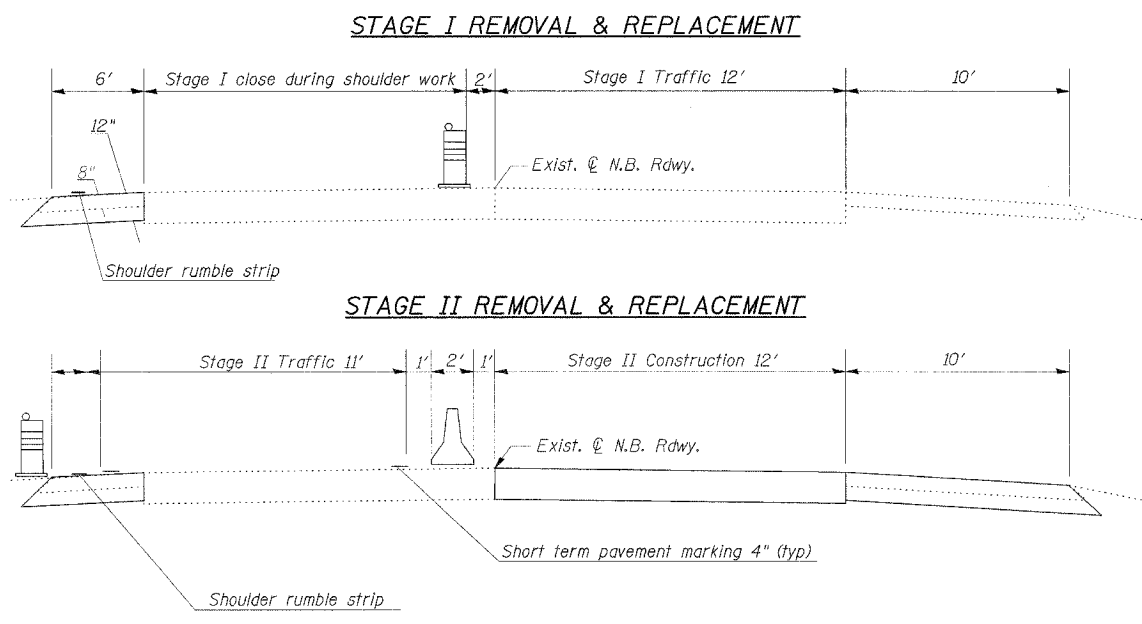

- REQUIRED SEQUENCE OF CONSTRUCTION:
- 1 REMOVE AND REPLACE PASSING LANE SHOULDER
 - 2 REMOVE DRIVING LANE PAVEMENT AND SHOULDER
 - 3 CONSTRUCT SUBBASE AND BITUMINOUS BINDER PAVEMENT DRIVING LANE
 - 4 TRENCH & PLACE DRIVING LANE UNDERDRAINS
 - 5 CONSTRUCT OUTSIDE BITUMINOUS SHOULDER
 - 6 REMOVE PASSING LANE PAVEMENT AND SHOULDER
 - 7 CONSTRUCT SUBBASE AND BITUMINOUS BINDER PAVEMENT PASSING LANE
 - 8 TRENCH & PLACE PASSING LANE UNDERDRAINS
 - 9 CONSTRUCT INSIDE BITUMINOUS SHOULDER

- NOTES:
1. ANY SUBGRADE EXCAVATION OR EARTHWORK NEEDED TO CONSTRUCT THE SUB-BASE GRANULAR MATERIAL OR SHOULDERS WILL NOT BE PAID FOR SEPARATELY, BUT WILL BE INCLUDED IN THE COST OF THE SUBBASE.
 2. THE EXCAVATED MATERIAL FROM THE PIPE UNDERDRAIN 4" TRENCH WILL NOT BE ALLOWED ON THE FORESLOPES OR WITHIN THE PROJECT'S RIGHT-OF-WAY.
 3. THE TRENCH SHALL BE CLEARED OF ALL EXISTING PIPE AND FABRIC TO THE SATISFACTION OF THE ENGINEER PRIOR TO THE PLACEMENT OF THE PROPOSED PIPE UNDERDRAINS 4". REMOVAL OF THE EXISTING PIPE UNDERDRAIN SYSTEM IS INCLUDED IN THE COST OF THE PROPOSED PIPE UNDERDRAIN 4".
 4. THE STAGE CONSTRUCTION OF THIS SECTION WILL UTILIZE TEMPORARY CONCRETE BARRIER WALL TO PROTECT TRAFFIC FROM THE OPEN TRENCH.

TO BE USED:

LAKE CREEK BRANCH BRIDGE (100-0010)

NB LANES ONLY: STA 226+30 TO STA 228+16.5 & STA 229+15 TO STA 231+50

LEGEND

	AGGREGATE SUB-BASE
	PAVEMENT REMOVAL - (SAW CUTS INCIDENTAL)

PLOT DATE = 4/11/2006
 FILE NAME = c:\puro\sect\1926205\1926205.dwg
 PLOT SCALE = 5,000.00 / IN.
 USER NAME = miller19