

F.A.P. RTE	SECTION	COUNTY	TOTAL SHEETS	SHEET NO.
322	1075	JACKSON	8	4
STA. 282+00		TO STA. 291+00		
FED. ROAD DIST. NO.		ILLINOIS	FED. AID PROJECT	

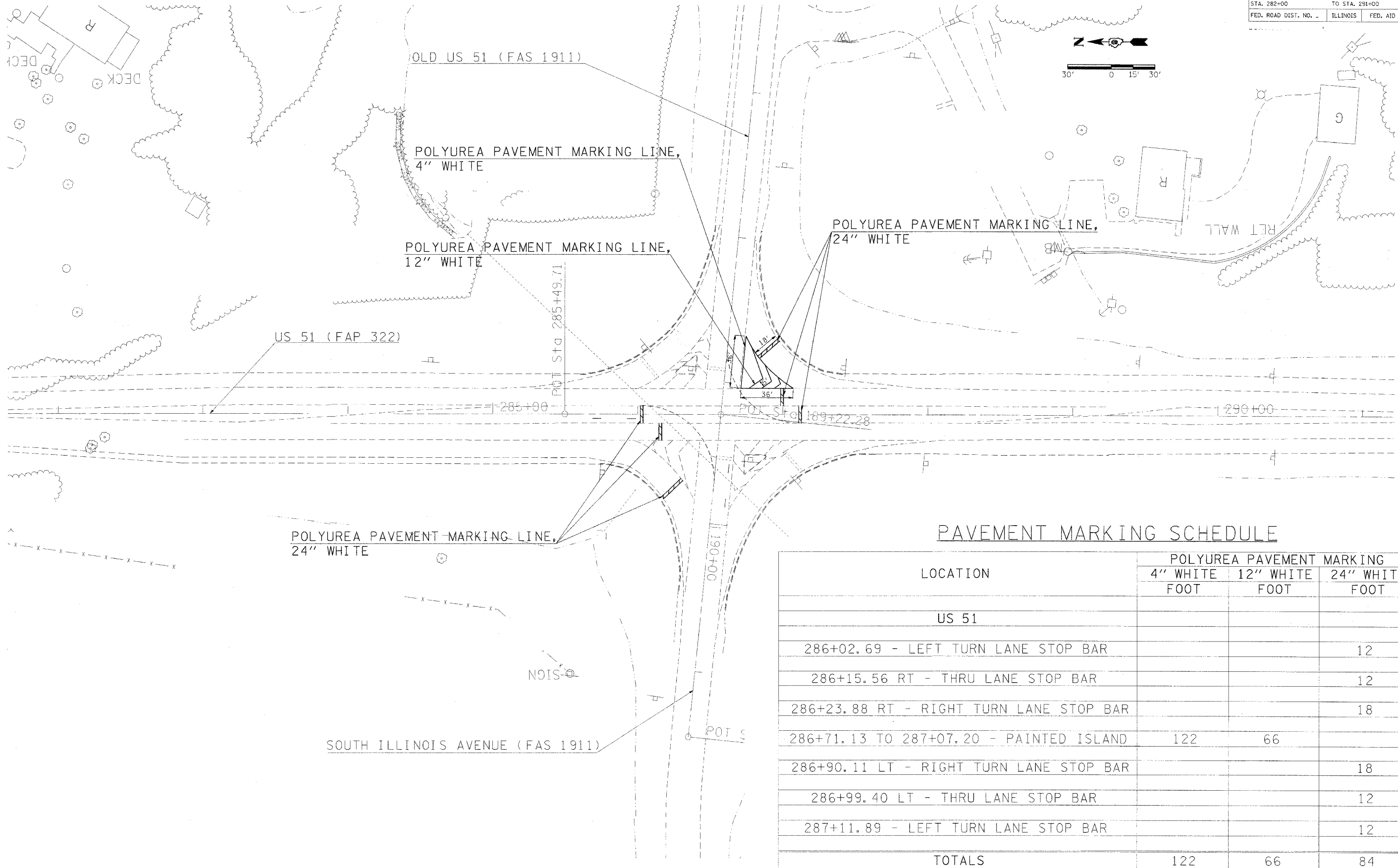
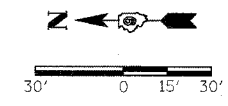

**PAVEMENT MARKING SCHEDULE**

LOCATION	POLYUREA PAVEMENT MARKING		
	4" WHITE FOOT	12" WHITE FOOT	24" WHITE FOOT
<b>US 51</b>			
286+02.69 - LEFT TURN LANE STOP BAR			12
286+15.56 RT - THRU LANE STOP BAR			12
286+23.88 RT - RIGHT TURN LANE STOP BAR			18
286+71.13 TO 287+07.20 - PAINTED ISLAND	122	66	
286+90.11 LT - RIGHT TURN LANE STOP BAR			18
286+99.40 LT - THRU LANE STOP BAR			12
287+11.89 - LEFT TURN LANE STOP BAR			12
<b>TOTALS</b>	<b>122</b>	<b>66</b>	<b>84</b>

**PAVEMENT MARKINGS**

3/31/2006  
 3:00:00 PM  
 3/31/2006 3:00:00 PM  
 3/31/2006 3:00:00 PM