

ROAD CLASSIFICATION: MAJOR COLLECTOR
 DESIGN SPEED: 50 M.P.H.

ADT:
 (2006) 950
 (2016) 1280
 PC = 885
 SU = 55
 MU = 10
 DHV₂₀ = 95

JOINT UTILITY LOCATING INFORMATION
 FOR EXCAVATIONS (J.U.L.I.E.)
 PHONE 1-800-892-0123

SHEET NO.	TITLE
1.	COVER SHEET
2.	SUMMARY OF QUANTITIES AND MISCELLANEOUS DETAILS
3.	TYPICAL SECTIONS AND MISCELLANEOUS DETAILS
4.-6.	PLAN

STANDARDS:

- 701006-02
- 701301-02
- 701306-01
- 701311-02
- 702001-06
- 780001-01
- B.L.R. 24-1

NOTE: STANDARDS ARE IN THE PROPOSAL

SUMMARY OF QUANTITIES			1000
CODE No.	PAY ITEM	UNIT	TOTAL
40200800	AGGREGATE SURFACE COURSE, TYPE B	TON	115
40600100	BITUMINOUS MATERIALS (PRIME COAT)	GALLON	52
40600980	BITUMINOUS SURFACE REMOVAL - BUTT JOINT	SQ YD	388
44000030	BITUMINOUS SURFACE REMOVAL, (VARIABLE DEPTH)	SQ YD	3,770
48100100	AGGREGATE SHOULDERS, TYPE A	TON	1,600
67100100	MOBILIZATION	LUMP SUM	1
70300100	SHORT-TERM PAVEMENT MARKING	FOOT	1,820
78001100	PAINT PAVEMENT MARKING-LETTERS AND SYMBOLS	SQ FT	184
78001110	PAINT PAVEMENT MARKING-LINE 4"	FOOT	72,156
X4066416	BITUMINOUS CONCRETE SURFACE COURSE SUPERPAVE, MIX C, N70	TON	* 3,900
X4066616	BITUMINOUS CONCRETE BINDER COURSE SUPERPAVE, IL-19.0, N70	TON	* 5,350

* SEE SPECIAL PROVISIONS Δ SPECIALTY ITEMS

CONTRACT NO. : 99267

NET LENGTH OF IMPROVEMENT = 18,194 FEET (3.446 MILES)

STATE OF ILLINOIS

DEPARTMENT OF TRANSPORTATION

PLANS FOR PROPOSED ROADWAY IMPROVEMENTS

F.A.S. ROUTE 1877 and C.H.11

Franklin County, Illinois

MFT Section No. 04-00160-00-RS

Project HPP-2607(001)

JOB C-99-541-05

ROUTE	SECTION	COUNTY	TOTAL SHEETS	SHEET NO.
FAS 1877	04-00160-00-RS	FRANKLIN	6	1

CONTRACT No.: 99267

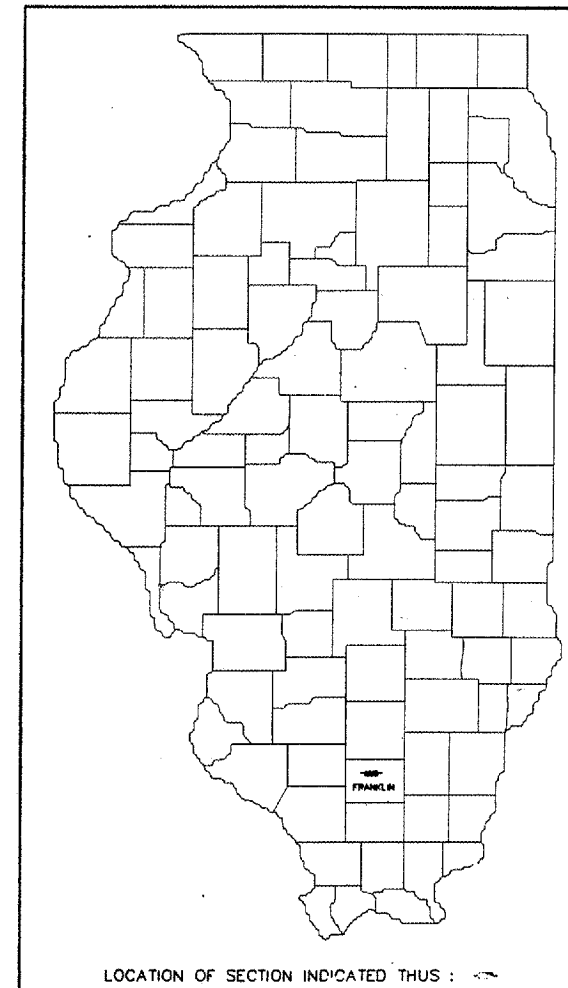
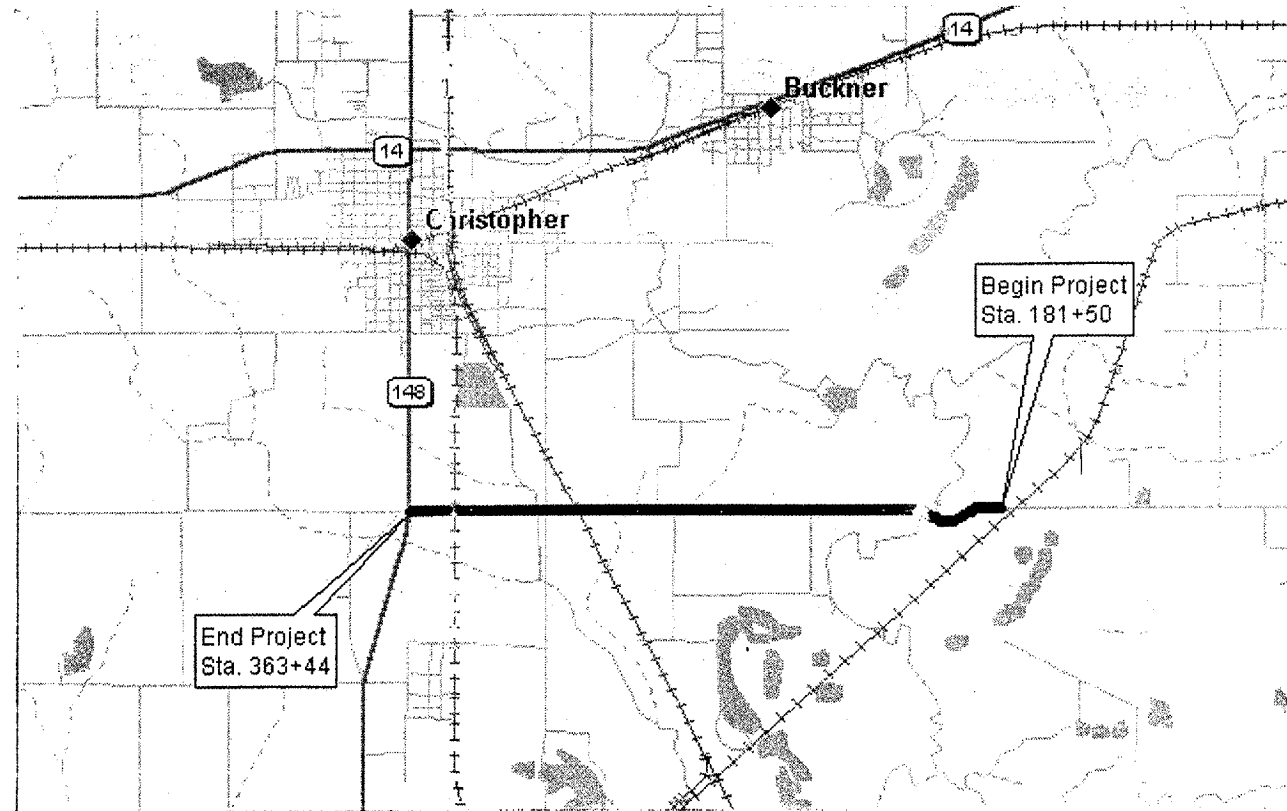

STATE OF ILLINOIS
 DEPARTMENT OF TRANSPORTATION

SUBMITTED: 4/10/06
Michael R. Roll
 LOCAL AGENCY REPRESENTATIVE

PASSED: 4/12/06
Dennis Hill
 ENGINEER OF LOCAL ROADS & STREETS

APPROVED: 4-13-06
Mary C. Lame
 MARY C. LAMIE, P.E.
 DEPUTY DIRECTOR OF HIGHWAYS
 REGION FIVE ENGINEER



L. Lippe
 LAWRENCE A. LIPE
 ILLINOIS REGISTERED PROFESSIONAL
 ENGINEER NO. 25978
 EXPIRATION DATE: 11/30/2007

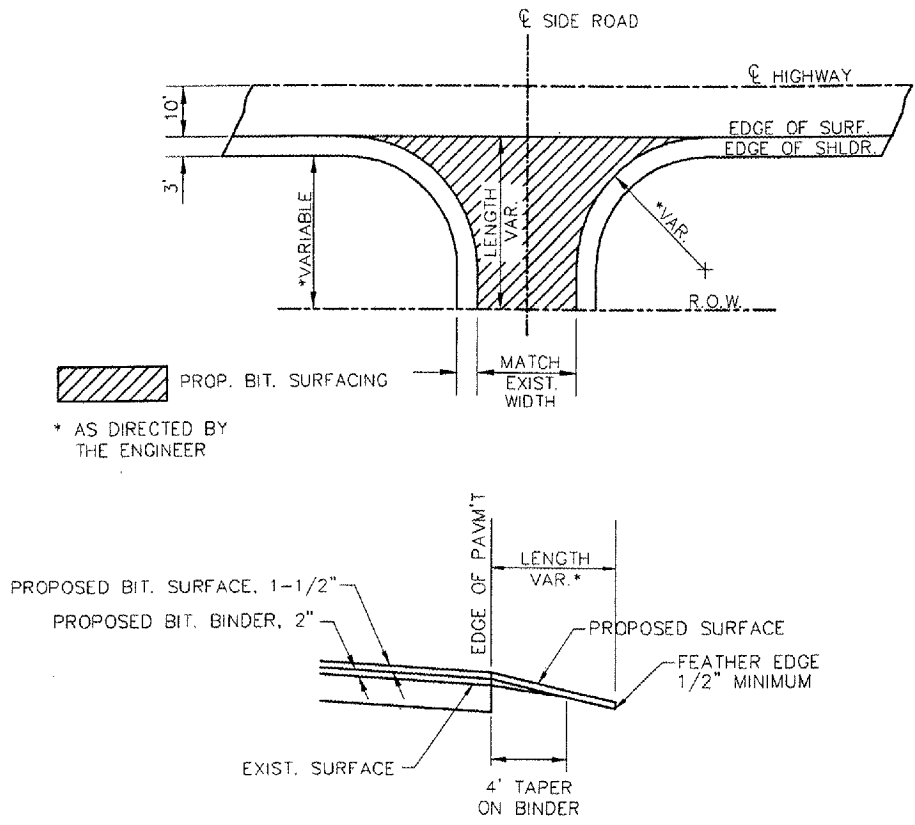

SIDEROAD DETAILS

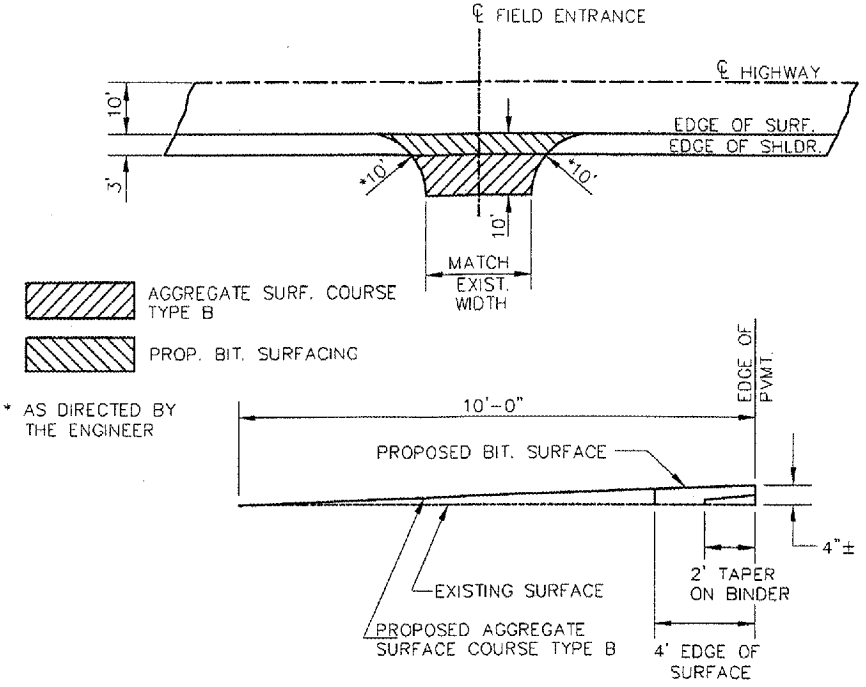

FIELD ENTRANCE DETAILS

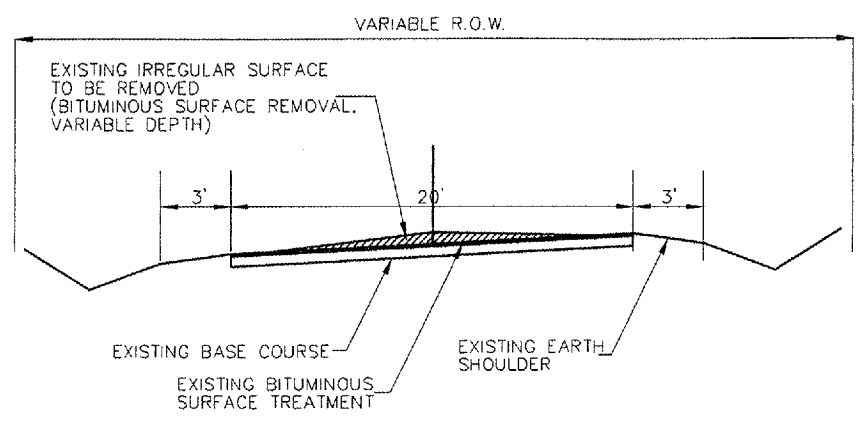

TYPICAL EXISTING SUPERELEVATED SECTION

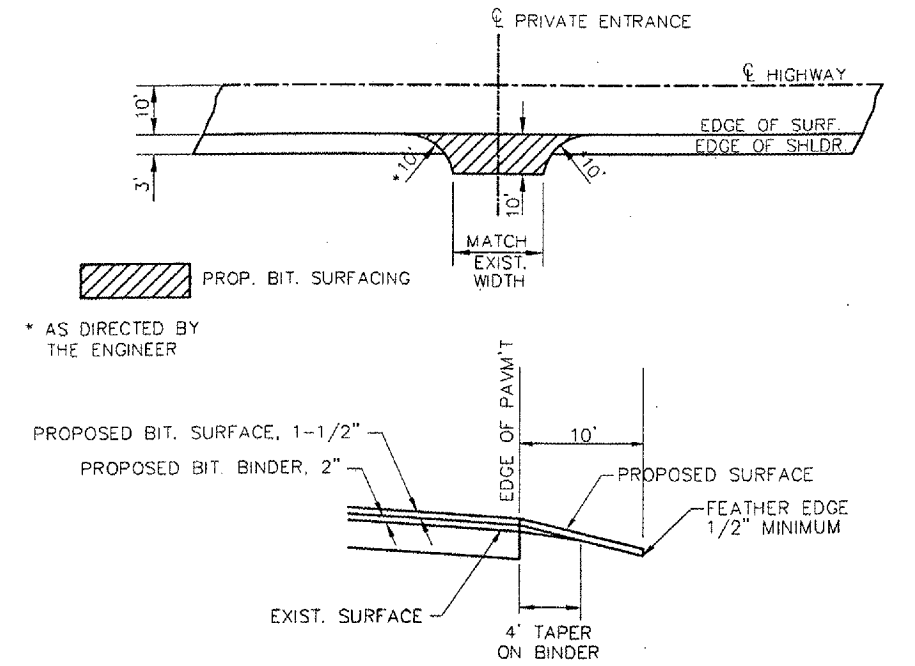

PRIVATE ENTRANCE DETAILS

ENTRANCES	AGGREGATE SURFACE COURSE TYPE B, TON	BIT. CONC. SURF. COURSE, SUPERPAVE MIX C, N70 TON
ONE (1) ENTRANCE	5	1
TOTAL = 23 ENTRANCES	115	23

LOCATION	BIT. CONC. SURF. COURSE, SUPERPAVE MIX C, N70 TON
LT. STA. 244+40.53	7
LT. STA. 284+36.15	9
RT. STA. 290+00	7
LT. STA. 323+28	11
RT. STA. 323+57.87	13
TOTALS	47 TON

TURNOUT	BITUMINOUS MATERIALS PRIME (COAT) GALLON	BIT. CONC. SURF. COURSE, SUPERPAVE MIX C, N70 TON
ONE (1) ENTRANCE	1	2
TOTAL = 7 TURNOUTS	7	14

ENTRANCES	BITUMINOUS MATERIALS PRIME (COAT) GALLON	BIT. CONC. SURF. COURSE, SUPERPAVE MIX C, N70 TON
ONE (1) ENTRANCE	5	4
TOTAL = 9 ENTRANCES	45	36

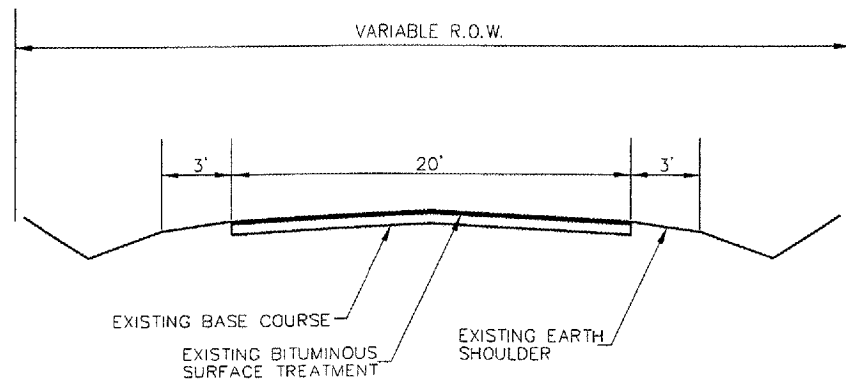

TYPICAL EXISTING SECTION

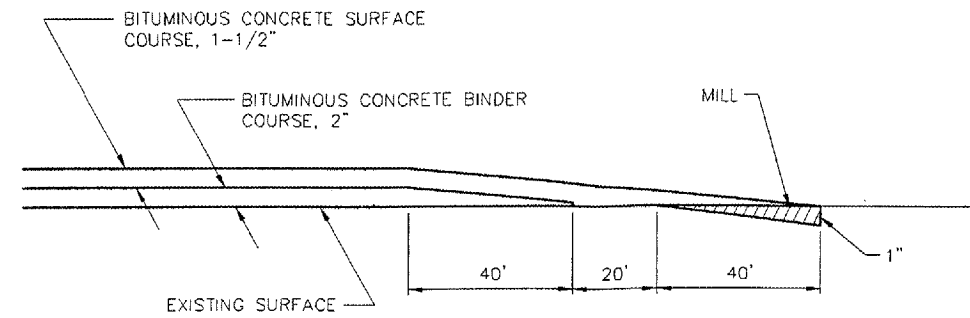

TYPICAL BUTT JOINT

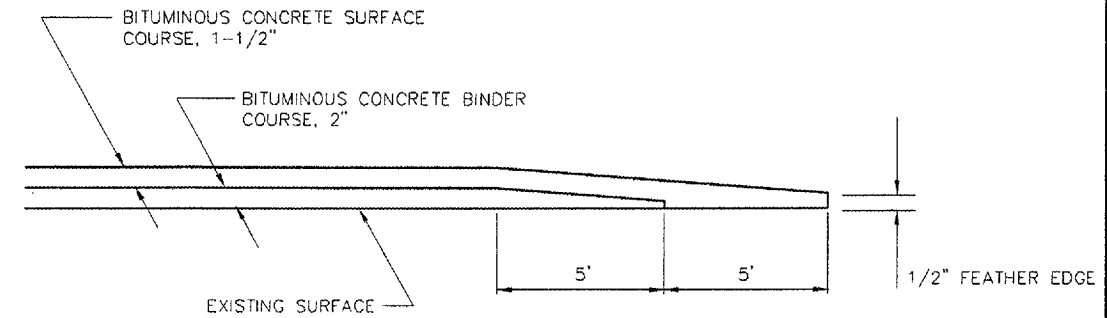

TYPICAL FEATHER JOINT

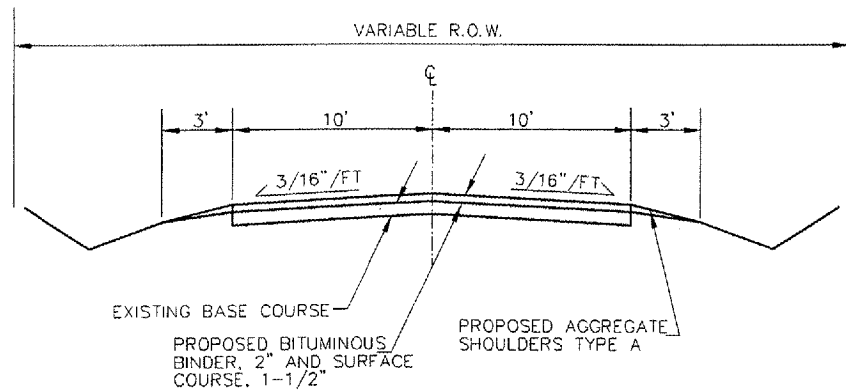

TYPICAL PROPOSED SECTION

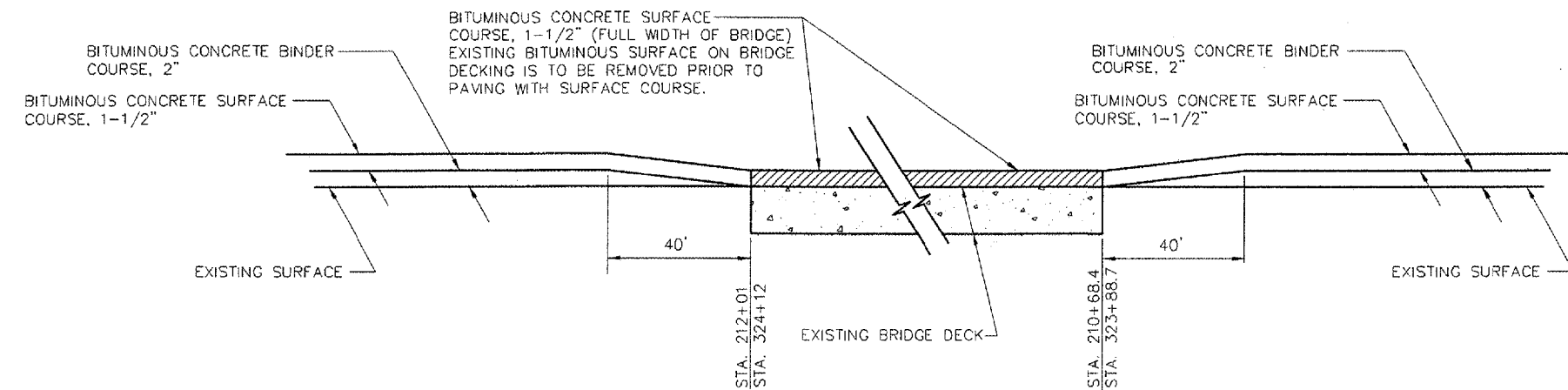

SURFACING AT BRIDGES

SCHEDULE OF PAVEMENT MARKING LINE, 4"

WESTBOUND LANE			EASTBOUND LANE				
STATION	NO PASSING (YELLOW SOLID)	CENTERLINE (YELLOW DASHED)	STATION	NO PASSING (YELLOW SOLID)	CENTERLINE (YELLOW DASHED)	STATION	EDGE LINE (WHITE SOLID)
STA. 181+50 - 187+00	-	550 FT.	STA. 181+50 - 187+00	550 FT.	-	STA. 181+50 - 187+00	1,100 FT.
STA. 187+00 - 193+00	600 FT.	-	STA. 187+00 - 190+00	-	300 FT.	STA. 187+00 - 193+00	1,200 FT.
STA. 193+00 - 198+00	-	500 FT.	STA. 190+00 - 194+00	400 FT.	-	STA. 193+00 - 198+00	1,000 FT.
STA. 198+00 - 216+00	1,800 FT.	-	STA. 194+00 - 199+00	-	500 FT.	STA. 198+00 - 216+00	3,600 FT.
STA. 216+00 - 230+50	-	1,450 FT.	STA. 199+00 - 221+00	2,200 FT.	-	STA. 216+00 - 230+50	2,900 FT.
STA. 230+50 - 239+00	850 FT.	-	STA. 221+00 - 272+00	-	5,100 FT.	STA. 230+50 - 239+00	1,700 FT.
STA. 239+00 - 266+00	-	2,700 FT.	STA. 272+00 - 281+00	900 FT.	-	STA. 239+00 - 266+00	5,400 FT.
STA. 266+00 - 271+00	500 FT.	-	STA. 281+00 - 314+00	-	3,300 FT.	STA. 266+00 - 271+00	1,000 FT.
STA. 271+00 - 282+00	-	1,100 FT.	STA. 314+00 - 321+00	700 FT.	-	STA. 271+00 - 282+00	2,200 FT.
STA. 282+00 - 287+00	500 FT.	-	STA. 321+00 - 359+00	-	3,800 FT.	STA. 282+00 - 287+00	1,000 FT.
STA. 287+00 - 309+00	-	2,200 FT.	STA. 359+00 - 363+44	444 FT.	-	STA. 287+00 - 309+00	4,400 FT.
STA. 309+00 - 315+50	650 FT.	-				STA. 309+00 - 315+50	1,300 FT.
STA. 315+50 - 326+00	-	1,050 FT.				STA. 315+50 - 326+00	2,100 FT.
STA. 326+00 - 332+00	600 FT.	-				STA. 326+00 - 332+00	1,200 FT.
STA. 332+00 - 363+44	-	3,144 FT.				STA. 332+00 - 363+44	6,288 FT.
TOTALS	5,500 FT.	12,694 FT.	TOTALS	5,194 FT.	13,000 FT.	TOTALS	35,768 FT.

PAINT PAVEMENT MARKING, LETTERS AND SYMBOLS

PAVEMENT MARKINGS AT RAILROAD HIGHWAY CROSSINGS SHALL BE LAID OUT IN ACCORDANCE WITH HIGHWAY STANDARD 780001-01 AT THE FOLLOWING LOCATIONS:

- WEST BOUND LANE: STA. 176+10
- EAST BOUND LANE: STA. 186+25
- WEST BOUND LANE: STA. 309+25
- EAST BOUND LANE: STA. 319+25

THE CENTER OF THE "X" FOR THE RAILROAD SYMBOL WILL BE LOCATED IN THE CENTER OF THE ABOVE INDICATED LANE AND STATION. THE COST OF PAINTING THE STOP LINES AS SHOWN ON HIGHWAY STANDARD 780001-01 SHALL BE INCLUDED BY THE CONTRACTOR IN THE PRICE FOR PAINT PAVEMENT MARKING, LETTERS AND SYMBOLS AND NO ADDITIONAL COMPENSATION WILL BE ALLOWED.

TYPICAL SECTIONS & MISCELLANEOUS DETAILS

ROUTE	SECTION	COUNTY	TOTAL SHEETS	SHEET NO.
FAS 1877	04-00160-00-RS	FRANKLIN	6	4
CONTRACT No.: 99267				

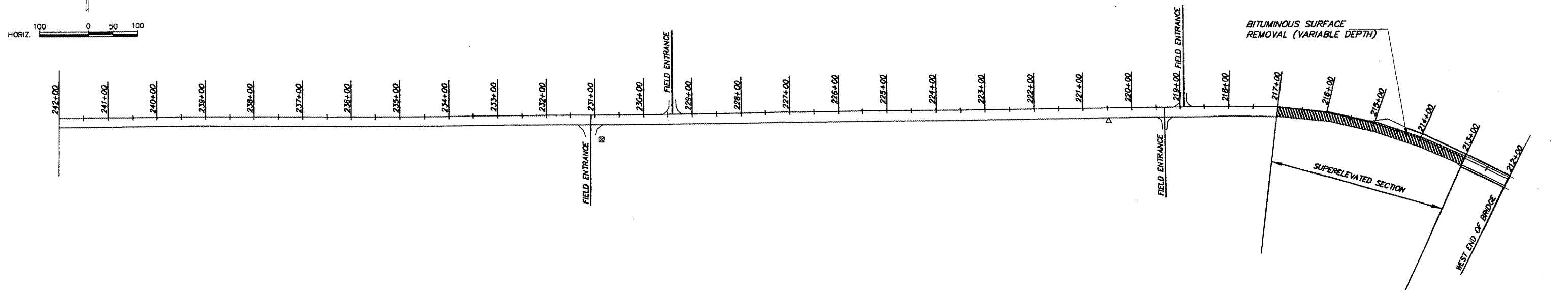
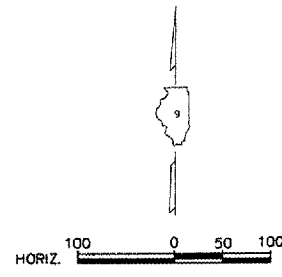
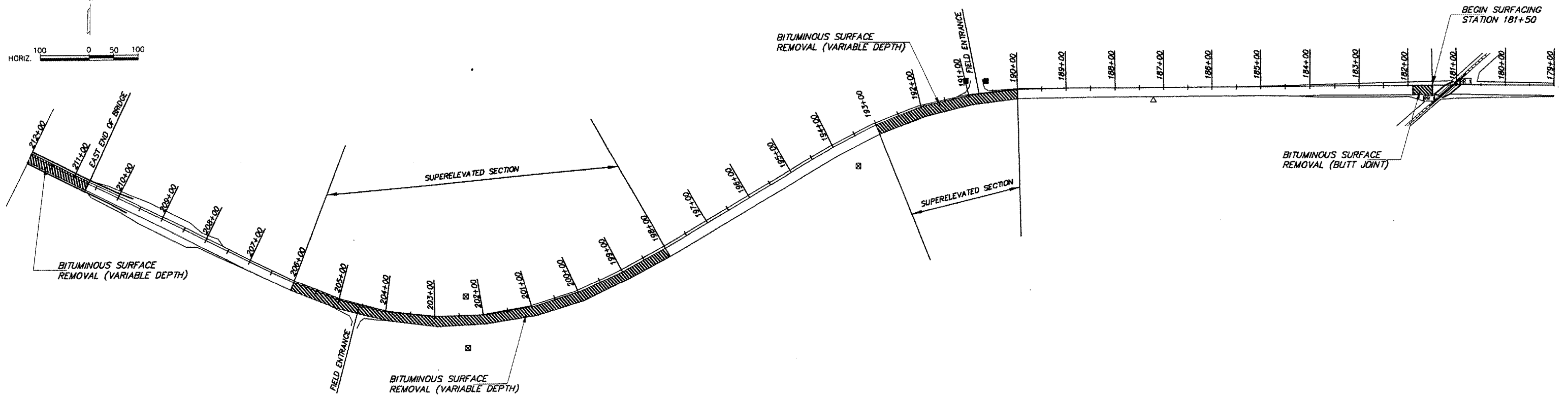
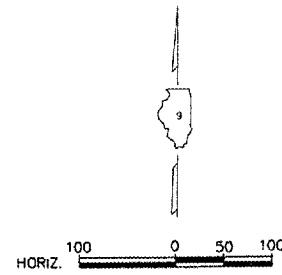

ROUTE	SECTION	COUNTY	TOTAL SHEETS	SHEET NO.
FAS 1877	04-00160-00-RS	FRANKLIN	6	5
CONTRACT No.: 99267				

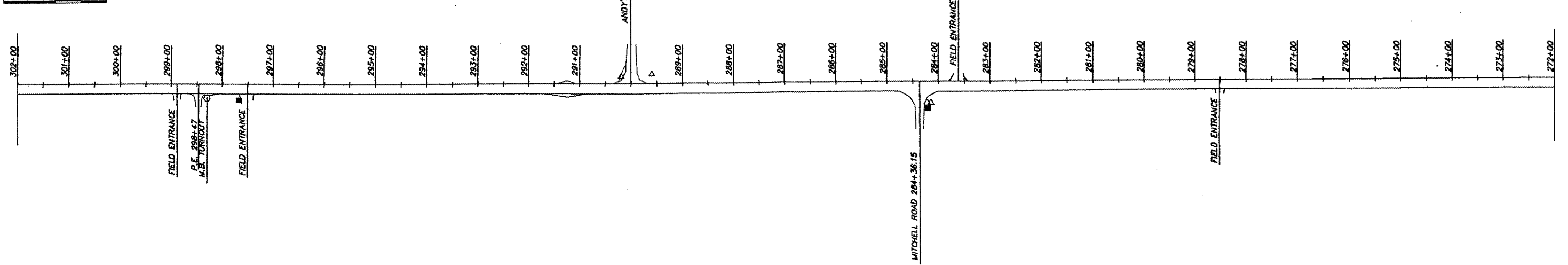
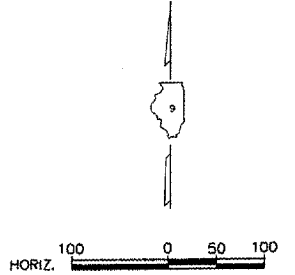
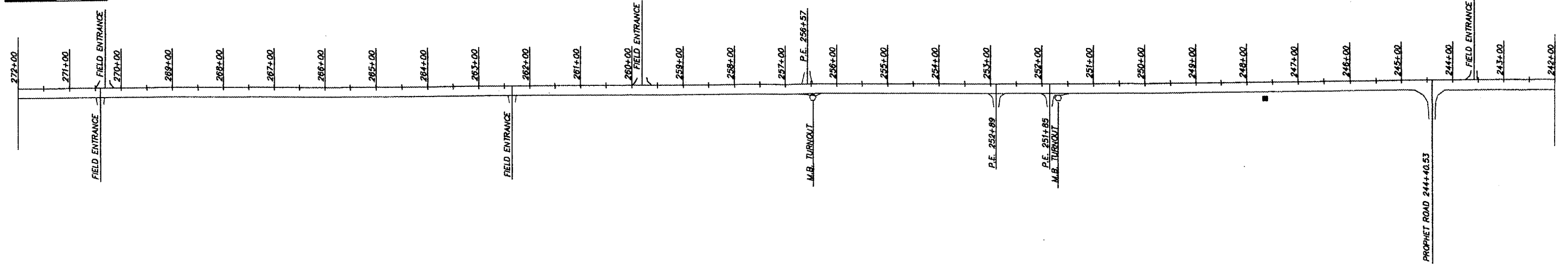
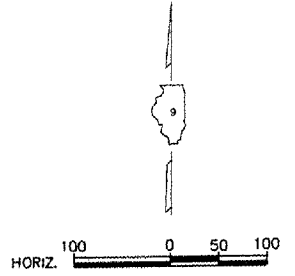

YELLOW BANKS ROAD FAS 1877

PLAN
STATION 242+00 TO 302+00

ROUTE	SECTION	COUNTY	TOTAL SHEETS	SHEET NO.
FAS 1877	04-00160-00-RS	FRANKLIN	6	6
CONTRACT No.: 99267				

